

AL'S SEPTIC PUMPING SERVICE, INC.  
P.O. BOX 6996  
LOS OSOS, CA 93412

805-528-0432 alssepticinc@gmail.com

# Invoice

Date	Invoice #
10/4/2024	39001

Bill To
Greg Belknap 645 Rosemary Court Arroyo Grande, CA. 93420

Job Address
Greg Belknap 680 Spring Canyon Lane Nipomo, CA. 93444

P.O. No.	Terms	Due Date	Maintenance	Leach Failure	Escrow	Other
PL8/19/2024	Due in 10 d...	10/14/2024			Pre-escrow	

Description	Qty	Rate	Amount
Service call to pump and inspect septic tank and system for escrow sale. Access lids exposed by owner.			
10/2/2024 Pumping and disposal of septic waste-transport to Santa Maria Treatment plant.		825.00	825.00
Inspection and report for escrow		210.00	210.00

<i>To be paid in full upon receipt. All invoices not paid within 30 days subject to finance charge 1.5%</i>	<b>Total</b>
	<b>Payments/Credits</b>
	<b>Balance Due</b>

AL'S SEPTIC PUMPING SERVICE, INC.  
P.O. BOX 6996  
LOS OSOS, CA 93412

805-528-0432 alssepticinc@gmail.com

# Invoice

Date	Invoice #
10/4/2024	39001

Bill To
Greg Belknap 645 Rosemary Court Arroyo Grande, CA. 93420

Job Address
Greg Belknap 680 Spring Canyon Lane Nipomo, CA. 93444

P.O. No.	Terms	Due Date	Maintenance	Leach Failure	Escrow	Other
PL8/19/2024	Due in 10 d...	10/14/2024			Pre-escrow	

Description	Qty	Rate	Amount
Please remit check payment. We do accept M/C or VISA payments but they will include an additional processing fee based on amount. Please include the invoice number or job address with your payment.			

<i>To be paid in full upon receipt. All invoices not paid within 30 days subject to finance charge 1.5%</i>	<b>Total</b>	\$1,035.00
	<b>Payments/Credits</b>	\$0.00
License # 883281	<b>Balance Due</b>	\$1,035.00

**Certification-Report of Inspection-Individual Sewage Disposal System**

Date: 10/2/2024 Escrow # N/A Owner/Seller Belknap  
Property Address: 680 Spring Canyon Lane Arroyo Grande, CA 93420  
Agent: N/A  
Realtor/Finance Company: \_\_\_\_\_ Title Company: N/A

**Septic Tank**

Type of Tank:  Concrete  Fiberglass  Plastic  Other \_\_\_\_\_  
Tank Capacity:  1000 gal.  1200 gal.  1500 gal.  Other \_\_\_\_\_  
Tank Components:  Access Lids  Baffle  San-Tees  Pump Station  Diversion Valve  Filter  
Tank deterioration noted:  None  Minor  Moderate  Major/failed  
Tank was pumped completely on day of inspection.  Yes  No Depth to access lids within 12 inches of surface:  Yes  No  
Notes: Tank and components all in operable condition on day of inspection.  
Owner had tank lids exposed for inspection and service. 2.5' depth  
No residence at this time on site for system.

**Leach System**

Operating at proper level and shows no signs of failure or surfacing at time of inspection.  
 Operating at **above** normal operating level. Will require upgrade or replacement to maintain sanitary conditions.  
Notes: System passed flow test criteria on day of inspection..  
\*Vacancy disclosure on page 2

**Conclusions**

The system was functioning properly on day of inspection.  
 The entire system is **NOT** functioning properly at this time and will require upgrade in order to maintain sanitary conditions.  
Problem area  Tank  Leach Field (see details above)  
Notes: \_\_\_\_\_

**Recommendations**

The tank should be checked and pumped every 2-3 years to ensure proper operation.  
 Systems equipped with a pump station, filter or diversion valve should be checked annually.  
Notes: Under normal use, keep up on routine maintenances as recommended. This  
to help ensure proper operation of and check of system. Install access risers  
closer to grade.

**\*NOTICE TO BUYER/OWNER:** This inspection is an expert disclosure of the condition of this waste disposal system. It is **not a guarantee** of continued performance, or condition, past inspection date. Leach systems are not designed to last indefinitely. Failures can occur at any time without notice. Trees/root systems can cause premature leach failure if located near leach system. The sewer pipe from the building to the tank is not included in this inspection. Gray water diversions of any kind are not part of this report or inspection.

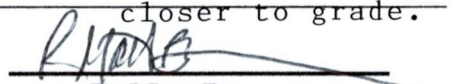
  
**R. Matt Beavers**  
Owner/Operator  
Bus. Lic #0603464  
Contractor. Lic # 883281

Job address: 680 Spring Canyon Lane Arroyo Grande, CA 93420

**\*Notes: \*VACANCY DISCLOSURE:** when occupancy or regular use has been limited or unknown history of limited or regular water use entering system line or leach system, i.e., if house has been vacant for an extended time no prediction can be made as to when or if a system might fail. Leach system are subterranean, and could be the original system of residence without knowledge if any prior repairs or upgrades have been made or disclosed by a owner or seller. System did pass flow test on day of inspection only, and is in no way intended to be a warranty or guarantee past inspection date.

## System Location & Site Sketch

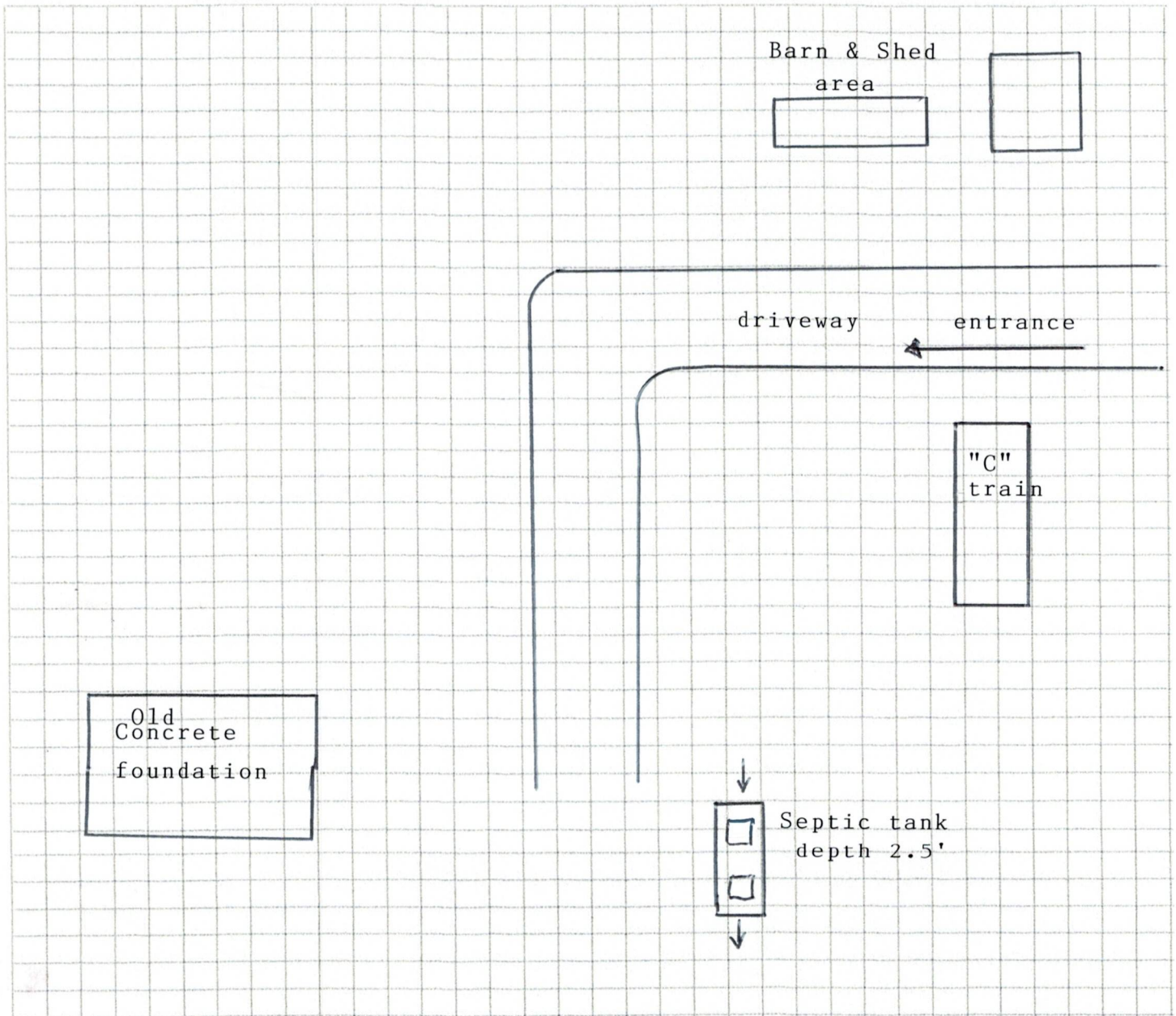

Locations of the septic tank and leach field above are approximate only. The exact location or dimensioning is not within the scope of this inspection. Drawing is not to scale.