

Preliminary Report

File No.: FSBA-4201260313-MF
Escrow No.: FSBA-4201260313-JTH
Property Address: 450, 508 and 516 Hill Street, Oxnard,
CA

Title Officer: Michelle Fisher
Escrow Officer: Jacinta Hoang

Welcome to the new titleLOOK®!

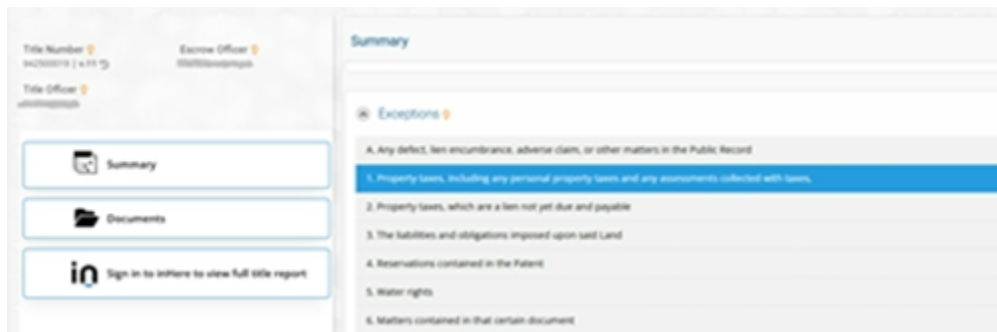

titleLOOK upgrades the traditional title report experience from a static report with large zip files of supporting documents to a real-time interactive title report. With titleLOOK, you'll enjoy:

- an easy-to-use summary page of your report findings
- color-coded requirements and exceptions so you can focus on what is important
- hyperlinks directly into the documents referenced on your report
- a transparent and convenient title report experience

[Click to view custom titleLOOK®](#)

The logo for inHere, featuring the word 'inHere' in a bold, sans-serif font. The 'i' is lowercase and blue, while 'nHere' is uppercase and black. A small registered trademark symbol (®) is located to the upper right of the 'e'.

When you click on the above button/link to access your titleLOOK report, you will be taken to inHere, our platform designed to transform the experience of buying or selling real estate from the moment a transaction is started all the way through closing. inHere provides a safe and convenient method of delivering documents and information about your real estate transaction.

PRELIMINARY REPORT

*In response to the application for a policy of title insurance referenced herein, **Fidelity National Title Company** hereby reports that it is prepared to issue, or cause to be issued, as of the date hereof, a policy or policies of title insurance describing the land and the estate or interest therein hereinafter set forth, insuring against loss which may be sustained by reason of any defect, lien or encumbrance not shown or referred to as an exception herein or not excluded from coverage pursuant to the printed Schedules, Conditions and Stipulations or Conditions of said policy forms.*

The printed Exceptions and Exclusions from the coverage and Limitations on Covered Risks of said policy or policies are set forth in Attachment One. The policy to be issued may contain an arbitration clause. When the Amount of Insurance is less than that set forth in the arbitration clause, all arbitrable matters shall be arbitrated at the option of either the Company or the Insured as the exclusive remedy of the parties. Limitations on Covered Risks applicable to the CLTA and ALTA Homeowner's Policies of Title Insurance which establish a Deductible Amount and a Maximum Dollar Limit of Liability for certain coverages are also set forth in Attachment One. Copies of the policy forms should be read. They are available from the office which issued this report.

This report (and any supplements or amendments hereto) is issued solely for the purpose of facilitating the issuance of a policy of title insurance and no liability is assumed hereby. If it is desired that liability be assumed prior to the issuance of a policy of title insurance, a Binder or Commitment should be requested.

The policy(ies) of title insurance to be issued hereunder will be policy(ies) of Fidelity National Title Insurance Company, a Florida corporation.

Please read the exceptions shown or referred to herein and the exceptions and exclusions set forth in Attachment One of this report carefully. The exceptions and exclusions are meant to provide you with notice of matters which are not covered under the terms of the title insurance policy and should be carefully considered.

It is important to note that this preliminary report is not a written representation as to the condition of title and may not list all liens, defects and encumbrances affecting title to the land.

Fidelity National Title Insurance Company

By:



Michael J. Nolan, President

Attest:



Marjorie Nemzura, Secretary

Countersigned By:



Ron Lloyd
Authorized Officer or Agent



Visit Us on our Website: www.fntic.com

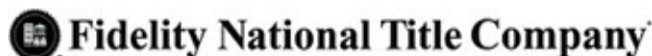

ISSUING OFFICE: 3700 State Street, Suite 100, Santa Barbara, CA 93105

FOR SETTLEMENT INQUIRIES, CONTACT:

Fidelity National Title Company
3700 State Street, Suite 100 • Santa Barbara, CA 93105
(805)879-9400 • FAX (805)879-9450

**Another Prompt Delivery From Fidelity National Title Company Title Department
Where Local Experience And Expertise Make A Difference**

PRELIMINARY REPORT

Title Officer: Michelle Fisher
Email: Michelle.Fisher2@fnf.com
Title No.: FSBA-4201260313-MF

Escrow Officer: Jacinta Hoang
Email: Jacinta.Hoang@fnf.com
Escrow No.: FSBA-4201260313 -JTH

TO: Radius Group Commercial Real Estate
226 E. De La Guerra Street
Santa Barbara, CA 93101
Attn: Golis Team

PROPERTY ADDRESS(ES): 450, 508 and 516 Hill Street, Oxnard, CA

EFFECTIVE DATE: May 7, 2026 at 07:30 AM

The form of policy or policies of title insurance contemplated by this report is:

CLTA Standard Coverage Owner's Policy - 2022

ALTA Loan Policy 2021 Extended

1. THE ESTATE OR INTEREST IN THE LAND HEREINAFTER DESCRIBED OR REFERRED TO COVERED BY THIS REPORT IS:

A Fee

2. TITLE TO SAID ESTATE OR INTEREST AT THE DATE HEREOF IS VESTED IN:

JOHN J. HAGGERTY, Trustee of The John Haggerty Survivor's Trust dated July 14, 2010, as to an undivided 50% interest; and JOHN J. HAGGERTY, Trustee of The Haggerty Tax Exclusion Trust dated July 14, 2010, as to an undivided 50% interest; as tenants in common

3. THE LAND REFERRED TO IN THIS REPORT IS DESCRIBED AS FOLLOWS:

SEE EXHIBIT "A" ATTACHED HERETO AND MADE A PART HEREOF

EXHIBIT "A"
Legal Description

For APN/Parcel ID(s): [203-0-112-480](#) and [203-0-112-490](#)

THE LAND REFERRED TO HEREIN BELOW IS SITUATED IN THE CITY OF OXNARD, COUNTY OF VENTURA, STATE OF CALIFORNIA AND IS DESCRIBED AS FOLLOWS:

PARCEL ONE (APN 203-0-112-480):

THAT PORTION OF SUBDIVISION 30, RANCHO EL RIO DE SANTA CLARA O LA COLONIA, IN THE CITY OF OXNARD, COUNTY OF VENTURA, STATE OF CALIFORNIA, ACCORDING TO THAT CERTAIN PARTITION MAP FILED IN THE OFFICE OF THE COUNTY CLERK OF SAID COUNTY, IN THAT CERTAIN ACTION ENTITLED THOMAS A. SCOTT, ET AL., PLAINTIFFS, VS. RAFAEL GONZALES, ET AL., DEFENDANTS DESCRIBED AS FOLLOWS:

BEGINNING AT A 4 X 4 REDWOOD STAKE SET IN THE SOUTHERLY LINE OF THAT CERTAIN 60-FOOT STRIP OF LAND LOCALLY KNOWN AS AND CALLED HILL STREET, AS DESCRIBED IN THE DEED TO VENTURA COUNTY RECORDED JANUARY 17, 1912 IN [BOOK 128, PAGE 283](#) OF DEEDS, DISTANT ALONG SAID SOUTHERLY LINE NORTH 89°51' WEST 392.70 FEET FROM THE INTERSECTION OF SAID SOUTHERLY LINE WITH THE SOUTHERLY PROLONGATION OF THE WESTERLY LIE OF C STREET, AS SAID STREET IS SHOWN ON THE MAP OF WOLFF HILL LAUBACHER ADDITION [RECORDED IN BOOK 5, PAGE 16](#) 1/2 OF MAPS, AT THE NORTHWESTERLY CORNER OF THE LAND DESCRIBED IN THE DEED TO JOSIE MAPLE RECORDED MAY 28, 1914 IN [BOOK 135, PAGE 149](#) OF DEEDS; THENCE CONTINUING ALONG SAID SOUTHERLY LINE,

1ST: NORTH 89°51' WEST 97.27 FEET; THENCE,

2ND: SOUTH 295.80 FEET; THENCE,

3RD: SOUTH 89°51' EAST, 97.27 FEET TO THE SOUTHWESTERLY CORNER OF SAID LAND OF JOSIE MAPLE; THENCE ALONG THE WESTERLY LINE OF SAID LAST MENTIONED LAND,

4TH: NORTH 295.80 FEET TO THE POINT OF BEGINNING.

PARCEL TWO (APN 203-0-112-490):

PART OF SUBDIVISION 30, RANCHO EL RIO DE SANTA CLARA O LA COLONIA, IN THE CITY OF OXNARD, COUNTY OF VENTURA, STATE OF CALIFORNIA, AS PER PARTITION MAP FILED IN THE OFFICE OF THE COUNTY CLERK OF SAID COUNTY, IN THAT CERTAIN ACTION ENTITLED THOMAS A. SCOTT, ET AL.,

EXHIBIT "A"
Legal Description
(continued)

PLAINTIFFS, VS. RAFAEL GONZALES, ET AL., DEFENDANTS DESCRIBED AS FOLLOWS:

BEGINNING AT A 4 X 4 REDWOOD STAKE SET IN THE SOUTHERLY LINE OF THAT CERTAIN STRIP OR PARCEL OF LAND, 60 FEET WIDE, AS CONVEYED TO VENTURA COUNTY BY DEED RECORDED JANUARY 17, 1912 IN [BOOK 128, PAGE 283](#) OF DEEDS, IN THE OFFICE OF THE COUNTY RECORDER OF SAID COUNTY, KNOWN AS HILL STREET, FROM SAID POINT OF INTERSECTION OF THE SOUTH LINE OF HILL STREET AND THE PROLONGATION SOUTH OF THE WEST LINE OF C STREET, AS THE SAME ARE SHOWN UPON MAP OF WOLFF HILL LAUBACHER ADDITION TO THE CITY OF OXNARD, RECORDED IN [BOOK 5, PAGE 16](#) 1/2 OF MAPS, IN THE OFFICE OF THE COUNTY RECORDER OF SAID COUNTY, BEARING SOUTH 89°51' EAST, 194.52 FEET DISTANT; THENCE FROM SAID POINT OF BEGINNING,

1ST: SOUTH 295.80 FEET TO A 4 X 4 POST; THENCE,

2ND: NORTH 89°51' WEST 98.18 FEET TO A 2 X 4 POST, THENCE,

3RD: NORTH 295.80 FEET TO A 4 X 4 REDWOOD POST SET IN THE SOUTH LINE OF SAID HILL STREET; THENCE,

4TH: SOUTH 89°51' EAST 98.12 FEET TO THE POINT OF BEGINNING.

AT THE DATE HEREOF, EXCEPTIONS TO COVERAGE IN ADDITION TO THE PRINTED EXCEPTIONS AND EXCLUSIONS IN SAID POLICY FORM WOULD BE AS FOLLOWS:

1. Property taxes, which are a lien not yet due and payable, including any assessments collected with taxes to be levied for the fiscal year 2026-2027.
2. Prior to close of escrow, please contact the Tax Collector's Office to confirm all amounts owing, including current fiscal year taxes, supplemental taxes, escaped assessments and any delinquencies.
3. The lien of supplemental or escaped assessments of property taxes, if any, made pursuant to the provisions of Chapter 3.5 (commencing with Section 75) or Part 2, Chapter 3, Articles 3 and 4, respectively, of the Revenue and Taxation Code of the State of California as a result of the transfer of title to the vestee named in Schedule A or as a result of changes in ownership or new construction occurring prior to Date of Policy.
4. Any liens or other assessments, bonds, or special district liens including without limitation, Community Facility Districts, that arise by reason of any local, City, Municipal or County Project or Special District.
5. Water rights, claims or title to water, whether or not disclosed by the public records.
6. Easement(s) for the purpose(s) shown below and rights incidental thereto as set forth in a document:

In favor of: The City of Oxnard
Purpose: Street, alley, and municipal utility
Recording Date: June 12, 1964
Recording No: [Book 2560, Page 120](#) of Official Records
Affects: A portion of said land as more particularly described in said document

Affects Parcel One

7. Discrepancies, conflicts in boundary lines, shortage in area, encroachments, or any other matters shown on map in [Book 29, Page 85](#) of Records of Survey.

Affects Parcel One

8. Easement(s) for the purpose(s) shown below and rights incidental thereto as set forth in a document:

In favor of: Southern California Edison Company
Purpose: Pole lines and/or conduits
Recording Date: June 15, 1962
Recording No: [Book 2163, Page 500](#) of Official Records
Affects: A portion of said land as more particularly described in said document

Affects Parcel Two

9. Discrepancies, conflicts in boundary lines, shortage in area, encroachments, or any other matters shown on map in [Book 21, Page 61](#) of Records of Survey.

Affects Parcel Two

EXCEPTIONS

(continued)

10. DEED OF TRUST given to secure the original amount shown below, and any other amount payable under the terms thereof.

Amount: \$5,000,000.00
 Dated: February 10, 2022
 Trustor/Grantor JOHN J. HAGGERTY, Trustee of The John Haggerty Survivors Trust dated July 14, 2010; JOHN J. HAGGERTY, Trustee of The Haggerty Tax Exclusion Trust dated July 14, 2010
 Trustee: JPMorgan Chase Bank, N.A.
 Beneficiary: JPMorgan Chase Bank, N.A.
 Loan No.: 200532488
 Recording Date: February 16, 2022
Recording No: [2022000019827](#) Official Records

11. Any invalidity or defect in the title of the vestees in the event that the trust referred to herein is invalid or fails to grant sufficient powers to the trustee(s) or in the event there is a lack of compliance with the terms and provisions of the trust instrument.

If title is to be insured in the trustee(s) of a trust, (or if their act is to be insured), this Company will require a Trust Certification pursuant to California Probate Code Section 18100.5.

The Company reserves the right to add additional items or make further requirements after review of the requested documentation.

12. Any rights of the parties in possession of a portion of, or all of, said Land, which rights are not disclosed by the public records.

The Company will require, for review, a full and complete copy of any unrecorded agreement, contract, license and/or lease, together with all supplements, assignments and amendments thereto, before issuing any policy of title insurance without excepting this item from coverage.

The Company reserves the right to except additional items and/or make additional requirements after reviewing said documents.

13. Matters which may be disclosed by an inspection and/or by a correct ALTA/NSPS Land Title Survey of said Land that is satisfactory to the Company, and/or by inquiry of the parties in possession thereof.

14. Any easements not disclosed by the public records as to matters affecting title to real property, whether or not said easements are visible and apparent.

15. The Company will require that an Owner's Affidavit be completed by the party(s) named below before the issuance of any policy of title insurance.

Party(ies): Vestee

The Company reserves the right to add additional items or make further requirements after review of the requested Affidavit.

END OF EXCEPTIONS

NOTES**Note 1.** * * *IMPORTANT RECORDING NOTE* * *

Please send all original documents for recording to the following office:

Fidelity National Title Group/Sacramento
11320 Trade Center Dr., Ste C
Rancho Cordova, CA 95742
titleonlyrancho@fnf.com

Note 2. Note: The name(s) of the proposed insured(s) furnished with this application for title insurance is/are:

No names were furnished with the application. Please provide the name(s) of the buyers as soon as possible.

Note 3. Note: Property taxes for the fiscal year shown below are PAID. For proration purposes the amounts were:

Tax Identification No.: [203-0-112-480](#)
Fiscal Year: 2025-2026
1st Installment: \$16,187.73
2nd Installment: \$16,187.73
Land: \$661,822.00
Improvements: \$1,923,442.00
Personal Property: \$14,000.00
Code Area: 03-001

Affects Parcel One

Note 4. Note: Property taxes for the fiscal year shown below are PAID. For proration purposes the amounts were:

Tax Identification No.: [203-0-112-490](#)
Fiscal Year: 2025-2026
1st Installment: \$2,937.36
2nd Installment: \$2,937.36
Land: \$61,178.00
Improvements: \$389,318.00

Affects Parcel Two

Note 5. Note: The Company is not aware of any matters which would cause it to decline to attach CLTA Endorsement Form 116 indicating that there is located on said Land commercial, known as 450, 508 and 516 Hill Street, Oxnard, CA, to an Extended Coverage Loan Policy.**Note 6.** Note: There are NO conveyances affecting said Land recorded within 24 months of the date of this report.

NOTES
(continued)

- Note 7.** Note: If a county recorder, title insurance company, escrow company, real estate broker, real estate agent or association provides a copy of a declaration, governing document or deed to any person, California law requires that the document provided shall include a statement regarding any unlawful restrictions. Said statement is to be in at least 14-point bold face type and may be stamped on the first page of any document provided or included as a cover page attached to the requested document. Should a party to this transaction request a copy of any document reported herein that fits this category, the statement is to be included in the manner described.
- Note 8.** Note: Any documents being executed in conjunction with this transaction must be signed in the presence of an authorized Company employee, an authorized employee of an agent, an authorized employee of the insured lender, or by using Bancserv or other approved third-party service. If the above requirement cannot be met, please call the Company at the number provided in this report.
- Note 9.** Notice: Please be aware that due to the conflict between federal and state laws concerning the cultivation, distribution, manufacture or sale of marijuana, the Company is not able to close or insure any transaction involving Land that is associated with these activities.
- Note 10.** Pursuant to Government Code Section 27388.1, as amended and effective as of 1-1-2018, a Documentary Transfer Tax (DTT) Affidavit may be required to be completed and submitted with each document when DTT is being paid or when an exemption is being claimed from paying the tax. If a governmental agency is a party to the document, the form will not be required. DTT Affidavits may be available at a Tax Assessor-County Clerk-Recorder.

END OF NOTES



Inquire before you wire!

WIRE FRAUD ALERT

This Notice is not intended to provide legal or professional advice.
If you have any questions, please consult with a lawyer.

All parties to a real estate transaction are targets for wire fraud and many have lost hundreds of thousands of dollars because they simply relied on the wire instructions received via email, without further verification. **If funds are to be wired in conjunction with this real estate transaction, we strongly recommend verbal verification of wire instructions through a known, trusted phone number prior to sending funds.**

In addition, the following non-exclusive self-protection strategies are recommended to minimize exposure to possible wire fraud.

- **NEVER RELY** on emails purporting to change wire instructions. Parties to a transaction rarely change wire instructions in the course of a transaction.
- **ALWAYS VERIFY** wire instructions, specifically the ABA routing number and account number, by calling the party who sent the instructions to you. **DO NOT** use the phone number provided in the email containing the instructions, use phone numbers you have called before or can otherwise verify. **Obtain the number of relevant parties to the transaction as soon as an escrow account is opened.** **DO NOT** send an email to verify as the email address may be incorrect or the email may be intercepted by the fraudster.
- **USE COMPLEX EMAIL PASSWORDS** that employ a combination of mixed case, numbers, and symbols. Make your passwords greater than eight (8) characters. Also, change your password often and do **NOT** reuse the same password for other online accounts.
- **USE MULTI-FACTOR AUTHENTICATION** for email accounts. Your email provider or IT staff may have specific instructions on how to implement this feature.

For more information on wire-fraud scams or to report an incident, please refer to the following links:

Federal Bureau of Investigation:

<http://www.fbi.gov>

Internet Crime Complaint Center:

<http://www.ic3.gov>

FIDELITY NATIONAL FINANCIAL PRIVACY NOTICE

Effective January 1, 2026

Fidelity National Financial, Inc. and its majority-owned subsidiary companies (collectively, "FNF," "our," or "we") respect and are committed to protecting your privacy. This Privacy Notice explains how we collect, use, and protect personal information, when and to whom we disclose such information, and the choices you have about the use and disclosure of that information.

A limited number of FNF subsidiaries have their own privacy notices. If a subsidiary has its own privacy notice, the privacy notice will be available on the subsidiary's website and this Privacy Notice does not apply.

Collection of Personal Information

FNF may collect the following categories of Personal Information:

- contact information (e.g., name, address, phone number, email address);
- demographic information (e.g., date of birth, gender, marital status);
- identity information (e.g., Social Security Number, driver's license, passport, or other government ID number);
- financial account information (e.g., loan or bank account information);
- biometric data (e.g., fingerprints, retina or iris scans, voiceprints, or other unique biological characteristics); and
- other personal information necessary to provide products or services to you.

We may collect Personal Information about you from:

- information we receive from you or your agent;
- information about your transactions with FNF, our affiliates, or others; and
- information we receive from consumer reporting agencies and/or governmental entities, either directly from these entities or through others.

Collection of Device and Browsing Information

FNF automatically collects the following categories of Browsing Information when you access an FNF website, online service, or application (each an "FNF Website") from your Internet browser, computer, and/or device:

- Internet Protocol (IP) address and operating system;
- browser information, such as version, language, and type;
- device type and operating system;
- domain name system requests; and
- browsing history on the FNF Website, such as date and time of your visit to the FNF Website and visits to the pages within the FNF Website.

Like most websites, our servers automatically log each visitor to the FNF Website and may collect the Browsing Information described above. We use Browsing Information for system administration, troubleshooting, fraud investigation, and to improve our websites. Browsing Information generally does not reveal anything personal about you, though if you have created a user account for an FNF Website and are logged into that account, the FNF Website may be able to link certain browsing activity to your user account.

Other Online Specifics

Website Analytics. We use Google Analytics to understand how visitors interact with FNF Websites. Google Analytics may collect information such as your IP address, device type, and pages visited to help us analyze site traffic and to personalize your browsing experience on our site. If you don't want Google Analytics to be used in your browser, you can install the Google Analytics browser add-on, which Google makes available online.

Cookies. When you visit an FNF Website, a "cookie" may be sent to your computer. A cookie is a small piece of data that is sent to your Internet browser from a web server and stored on your computer's hard drive. Information gathered using cookies helps us improve your user experience. For example, a cookie can help the website load properly or can customize the display page based on your browser type and user preferences. You can choose whether or not to accept cookies by changing your Internet browser settings. Be aware that doing so may impair or limit some functionality of the FNF Website.

Web Beacons. We use web beacons to determine when and how many times a page has been viewed. This information is used to improve our websites.

Do Not Track. Currently our FNF Websites do not respond to "Do Not Track" features enabled through your browser.

Links to Other Sites. FNF Websites may contain links to unaffiliated third-party websites. FNF is not responsible for the privacy practices or content of those websites. We recommend that you read the privacy policy of every website you visit.

Use of Personal Information

FNF uses Personal Information for these main purposes:

- To provide products and services to you or in connection with a transaction involving you.
- To improve our products and services.
- To prevent and detect fraud;
- To maintain the security of our systems, tools, accounts, and applications;
- To verify and authenticate identities and credentials;
- To communicate with you about our, and our affiliates' services, jointly or independently;
- To provide reviews and testimonials about our services, with your consent.

When Information Is Disclosed

We may disclose the categories of Personal Information and Browsing Information listed above for the following purposes:

- to enable us to detect or prevent criminal activity, fraud, material misrepresentation, or nondisclosure;
- to affiliated or nonaffiliated service providers who provide or perform services or functions on our behalf and who agree to use the information only to provide such services or functions;
- to affiliated or nonaffiliated third parties with whom we perform joint marketing, pursuant to an agreement with them to jointly market financial products or services to you;
- to law enforcement or authorities in connection with an investigation, or in response to a subpoena or court order; or
- in the good-faith belief that such disclosure is necessary to comply with legal process or applicable laws, or to protect the rights, property, or safety of FNF, its customers, or the public.

The law does not require your prior authorization and does not allow you to restrict the disclosures described above. Additionally, we may disclose your information to third parties for whom you have given us authorization or consent to make such disclosure. We do not otherwise share your Personal Information or Browsing Information with nonaffiliated third parties, except as required or permitted by law.

We reserve the right to transfer your Personal Information, Browsing Information, and any other information, in connection with the sale or other disposition of all or part of the FNF business and/or assets, or in the event of bankruptcy, reorganization, insolvency, receivership, or an assignment for the benefit of creditors. By submitting Personal Information and/or Browsing Information to FNF, you expressly agree and consent to the use and/or transfer of the foregoing information in connection with any of the above described proceedings.

Security of Your Information

We maintain physical, electronic, and procedural safeguards to protect your Personal Information.

Choices With Your Information

Whether you submit Personal Information or Browsing Information to FNF is entirely up to you. If you decide not to submit Personal Information or Browsing Information, FNF may not be able to provide certain services or products to you.

State-Specific Consumer Privacy Information:

For additional information about your state-specific consumer privacy rights, to make a consumer privacy request, or to appeal a previous privacy request, please follow the link [Privacy Request](#), or email privacy@fnf.com, or call (888) 714-2710.

Certain state privacy laws require that FNF disclose the categories of third parties to which FNF may disclose the Personal Information and Browsing Information listed above. Those categories are:

- FNF affiliates and subsidiaries;
- Non-affiliated third parties, with your consent;
- Businesses in connection with the sale or other disposition of all or part of the FNF business and/or assets;
- Service providers;
- Law enforcement or authorities in connection with an investigation, or in response to a subpoena or court order.

For California Residents: We will not share your Personal Information or Browsing Information with nonaffiliated third parties, except as permitted by California law. For additional information about your California privacy rights, please visit the "California Privacy" link on our website (fnf.com/california-privacy) or call (888) 413-1748.

For Nevada Residents: We are providing this notice pursuant to state law. You may be placed on our internal Do Not Call List by calling FNF Privacy at (888) 714-2710 or by contacting us via the information set forth at the end of this Privacy Notice. For further information concerning Nevada's telephone solicitation law, you may contact: Bureau of Consumer Protection, Office of the Nevada Attorney General, 555 E. Washington St., Suite 3900, Las Vegas, NV 89101; Phone number: (702) 486-3132; email: aginquiries@ag.state.nv.us.

For Oregon Residents: We will not share your Personal Information or Browsing Information with nonaffiliated third parties for marketing purposes, except after you have been informed by us of such sharing and had an opportunity to indicate that you do not want a disclosure made for marketing purposes. For additional information about your Oregon consumer privacy rights, or to make a consumer privacy request, or appeal a previous privacy request, please email privacy@fnf.com or call (888) 714-2710

FNF is the controller of the following businesses registered with the Secretary of State in Oregon:

Chicago Title Company of Oregon, Fidelity National Title Company of Oregon, Lawyers Title of Oregon, LoanCare, Tigor, Title Company of Oregon, Western Title & Escrow Company, Chicago Title Company, Chicago Title Insurance Company, Commonwealth Land Title Insurance Company, Fidelity National Title Insurance Company, Liberty Title & Escrow, Novare National Settlement Service, Tigor Title Company of California, Exos Valuations, Fidelity & Guaranty Life, Insurance Agency, Fidelity National Home Warranty Company, Fidelity National Management Services, Fidelity Residential Solutions, FNF Insurance Services, FNTG National Record Centers, IPEX, Mission Servicing Residential, National Residential Nominee Services, National Safe Harbor Exchanges, National Title Insurance of New York, NationalLink Valuations, NexAce Corp., ServiceLink Auction, ServiceLink Management Company, ServiceLink Services, ServiceLink Title Company of Oregon, ServiceLink Valuation Solutions, Western Title & Escrow Company

For Vermont Residents: We will not disclose information about your creditworthiness to our affiliates and will not disclose your personal information, financial information, credit report, or health information to nonaffiliated third parties to market to you, other than as permitted by Vermont law, unless you authorize us to make those disclosures.

Information From Children

The FNF Websites are not intended or designed to attract persons under the age of eighteen (18). We do not collect Personal Information from any person that we know to be under the age of thirteen (13) without permission from a parent or guardian.

International Users

FNF's headquarters is located within the United States. If you reside outside the United States and choose to provide Personal Information or Browsing Information to us, please note that we may transfer that information outside of your country of residence. By providing FNF with your Personal Information and/or Browsing Information, you consent to our collection, transfer, and use of such information in accordance with this Privacy Notice.

FNF Website Services for Mortgage Loans

Certain FNF companies provide services to mortgage loan servicers, including hosting websites that collect customer information on behalf of mortgage loan servicers (the "Service Websites"). The Service Websites may contain links to both this Privacy Notice and the mortgage loan servicer or lender's privacy notice. The sections of this Privacy Notice titled When Information is Disclosed, Choices with Your Information, and Accessing and

Correcting Information do not apply to the Service Websites. The mortgage loan servicer or lender's privacy notice governs use, disclosure, and access to your Personal Information. FNF does not share Personal Information collected through the Service Websites, except as required or authorized by contract with the mortgage loan servicer or lender, or as required by law or in the good-faith belief that such disclosure is necessary: to comply with a legal process or applicable law, to enforce this Privacy Notice, or to protect the rights, property, or safety of FNF or the public.

Your Consent to this Privacy Notice; Notice Changes

By submitting Personal Information and/or Browsing Information to FNF, you consent to the collection and use of the information in accordance with this Privacy Notice. We may change this Privacy Notice at any time. The Privacy Notice's effective date will show the last date changes were made. If you provide information to us following any change of the Privacy Notice, that signifies your assent to and acceptance of the changes to the Privacy Notice.

Accessing and Correcting Information; Contact Us

If you have questions or would like to correct your Personal Information, visit FNF's [Privacy Request](#) website or contact us by phone at (888) 714-2710, by email at privacy@fnf.com, or by mail to:

Fidelity National Financial, Inc.
601 Riverside Avenue,
Jacksonville, Florida 32204
Attn: Chief Privacy Officer

ATTACHMENT ONE

CALIFORNIA LAND TITLE ASSOCIATION STANDARD COVERAGE POLICY - 1990 (11-09-18)

EXCLUSIONS FROM COVERAGE

The following matters are expressly excluded from the coverage of this policy and the Company will not pay loss or damage, costs, attorneys' fees or expenses which arise by reason of:

1. (a) Any law, ordinance or governmental regulation (including but not limited to building or zoning laws, ordinances, or regulations) restricting, regulating, prohibiting or relating (i) the occupancy, use, or enjoyment of the land; (ii) the character, dimensions or location of any improvement now or hereafter erected on the land; (iii) a separation in ownership or a change in the dimensions or area of the land or any parcel of which the land is or was a part; or (iv) environmental protection, or the effect of any violation of these laws, ordinances or governmental regulations, except to the extent that a notice of the enforcement thereof or a notice of a defect, lien, or encumbrance resulting from a violation or alleged violation affecting the land has been recorded in the public records at Date of Policy.
- (b) Any governmental police power not excluded by (a) above, except to the extent that a notice of the exercise thereof or notice of a defect, lien or encumbrance resulting from a violation or alleged violation affecting the land has been recorded in the public records at Date of Policy.
2. Rights of eminent domain unless notice of the exercise thereof has been recorded in the public records at Date of Policy, but not excluding from coverage any taking which has occurred prior to Date of Policy which would be binding on the rights of a purchaser for value without knowledge.
3. Defects, liens, encumbrances, adverse claims or other matters:
 - (a) whether or not recorded in the public records at Date of Policy, but created, suffered, assumed or agreed to by the insured claimant;
 - (b) not known to the Company, not recorded in the public records at Date of Policy, but known to the insured claimant and not disclosed in writing to the Company by the insured claimant prior to the date the insured claimant became an insured under this policy;
 - (c) resulting in no loss or damage to the insured claimant;
 - (d) attaching or created subsequent to Date of Policy; or
 - (e) resulting in loss or damage which would not have been sustained if the insured claimant had paid value for the insured mortgage or for the estate or interest insured by this policy.
4. Unenforceability of the lien of the insured mortgage because of the inability or failure of the insured at Date of Policy, or the inability or failure of any subsequent owner of the indebtedness, to comply with the applicable doing business laws of the state in which the land is situated.
5. Invalidity or unenforceability of the lien of the insured mortgage, or claim thereof, which arises out of the transaction evidenced by the insured mortgage and is based upon usury or any consumer credit protection or truth in lending law.
6. Any claim, which arises out of the transaction vesting in the insured the estate or interest insured by this policy or the transaction creating the interest of the insured lender, by reason of the operation of federal bankruptcy, state insolvency or similar creditors' rights laws.

EXCEPTIONS FROM COVERAGE - SCHEDULE B, PART I

This policy does not insure against loss or damage (and the Company will not pay costs, attorneys' fees or expenses) which arise by reason of:

1. Taxes or assessments which are not shown as existing liens by the records of any taxing authority that levies taxes or assessments on real property or by the public records.
Proceedings by a public agency which may result in taxes or assessments, or notices of such proceedings, whether or not shown by the records of such agency or by the public records.
2. Any facts, rights, interests, or claims which are not shown by the public records but which could be ascertained by an inspection of the land or which may be asserted by persons in possession thereof.
3. Easements, liens or encumbrances, or claims thereof, not shown by the public records.
4. Discrepancies, conflicts in boundary lines, shortage in area, encroachments, or any other facts which a correct survey would disclose, and which are not shown by the public records.
5. (a) Unpatented mining claims; (b) reservations or exceptions in patents or in Acts authorizing the issuance thereof; (c) water rights, claims or title to water, whether or not the matters excepted under (a), (b) or (c) are shown by the public records.
6. Any lien or right to a lien for services, labor or material unless such lien is shown by the public records at Date of Policy.

EXCEPTIONS FROM COVERAGE - SCHEDULE B, PART II

(Variable exceptions such as taxes, easements, CC&R's, etc., are inserted here)

ATTACHMENT ONE (CONTINUED)

CALIFORNIA LAND TITLE ASSOCIATION STANDARD COVERAGE OWNER'S POLICY (02-04-22)

EXCLUSIONS FROM COVERAGE

The following matters are excluded from the coverage of this policy, and the Company will not pay loss or damage, costs, attorneys' fees, or expenses that arise by reason of:

1. a. any law, ordinance, permit, or governmental regulation (including those relating to building and zoning) that restricts, regulates, prohibits, or relates to:
 - i. the occupancy, use, or enjoyment of the Land;
 - ii. the character, dimensions, or location of any improvement on the Land;
 - iii. the subdivision of land; or
 - iv. environmental remediation or protection.
- b. any governmental forfeiture, police, regulatory, or national security power.
- c. the effect of a violation or enforcement of any matter excluded under Exclusion 1.a. or 1.b.
Exclusion 1 does not modify or limit the coverage provided under Covered Risk 5 or 6.
2. Any power of eminent domain. Exclusion 2 does not modify or limit the coverage provided under Covered Risk 7.
3. Any defect, lien, encumbrance, adverse claim, or other matter:
 - a. created, suffered, assumed, or agreed to by the Insured Claimant;
 - b. not Known to the Company, not recorded in the Public Records at the Date of Policy, but Known to the Insured Claimant and not disclosed in writing to the Company by the Insured Claimant prior to the date the Insured Claimant became an Insured under this policy;
 - c. resulting in no loss or damage to the Insured Claimant;
 - d. attaching or created subsequent to the Date of Policy (Exclusion 3.d. does not modify or limit the coverage provided under Covered Risk 9 or 10); or
 - e. resulting in loss or damage that would not have been sustained if consideration sufficient to qualify the Insured named in Schedule A as a bona fide purchaser had been given for the Title at the Date of Policy.
4. Any claim, by reason of the operation of federal bankruptcy, state insolvency, or similar creditors' rights law, that the transaction vesting the Title as shown in Schedule A is a:
 - a. fraudulent conveyance or fraudulent transfer;
 - b. voidable transfer under the Uniform Voidable Transactions Act; or
 - c. preferential transfer:
 - i. to the extent the instrument of transfer vesting the Title as shown in Schedule A is not a transfer made as a contemporaneous exchange for new value; or
 - ii. for any other reason not stated in Covered Risk 9.b.
5. Any claim of a PACA-PSA Trust. Exclusion 5 does not modify or limit the coverage provided under Covered Risk 8.
6. Any lien on the Title for real estate taxes or assessments imposed or collected by a governmental authority that becomes due and payable after the Date of Policy.
Exclusion 6 does not modify or limit the coverage provided under Covered Risk 2.b.
7. Any discrepancy in the quantity of the area, square footage, or acreage of the Land or of any improvement to the Land.

EXCEPTIONS FROM COVERAGE

Some historical land records contain Discriminatory Covenants that are illegal and unenforceable by law. This policy treats any Discriminatory Covenant in a document referenced in Schedule B as if each Discriminatory Covenant is redacted, repudiated, removed, and not republished or recirculated. Only the remaining provisions of the document are excepted from coverage.

This policy does not insure against loss or damage and the Company will not pay costs, attorneys' fees, or expenses resulting from the terms and conditions of any lease or easement identified in Schedule A, and the following matters:

PART I

1. (a) Taxes or assessments that are not shown as existing liens by the records of any taxing authority that levies taxes or assessments on real property or by the Public Records; (b) proceedings by a public agency that may result in taxes or assessments, or notices of such proceedings, whether or not shown by the records of such agency or by the Public Records.
2. Any facts, rights, interests, or claims that are not shown by the Public Records at Date of Policy but that could be (a) ascertained by an inspection of the Land, or (b) asserted by persons or parties in possession of the Land.
3. Easements, liens or encumbrances, or claims thereof, not shown by the Public Records at Date of Policy.
4. Any encroachment, encumbrance, violation, variation, easement, or adverse circumstance affecting the Title that would be disclosed by an accurate and complete land survey of the Land and not shown by the Public Records at Date of Policy.
5. (a) Unpatented mining claims; (b) reservations or exceptions in patents or in Acts authorizing the issuance thereof; (c) water rights, claims or title to water, whether or not the matters excepted under (a), (b), or (c) are shown by the Public Records.
6. Any lien or right to a lien for services, labor, material or equipment unless such lien is shown by the Public Records at Date of Policy.
7. Any claim to (a) ownership of or rights to minerals and similar substances, including but not limited to ores, metals, coal, lignite, oil, gas, uranium, clay, rock, sand, and gravel located in, on, or under the Land or produced from the Land, whether such ownership or rights arise by lease, grant, exception, conveyance, reservation, or otherwise; and (b) any rights, privileges, immunities, rights of way, and easements associated therewith or appurtenant thereto, whether or not the interests or rights excepted in (a) or (b) appear in the Public Records or are shown in Schedule B.

PART II

(Variable exceptions such as taxes, easements, CC&R's, etc., are inserted here)

**ATTACHMENT ONE
(CONTINUED)**

**CLTA/ALTA HOMEOWNER'S POLICY OF TITLE INSURANCE (7-01-21)
EXCLUSIONS FROM COVERAGE**

The following matters are excluded from the coverage of this policy and We will not pay loss or damage, costs, attorneys' fees, or expenses that arise by reason of:

1. a. any law, ordinance, permit, or governmental regulation (including those relating to building and zoning) that restricts, regulates, prohibits, or relates to:
 - i. the occupancy, use, or enjoyment of the Land;
 - ii. the character, dimensions, or location of any improvement on the Land;
 - iii. the subdivision of land; or
 - iv. environmental remediation or protection.
 - b. any governmental forfeiture, police, or regulatory, or national security power.
 - c. the effect of a violation or enforcement of any matter excluded under Exclusion 1.a. or 1.b.
- Exclusion 1 does not modify or limit the coverage provided under Covered Risk 8.a., 14, 15, 16, 18, 19, 20, 23, or 27.
2. Any power to take the Land by condemnation. Exclusion 2 does not modify or limit the coverage provided under Covered Risk 17.
 3. Any defect, lien, encumbrance, adverse claim, or other matter:
 - a. created, suffered, assumed, or agreed to by You;
 - b. not Known to Us, not recorded in the Public Records at the Date of Policy, but Known to You and not disclosed in writing to Us by You prior to the date You became an Insured under this policy;
 - c. resulting in no loss or damage to You;
 - d. attaching or created subsequent to the Date of Policy (Exclusion 3.d. does not modify or limit the coverage provided under Covered Risk 5, 8.f., 25, 26, 27, 28, or 32); or
 - e. resulting in loss or damage that would not have been sustained if You paid consideration sufficient to qualify You as a bona fide purchaser of the Title at the Date of Policy.
 4. Lack of a right:
 - a. to any land outside the area specifically described and referred to in Item 3 of Schedule A; and
 - b. in any street, road, avenue, alley, lane, right-of-way, body of water, or waterway that abut the Land.Exclusion 4 does not modify or limit the coverage provided under Covered Risk 11 or 21.
 5. The failure of Your existing structures, or any portion of Your existing structures, to have been constructed before, on, or after the Date of Policy in accordance with applicable building codes. Exclusion 5 does not modify or limit the coverage provided under Covered Risk 14 or 15.
 6. Any claim, by reason of the operation of federal bankruptcy, state insolvency, or similar creditors' rights law, that the transfer of the Title to You is a:
 - a. fraudulent conveyance or fraudulent transfer;
 - b. voidable transfer under the Uniform Voidable Transactions Act; or
 - c. preferential transfer:
 - i. to the extent the instrument of transfer vesting the Title as shown in Schedule A is not a transfer made as a contemporaneous exchange for new value; or
 - ii. for any other reason not stated in Covered Risk 30.
 7. Contamination, explosion, fire, flooding, vibration, fracturing, earthquake, or subsidence.
 8. Negligence by a person or an entity exercising a right to extract or develop oil, gas, minerals, groundwater, or any other subsurface substance.
 9. Any lien on Your Title for real estate taxes or assessments, imposed or collected by a governmental authority that becomes due and payable after the Date of Policy. Exclusion 9 does not modify or limit the coverage provided under Covered Risk 8.a or 27.
 10. Any discrepancy in the quantity of the area, square footage, or acreage of the Land or of any improvement to the Land.

LIMITATIONS ON COVERED RISKS

Your insurance for the following Covered Risks is limited on the Owner's Coverage Statement as follows:

- For Covered Risk 16, 18, 19 and 21 Your Deductible Amount and Our Maximum Dollar Limit of Liability shown in Schedule A.

The deductible amounts and maximum dollar limits shown on Schedule A are as follows:

	<u>Your Deductible Amount</u>	<u>Our Maximum Dollar Limit of Liability</u>
Covered Risk 16:	1.00% of Policy Amount Shown in Schedule A or \$2,500.00 (whichever is less)	\$ 10,000.00
Covered Risk 18:	1.00% of Policy Amount Shown in Schedule A or \$5,000.00 (whichever is less)	\$ 25,000.00
Covered Risk 19:	1.00% of Policy Amount Shown in Schedule A or \$5,000.00 (whichever is less)	\$ 25,000.00
Covered Risk 21:	1.00% of Policy Amount Shown in Schedule A or \$2,500.00 (whichever is less)	\$ 5,000.00

**ATTACHMENT ONE
(CONTINUED)**

**CLTA/ALTA HOMEOWNER'S POLICY OF TITLE INSURANCE (12-02-13)
EXCLUSIONS**

In addition to the Exceptions in Schedule B, You are not insured against loss, costs, attorneys' fees, and expenses resulting from:

1. Governmental police power, and the existence or violation of those portions of any law or government regulation concerning:
 - a. building;
 - b. zoning;
 - c. land use;
 - d. improvements on the Land;
 - e. land division; and
 - f. environmental protection.This Exclusion does not limit the coverage described in Covered Risk 8.a., 14, 15, 16, 18, 19, 20, 23 or 27.
2. The failure of Your existing structures, or any part of them, to be constructed in accordance with applicable building codes. This Exclusion does not limit the coverage described in Covered Risk 14 or 15.
3. The right to take the Land by condemning it. This Exclusion does not limit the coverage described in Covered Risk 17.
4. Risks:
 - a. that are created, allowed, or agreed to by You, whether or not they are recorded in the Public Records;
 - b. that are Known to You at the Policy Date, but not to Us, unless they are recorded in the Public Records at the Policy Date;
 - c. that result in no loss to You; or
 - d. that first occur after the Policy Date - this does not limit the coverage described in Covered Risk 7, 8.e., 25, 26, 27 or 28.
5. Failure to pay value for Your Title.
6. Lack of a right:
 - a. to any land outside the area specifically described and referred to in paragraph 3 of Schedule A; and
 - b. in streets, alleys, or waterways that touch the Land.This Exclusion does not limit the coverage described in Covered Risk 11 or 21.
7. The transfer of the Title to You is invalid as a preferential transfer or as a fraudulent transfer or conveyance under federal bankruptcy, state insolvency, or similar creditors' rights laws.
8. Contamination, explosion, fire, flooding, vibration, fracturing, earthquake or subsidence.
9. Negligence by a person or an Entity exercising a right to extract or develop minerals, water, or any other substances.

LIMITATIONS ON COVERED RISKS

Your insurance for the following Covered Risks is limited on the Owner's Coverage Statement as follows:

- For Covered Risk 16, 18, 19 and 21, Your Deductible Amount and Our Maximum Dollar Limit of Liability shown in Schedule A.

The deductible amounts and maximum dollar limits shown on Schedule A are as follows:

	<u>Your Deductible Amount</u>	<u>Our Maximum Dollar Limit of Liability</u>
Covered Risk 16:	1.00% of Policy Amount Shown in Schedule A or \$2,500.00 (whichever is less)	\$ 10,000.00
Covered Risk 18:	1.00% of Policy Amount Shown in Schedule A or \$5,000.00 (whichever is less)	\$ 25,000.00
Covered Risk 19:	1.00% of Policy Amount Shown in Schedule A or \$5,000.00 (whichever is less)	\$ 25,000.00
Covered Risk 21:	1.00% of Policy Amount Shown in Schedule A or \$2,500.00 (whichever is less)	\$ 5,000.00

ATTACHMENT ONE (CONTINUED)

ALTA OWNER'S POLICY (07-01-2021)

EXCLUSIONS FROM COVERAGE

The following matters are excluded from the coverage of this policy, and the Company will not pay loss or damage, costs, attorneys' fees, or expenses that arise by reason of:

1. a. any law, ordinance, permit, or governmental regulation (including those relating to building and zoning) that restricts, regulates, prohibits, or relates to:
 - i. the occupancy, use, or enjoyment of the Land;
 - ii. the character, dimensions, or location of any improvement on the Land;
 - iii. the subdivision of land; or
 - iv. environmental remediation or protection.
- b. any governmental forfeiture, police, regulatory, or national security power.
- c. the effect of a violation or enforcement of any matter excluded under Exclusion 1.a. or 1.b.
Exclusion 1 does not modify or limit the coverage provided under Covered Risk 5 or 6.
2. Any power of eminent domain. Exclusion 2 does not modify or limit the coverage provided under Covered Risk 7.
3. Any defect, lien, encumbrance, adverse claim, or other matter:
 - a. created, suffered, assumed, or agreed to by the Insured Claimant;
 - b. not Known to the Company, not recorded in the Public Records at the Date of Policy, but Known to the Insured Claimant and not disclosed in writing to the Company by the Insured Claimant prior to the date the Insured Claimant became an Insured under this policy;
 - c. resulting in no loss or damage to the Insured Claimant;
 - d. attaching or created subsequent to the Date of Policy (Exclusion 3.d. does not modify or limit the coverage provided under Covered Risk 9 or 10); or
 - e. resulting in loss or damage that would not have been sustained if consideration sufficient to qualify the Insured named in Schedule A as a bona fide purchaser had been given for the Title at the Date of Policy.
4. Any claim, by reason of the operation of federal bankruptcy, state insolvency, or similar creditors' rights law, that the transaction vesting the Title as shown in Schedule A is a:
 - a. fraudulent conveyance or fraudulent transfer;
 - b. voidable transfer under the Uniform Voidable Transactions Act; or
 - c. preferential transfer:
 - i. to the extent the instrument of transfer vesting the Title as shown in Schedule A is not a transfer made as a contemporaneous exchange for new value; or
 - ii. for any other reason not stated in Covered Risk 9.b.
5. Any claim of a PACA-PSA Trust. Exclusion 5 does not modify or limit the coverage provided under Covered Risk 8.
6. Any lien on the Title for real estate taxes or assessments, imposed or collected by a governmental authority that becomes due and payable after the Date of Policy. Exclusion 6 does not modify or limit the coverage provided under Covered Risk 2.b.
7. Any discrepancy in the quantity of the area, square footage, or acreage of the Land or of any improvement to the Land.

EXCEPTIONS FROM COVERAGE

Some historical land records contain Discriminatory Covenants that are illegal and unenforceable by law. This policy treats any Discriminatory Covenant in a document referenced in Schedule B as if each Discriminatory Covenant is redacted, repudiated, removed, and not republished or recirculated. Only the remaining provisions of the document are excepted from coverage.

This policy does not insure against loss or damage and the Company will not pay costs, attorneys' fees, or expenses resulting from the terms and conditions of any lease or easement identified in Schedule A, and the following matters:

NOTE: The 2021 ALTA Owner's Policy may be issued to afford either Standard Coverage or Extended Coverage. In addition to variable exceptions such as taxes, easements, CC&R's, etc., the Exceptions from Coverage in a Standard Coverage policy will also include the Western Regional Standard Coverage Exceptions listed as 1 through 7 below:

1. (a) Taxes or assessments that are not shown as existing liens by the records of any taxing authority that levies taxes or assessments on real property or by the Public Records; (b) proceedings by a public agency that may result in taxes or assessments, or notices of such proceedings, whether or not shown by the records of such agency or by the Public Records.
2. Any facts, rights, interests, or claims that are not shown by the Public Records at Date of Policy but that could be (a) ascertained by an inspection of the Land or (b) asserted by persons or parties in possession of the Land.
3. Easements, liens or encumbrances, or claims thereof, not shown by the Public Records at Date of Policy.
4. Any encroachment, encumbrance, violation, variation, easement, or adverse circumstance affecting the Title that would be disclosed by an accurate and complete land survey of the Land and not shown by the Public Records at Date of Policy.
5. (a) Unpatented mining claims; (b) reservations or exceptions in patents or in Acts authorizing the issuance thereof; (c) water rights, claims or title to water, whether or not the matters excepted under (a), (b), or (c) are shown by the Public Records.
6. Any lien or right to a lien for services, labor, material or equipment unless such lien is shown by the Public Records at Date of Policy.
7. Any claim to (a) ownership of or rights to minerals and similar substances, including but not limited to ores, metals, coal, lignite, oil, gas, uranium, clay, rock, sand, and gravel located in, on, or under the Land or produced from the Land, whether such ownership or rights arise by lease, grant, exception, conveyance, reservation, or otherwise; and (b) any rights, privileges, immunities, rights of way, and easements associated therewith or appurtenant thereto, whether or not the interests or rights excepted in (a) or (b) appear in the Public Records or are shown in Schedule B.

ATTACHMENT ONE (CONTINUED)

2006 ALTA OWNER'S POLICY (06-17-06)

EXCLUSIONS FROM COVERAGE

The following matters are expressly excluded from the coverage of this policy, and the Company will not pay loss or damage, costs, attorneys' fees, or expenses that arise by reason of:

1. (a) Any law, ordinance, permit, or governmental regulation (including those relating to building and zoning) restricting, regulating, prohibiting, or relating to
 - (i) the occupancy, use, or enjoyment of the Land;
 - (ii) the character, dimensions, or location of any improvement erected on the Land;
 - (iii) the subdivision of land; or
 - (iv) environmental protection;or the effect of any violation of these laws, ordinances, or governmental regulations. This Exclusion 1(a) does not modify or limit the coverage provided under Covered Risk 5.
- (b) Any governmental police power. This Exclusion 1(b) does not modify or limit the coverage provided under Covered Risk 6.
2. Rights of eminent domain. This Exclusion does not modify or limit the coverage provided under Covered Risk 7 or 8.
3. Defects, liens, encumbrances, adverse claims, or other matters
 - (a) created, suffered, assumed, or agreed to by the Insured Claimant;
 - (b) not Known to the Company, not recorded in the Public Records at Date of Policy, but Known to the Insured Claimant and not disclosed in writing to the Company by the Insured Claimant prior to the date the Insured Claimant became an Insured under this policy;
 - (c) resulting in no loss or damage to the Insured Claimant;
 - (d) attaching or created subsequent to Date of Policy (however, this does not modify or limit the coverage provided under Covered Risk 9 and 10); or
 - (e) resulting in loss or damage that would not have been sustained if the Insured Claimant had paid value for the Title.
4. Any claim, by reason of the operation of federal bankruptcy, state insolvency, or similar creditors' rights laws, that the transaction vesting the Title as shown in Schedule A, is
 - (a) a fraudulent conveyance or fraudulent transfer; or
 - (b) a preferential transfer for any reason not stated in Covered Risk 9 of this policy.
5. Any lien on the Title for real estate taxes or assessments imposed by governmental authority and created or attaching between Date of Policy and the date of recording of the deed or other instrument of transfer in the Public Records that vests Title as shown in Schedule A.

EXCEPTIONS FROM COVERAGE

This policy does not insure against loss or damage, and the Company will not pay costs, attorneys' fees, or expenses that arise by reason of:

NOTE: The 2006 ALTA Owner's Policy may be issued to afford either Standard Coverage or Extended Coverage. In addition to variable exceptions such as taxes, easements, CC&R's, etc., the Exceptions from Coverage in a Standard Coverage policy will also include the Western Regional Standard Coverage Exceptions listed below as 1 through 7 below:

1. (a) Taxes or assessments that are not shown as existing liens by the records of any taxing authority that levies taxes or assessments on real property or by the Public Records; (b) proceedings by a public agency that may result in taxes or assessments, or notices of such proceedings, whether or not shown by the records of such agency or by the Public Records.
2. Any facts, rights, interests, or claims that are not shown by the Public Records at Date of Policy but that could be (a) ascertained by an inspection of the Land, or (b) asserted by persons or parties in possession of the Land.
3. Easements, liens or encumbrances, or claims thereof, not shown by the Public Records at Date of Policy.
4. Any encroachment, encumbrance, violation, variation, easement, or adverse circumstance affecting the Title that would be disclosed by an accurate and complete land survey of the Land and not shown by the Public Records at Date of Policy.
5. (a) Unpatented mining claims; (b) reservations or exceptions in patents or in Acts authorizing the issuance thereof; (c) water rights, claims or title to water, whether or not the matters excepted under (a), (b), or (c) are shown by the Public Records.
6. Any lien or right to a lien for services, labor, material or equipment unless such lien is shown by the Public Records at Date of Policy.]
7. Any claim to (a) ownership of or rights to minerals and similar substances, including but not limited to ores, metals, coal, lignite, oil, gas, uranium, clay, rock, sand, and gravel located in, on, or under the Land or produced from the Land, whether such ownership or rights arise by lease, grant, exception, conveyance, reservation, or otherwise; and (b) any rights, privileges, immunities, rights of way, and easements associated therewith or appurtenant thereto, whether or not the interests or rights excepted in (a) or (b) appear in the Public Records or are shown in Schedule B.

Notice of Available Discounts

Pursuant to Section 2355.3 in Title 10 of the California Code of Regulations Fidelity National Financial, Inc. and its subsidiaries ("FNF") must deliver a notice of each discount available under our current rate filing along with the delivery of escrow instructions, a preliminary report or commitment. Please be aware that the provision of this notice does not constitute a waiver of the consumer's right to be charged the filed rate. As such, your transaction may not qualify for the below discounts.

You are encouraged to discuss the applicability of one or more of the below discounts with a Company representative. These discounts are generally described below; consult the rate manual for a full description of the terms, conditions and requirements for such discount. These discounts only apply to transactions involving services rendered by the FNF Family of Companies. This notice only applies to transactions involving property improved with a one-to-four family residential dwelling.

Not all discounts are offered by every FNF Company. The discount will only be applicable to the FNF Company as indicated by the named discount.

FNF Underwritten Title Companies

CTC - Chicago Title Company
CLTC - Commonwealth Land Title Company
FNTC - Fidelity National Title Company
FNTCCA - Fidelity National Title Company of California
TICOR - Ticor Title Company of California
LTC - Lawyer's Title Company
SLTC - ServiceLink Title Company

Underwritten by FNF Underwriters

CTIC - Chicago Title Insurance Company
CLTIC - Commonwealth Land Title Insurance Co.
FNTIC - Fidelity National Title Insurance Co.
NTINY - National Title Insurance of New York

Available Discounts

CHURCHES OR CHARITABLE NON-PROFIT ORGANIZATIONS (CTIC, CLTIC, FNTIC, NTINY)

On properties used as a church or for charitable purposes within the scope of the normal activities of such entities, provided said charge is normally the church's obligation the charge for an owner's policy shall be fifty percent (50%) to seventy percent (70%) of the appropriate title insurance rate, depending on the type of coverage selected. The charge for a lender's policy shall be forty percent (40%) to fifty percent (50%) of the appropriate title insurance rate, depending on the type of coverage selected.

DISASTER AREA TRANSACTIONS (CTIC, CLTIC, FNTIC, NTINY)

This rate is available for individuals or entities that were victims of a national or state disaster. The rate can be used for a Lender's Policy (Standard or Extended), or an Owner's Policy (Standard or Homeowners coverage). To qualify for this rate, the applicant must, prior to the closing of the applicable transaction, make a written request, including a statement meeting the following criteria:

- A. The subject property is in a disaster area declared by the government of the United States or the State of California.
- B. The subject property was substantially or totally destroyed in the declared disaster.
- C. The subject property ownership has not changed since the time of the disaster.

The rate will be fifty percent (50%) of the applicable rate, and the transaction must be completed within sixty (60) months of the date of the declaration of the disaster.

Notice of Available Discounts

(continued)

DISASTER AREA ESCROWS (CTC, CLTC, FNTC, TICOR, LTC)

This rate is available for individuals or entities that were victims of a national or state disaster. The rate can be used for a loan or a sale escrow transaction. To qualify for this rate, the applicant must, prior to the closing of the applicable transaction, make a written request, including a statement meeting the following criteria:

- A. The subject property is in a disaster area declared by the government of the United States or the State of California.
- B. The subject property was substantially or totally destroyed in the declared disaster.
- C. The subject property ownership has not changed since the time of the disaster.

The rate will be fifty percent (50%) of the applicable rate, and the transaction must be completed within sixty (60) months of the date of the declaration of the disaster. Standard minimum charge applies based upon property type. No other discounts or special rates, or combination of discounts or special rates, shall be applicable. Applies to a single transaction per property.

This rate is applicable to the following Zones/Counties:

Zone 1.A: Orange County

Zone 1.B: Riverside and San Bernardino Counties

Zone 2: Los Angeles County

Zone 3: Ventura County

Zone 10: San Diego County

Zone 12: Imperial County

If used for a sale transaction, the application of this rate assumes the charge for the Residential Sale Escrow Services (RSES) fee will be split evenly between buyer and seller. As such and regardless of how the calculated applicable RSES will be split between the disaster victim and the other principal, the rate will be applied only to one half (1/2) of the calculated applicable RSES fee, regardless of whether the disaster victim is paying half (1/2) of the RSES fee (as is customary) or paying the entire fee. The rate under this provision will be fifty percent (50%) of disaster victims' one half (1/2) portion only and shall not apply to any portion paid by non-disaster victim. Additional services will be charged at the normal rates.

MILITARY DISCOUNT RATE (CTIC, CLTIC, FNTIC)

Upon the Company being advised in writing and prior to the closing of the transaction that an active duty, honorably separated, or retired member of the United States Military or Military Reserves or National Guard is acquiring or selling an owner occupied one-to-four family property, the selling owner or acquiring buyer, as applicable, will be entitled to a discount equal to fifteen percent (15%) of the otherwise applicable rates such party would be charged for title insurance policies. Minimum charge: Four Hundred Twenty-Five And No/100 Dollars (\$425.00)

The Company may require proof of eligibility from the parties to the transaction verifying they are entitled to the discount as described. No other discounts or special rates, or combination of discounts or special rates, shall be applicable.

This map/plat is being furnished as an aid in locating the herein described Land in relation to adjoining streets, natural boundaries, and other land, and is not a survey of the land depicted. Except to the extent a policy of title insurance is expressly modified by endorsement, if any, the Company does not insure dimensions, distances, location of easements, acreage or other matters shown thereon.

This map/plat is being furnished as an aid in locating the herein described Land in relation to adjoining streets, natural boundaries and other land, and is not a survey of the land depicted. Except to the extent a policy of title insurance is expressly modified by endorsement, if any, the Company does not insure dimensions, distances, location of easements, acreage or other matters shown thereon.

Tax Rate Area
03001

RANCHO EL RIO DE SANTA CLARA O'LA COLONIA

05

06

PIQ

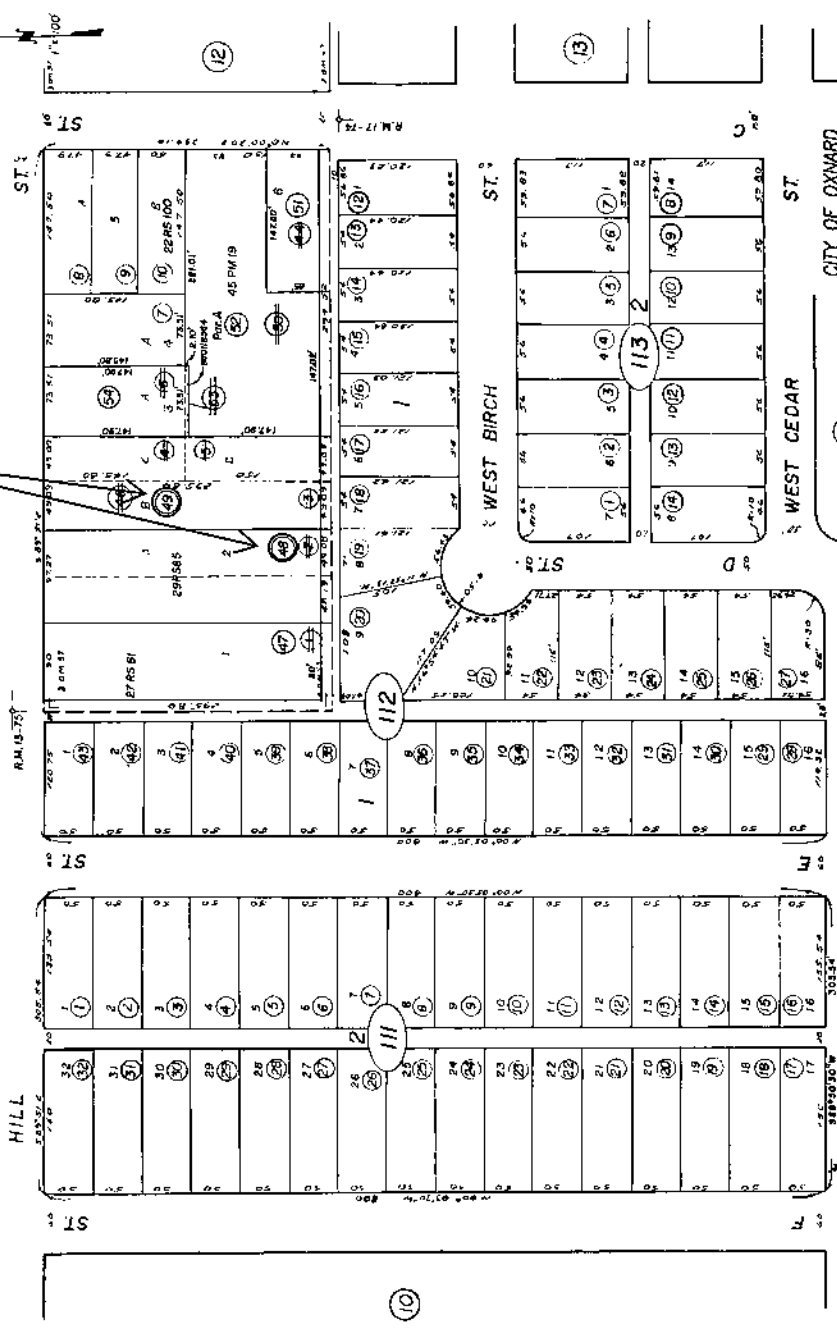

CITY OF OXNARD
Ventura County Assessor's Map.

DRAWN	REVISED	4-5-2002
REDESIGNED	CREATED	
AMENDED	PLOTTED/EFFECTIVE	
	PREVIOUS EDITION	Form No. 11
	ROLL	
Compiled By Ventura County Assessor's Office		

Assessor's Block Numbers Shown in Ellipse.
Assessor's Parcel Numbers Shown in Circles.
Assessor's Acreal Numbers Shown in Squares.

Hill Street Sub. M.R. Bk. 13, Pg. 75
Krouser Tract 1, M.R. Bk. 17, Pg. 74
Laurent Tract, 3 O.M. 57, Unrec.

PLANNING DIVISION TO VERIFY.

This map/plot is being furnished as an aid in locating the herein described Land in relation to adjoining streets, natural boundaries and other land, and is not a survey of the land depicted. Except to the extent a policy of title insurance is expressly modified by endorsement, if any, the Company does not insure dimensions, distances, location of easements, acreage or other matters shown thereon.