

Y in R/W

SUBJECT TO FINISHABLE
REFUND UNDER SECTION 2.6
ORDINANCE No. 1396 (N.S.)

Permit No. **77322**
R
XXXXX J5447-1B

Address **6026 Oliva Ave.**

Lot **99** **7160002071**

Block **Tract 12673**

Contractor **Espinosa & Espinosa**

Owner **West Mayfair Co.**

~~XXXXXXXXXXXX~~ **29.0' S. of upper MH** ✓

Sta. of "Y" **2+91.0**

Between **Ashworth St.**
and **Hedda St.**

Date Permit Issued **2-13-47**

Date Inspected **2-24-47**

By **Bastion** Inspector

Remarks **OK con & tested caps in**

50'
26.6"

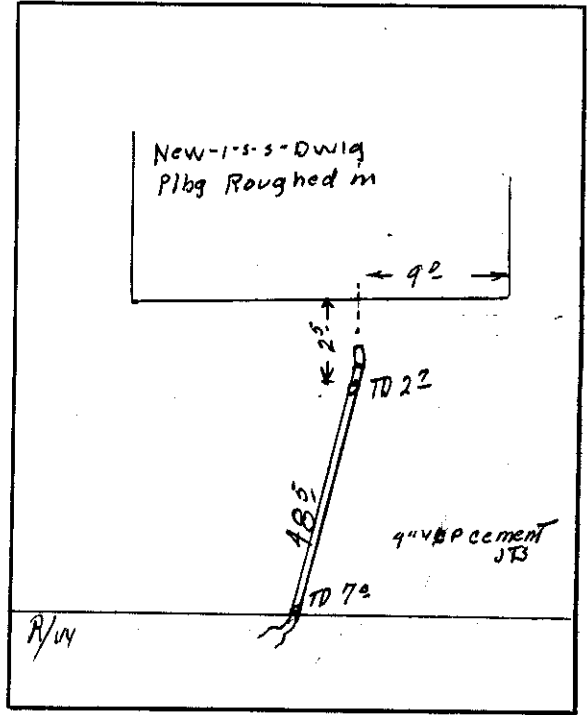
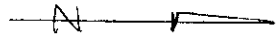

R/W

6026 N. Oliva Ave.

7160002071

3005

DEPARTMENT OF BUILDING AND SAFETY
COUNTY OF LOS ANGELES

WM. J. FOX, CHIEF ENGINEER

APPLICATION FOR PERMIT

BUILDING 149

FOR APPLICANT TO FILL IN

BUILDING ADDRESS 6026 Oliva Ave.
LOCALITY Mayfair District
NEAREST CROSS ST. Hedda
OWNER West Mayfair Company
MAIL ADDRESS 5801 Lakewood Blvd.
CITY Bellflower TEL. NO. ME 3-1143
ARCHITECT OR ENGINEER TEL. NO.

ADDRESS
CONTRACTOR Paul W. Trousdale TEL. NO. AR 9-6179

ADDRESS 650 No. Sepulveda
Los Angeles 24, Calif.

LEGAL DESCRIPTION LOT NO. 99 BLOCK

TRACT 12673

SIZE OF LOT 50x100 NO. OF BLDGS. NOW ON LOT none

USE OF EXISTING BLDG. none NO. OF FAMILIES -- 0 NO. OF ROOMS --

DESCRIPTION OF WORK

NEW	<input checked="" type="checkbox"/>	ALTERATION	<input type="checkbox"/>	ADDITION	<input type="checkbox"/>
REPAIR	<input type="checkbox"/>	MOVING	<input type="checkbox"/>	DEMOLISH	<input type="checkbox"/>

SQ. FT. SIZE 1150 NO. OF ROOMS 6 STORIES 1

WALL COVERING stucco ROOF COVERING shingle

USE OF NEW BUILDING residence & garage

Type G-3R

Standard Plan 4-970

Priority #66 122 001252

I HEREBY ACKNOWLEDGE THAT I HAVE READ THIS APPLICATION AND STATE THAT THE ABOVE IS CORRECT AND AGREE TO COMPLY WITH ALL COUNTY ORDINANCES AND STATE LAWS REGULATING BUILDING CONSTRUCTION.

SIGNATURE OF OWNER WEST MAYFAIR COMPANY
AUTHORIZED AGT. *CH Goodshell*

\$ 7400.00

VALUATION

P. C. S FEE 4.50
FEE 18.00

FOR OFFICE USE ONLY

DISTRICT NO. 4 PLAN CK. NO. B32462 PERMIT NO. B32288
RECEIVED BY P.M. DATE OF APPL. 7/25/46 DATE ISSUED 7/25/46
BUILDING ADDRESS 6026 OLIVA AVE
LOCALITY MAYFAIR DIST.
NEAREST CROSS ST. HEDDA
FIRE ZONE NO. OF PLANS TYPE GROUP
BLDG. SETBACK LINE ORD. NO.
APPROVED BY DATE
USE ZONE A1 APPROVED BY DATE

CORRECTIONS

APPROVALS

FOUNDATION: LOCATION, FORMS, MATERIALS	INSPECTOR <i>EPC</i>	DATE 7-25-46
FRAME: FIRE STOPS, BRACING, BOLTS	<i>EPC</i>	4/28/47
LATH, INT.:	<i>EPC</i>	5/2/47
LATH, EXT.:		
PLASTER, INT.		
PLASTER, EXT.	<i>EPC</i>	9/16/47
FINAL		

ORIGINAL

PLUMBING 1

NATURE OF INSTALLATION				DISTRICT NO.	GROUP	ZONE	PERMIT NO.
ROUGH		FIXTURES		4	I	-	34421
HEATER		CESSPOOL		RECEIVED BY	READY FOR FIRST INSPECTION		DATE ISSUED
GAS		MISCELLANEOUS		EPCL			1/8/47
			COMPLETE				
			SEPTIC TANK				

APPLICANT FILL IN HEAVILY OUTLINED PORTION ONLY

PLUMBER	NAME	BENEDICT & BENEDICT	JOB ADDRESS	6026 OLIVA AVE
	ADDRESS	1433 E. COLORADO ST.	LOCALITY	NO. LONG BEACH
	CITY	PASADENA, CALIF.	NEAREST CROSS ST.	
	COUNTY CERT. NO.	2361009 AT 258	EXPIRES	12-31-46

LOCATION OF SEPTIC TANK, OR CESSPOOL

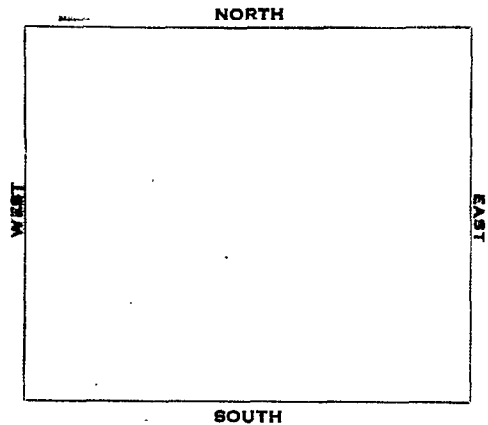

DESCRIPTION OF WORK

<input checked="" type="checkbox"/> BATH TUB	<input checked="" type="checkbox"/> FURNACE
<input checked="" type="checkbox"/> SHOWER	<input type="checkbox"/> DISHWASHER
<input checked="" type="checkbox"/> LAVATORY	<input type="checkbox"/> REFRIGERATOR
<input checked="" type="checkbox"/> KITCHEN SINK	<input type="checkbox"/> WATER SOFTENER
<input type="checkbox"/> FLOOR SINK	<input type="checkbox"/> SAND TRAP
<input type="checkbox"/> SLOP SINK	<input type="checkbox"/> FLOOR DRAIN
<input checked="" type="checkbox"/> WASH TRAY	<input type="checkbox"/> URINAL
<input checked="" type="checkbox"/> WATER CLOSET	<input type="checkbox"/> DRINKING FOUNTAIN
<input checked="" type="checkbox"/> WATER HEATER	<input type="checkbox"/> DENTAL LAVATORY
<input checked="" type="checkbox"/> METER <input checked="" type="checkbox"/> GAS OUTL	<input type="checkbox"/> SODA FOUNTAIN

8	TOTAL NUMBER OF FIXTURES		
	CESSPOOL		SEPTIC TANK

TOTAL FEE \$ 4/50

OWNER	NAME	WestMayfair Co
	MAIL ADDRESS	
	CITY	650 N. Sepulveda
	TEL. NO.	2-4129

I AM THE LEGAL POSSESSOR OF THE ABOVE LOS ANGELES COUNTY CERTIFICATE OF QUALIFICATION
a. R. Benedict
 PLUMBER

I AM THE LEGAL OWNER OF THE PROPERTY DESCRIBED ABOVE.

 OWNER

CORRECTIONS

APPROVALS

	DATE	INSPECTOR'S NAME
ROUGH PLUMBING	2/12/47	EPCL
GAS PIPING		
GAS VENT		
CESSPOOL		
SEPTIC TANK		
SEWER		
UTILITY CO. NOTIFIED	9/16/47	EPCL
FINAL		

ORIGINAL

CITY OF LAKEWOOD

1

APPLICATION FOR BUILDING PERMIT

COUNTY OF LOS ANGELES
 DEPARTMENT OF COUNTY ENGINEER
 PLANNING AND SAFETY DIVISION

JOHN A. LAMBIE, COUNTY ENGINEER
 COLEMAN W. JENKINS, Supt. OF BUILDING

FOR APPLICANT TO FILL IN

BUILDING ADDRESS		6026 OLIVA	
LOT NO.	151-	BLOCK	
TRACT		12673	
SIZE OF LOT	50x100	NO. OF BLDGS. NOW ON LOT	2
USE OF EXISTING BLDG.	REAR PORCH		
OWNER	GREED	TEL. NO.	
ADDRESS	SAME		
CITY			
ARCHITECT OR ENGINEER		TEL. NO.	
ADDRESS			
CONTRACTOR		TEL. NO.	
ADDRESS		LIC. NO.	
CITY		LIC. CLASS	
DESCRIPTION OF WORK			
NEW	<input checked="" type="checkbox"/> ADD	ALTER	REPAIR
DEMOLISH			
SQ. FT. SIZE	4640	NO. OF STORIES	NO. OF FAMILIES
USE OF STRUCTURE	OPEN, ROOFED PATIO + GARDEN		
SIGNATURE OF APPLICANT	Dorothy Greed		
VALUATION \$	600 ⁰⁰		

BUILDING ADDRESS				6026 OLIVA			
LOCALITY				LAKEWOOD			
NEAREST CROSS ST.				HEDDA			
DISTRICT NO.	GROUP	TYPE	PROCESSED BY				
4.01	I	CONST. V					
STATISTICAL CLASSIFICATION				SEWER MAP			
CLASS NO. 2 DWELL UNITS				BK EPG. 67			
USE ZONE	MAP NO.	SPECIAL CONDITIONS					
R-1	3005						
BLDG. SETBACK FROM FRONT PROP. LINE OF				20 - SAME (STREET)			
TYPE OF HIGHWAY	EXISTING WIDTH	SETBACK FROM C.L.	HIGHWAY + YARD =	TOTAL			
			+	=			
BLDG. SETBACK FROM SIDE PROP. LINE OF				(STREET)			
TYPE OF HIGHWAY	EXISTING WIDTH	SETBACK FROM C.L.	HIGHWAY + YARD =	TOTAL			
			+	=			
CORNER CUTOFF				YES	<input type="checkbox"/>	NO	<input type="checkbox"/>

SEE REVERSE SIDE FOR SPECIAL APPROVALS

11/2/66 Establish proof of existing under front of property
 JWS

APPROVALS	DATE	INSPECTOR'S SIGNATURE
FOUNDATION, LOCATION FORMS, MATERIALS	11/24/66	[Signature]
FRAME, FIRE STOPS, BRACING BOLTS		
FURNACE; LOCATION GAS VENT. DUCTS		
LATH. INT.		[Signature]
LATH. EXT.		
HOUSE NUMBER CORRECT AND POSTED		
FINAL	11/29/66	[Signature]

P.C. FEE \$		PMT. FEE \$	6.00
-------------	--	-------------	------

I HEREBY ACKNOWLEDGE THAT I HAVE READ THIS APPLICATION AND STATE THAT THE ABOVE IS CORRECT AND AGREE TO COMPLY WITH ALL COUNTY ORDINANCES AND STATE LAWS REGULATING BUILDING CONSTRUCTION. I CERTIFY THAT IN DOING THE WORK AUTHORIZED HEREBY I WILL NOT EMPLOY ANY PERSON IN VIOLATION OF THE LABOR CODE OF THE STATE OF CALIFORNIA RELATING TO WORKMEN'S COMPENSATION INSURANCE.

SIGNATURE OF PERMITTEE: Dorothy Greed
 ADDRESS:

PLAN CHECK VALIDATION CK. M.O. CASH

JOHN F. LEWIS, PRINCIPAL STRUCTURAL ENGINEER
 PERMIT VALIDATION CK. M.O. CASH

LAC 33843 OCT 19 1 B 6.00-8

INSPECTOR COPY

P. 0011

COUNTY OF LOS ANGELES
DEPARTMENT OF COUNTY ENGINEER
BUILDING AND SAFETY DIVISION
JOHN A. LAMBEL COUNTY ENGINEER

DISTRICT No. _____
PERMIT No. _____
DATE 8-24-65

FOOT PLAN

BUILDING NO. 6026 OLIVA LOCALITY LAKEWOOD

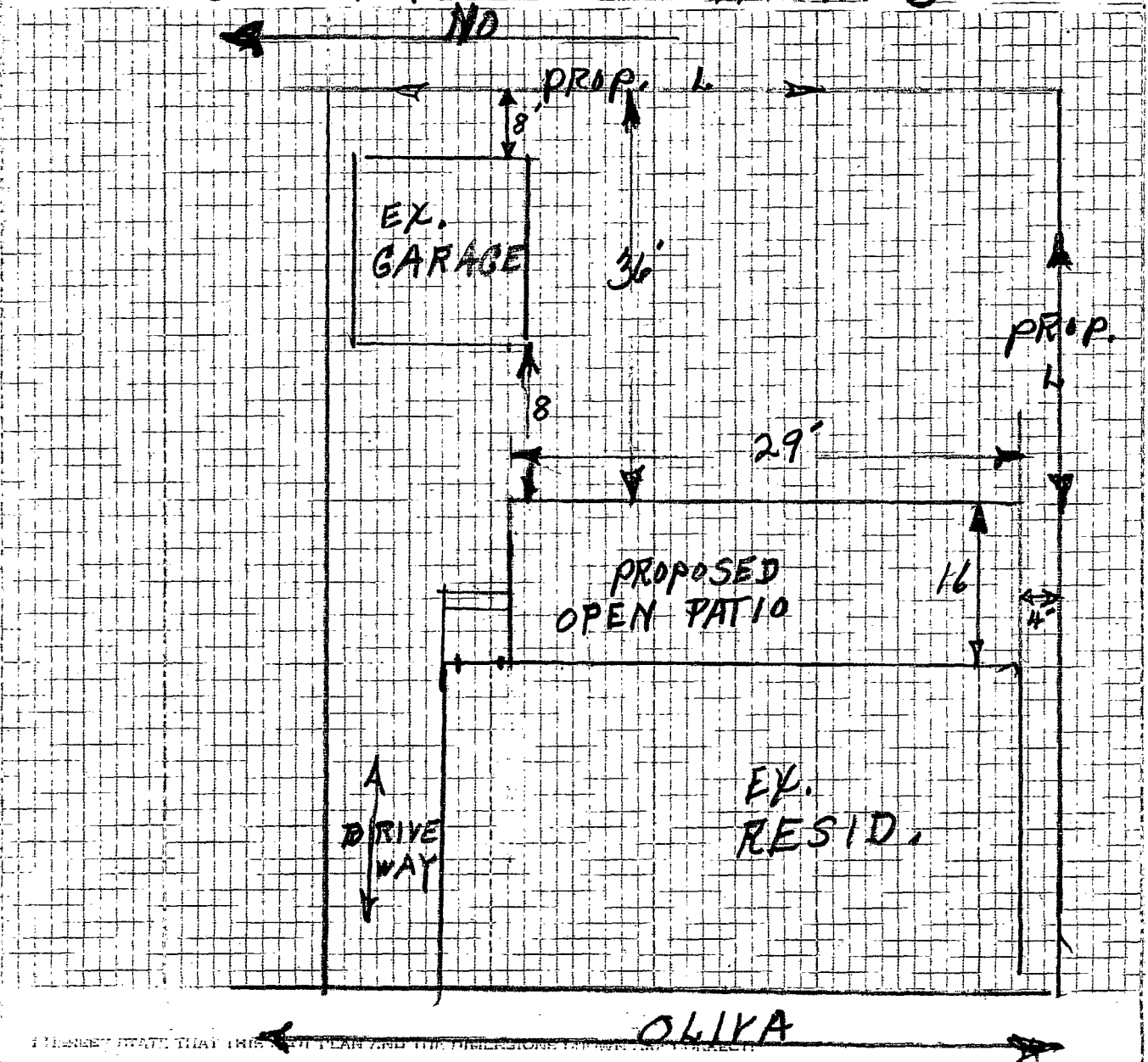

I HEREBY STATE THAT THIS IS THE TRUE AND CORRECT FOOT PLAN AND THE DIMENSIONS THEREOF FOR THE PROJECT.

SIGNATURE OF ARCHITECT _____ DATE _____
ADDRESS _____

CITY OF LAKEWOOD

APPLICATION FOR PERMIT

SEWER SEWAGE DISPOSAL

1

CE808 3-62
76A642D

COUNTY OF LOS ANGELES
DEPARTMENT OF COUNTY ENGINEER
BUILDING AND SAFETY DIVISION
JOHN A. LAMBIE, County Engineer
WILLIAM A. JENSEN, Sup'l of Building

FOR APPLICANT TO FILL IN

LEGAL DESCRIPTION	LOT NO.	99
BLOCK	TRACT	12673
SIZE OF LOT	NO. OF BLDGS. NOW ON LOT	80 x 224 2
USE OF BUILDINGS	Res + Det	
CONTRACTOR	Western Supply Co	
ADDRESS	17444 Ardmore	
CITY	TEL. NO.	
REGISTRATION NO.	STATE COUNTY	
NO.	DESCRIPTION OF WORK	FEE
	HOUSE SEWER CONNECTING TO PUBLIC SEWER	@ \$5.00
	SEPTIC TANK, SEEPAGE PIT OR PITS AND/OR DRAINFIELD	@ \$10.00
	HOUSE SEWER CONNECTING TO PRIVATE DISPOSAL SYSTEM	@ \$3.00
	CONNECT ADDITIONAL BLDG. OR WORK TO HOUSE SEWER	@ \$3.00
	OVERFLOW SEEPAGE PIT, DRAINFIELD EXTN., CESSPOOL, DRYWELL, MANHOLE	@ \$5.00
1	ALTER, REPAIR OR ABANDON HOUSE SEWER OR DISPOSAL SYSTEM	@ \$3.00

BUILDING ADDRESS	6026 Gliva
LOCALITY	Shrub
NEAREST CROSS ST.	
OWNER	Freud
MAIL ADDRESS	
CITY	TEL. NO.

DISTRICT NO.	GROUP	MAP	PG	PROCESSED BY
401	F	BK	PG	

CONNECTION DATA			
STATION	DEPTH		
MANHOLE REFERENCE	UPPER LOWER		
TYPE OF CONNECTION	CURB	P.L.	LENGTH FROM M.L. TO P.L.
CO. IMP. NO.	P.C. NO. JOB NO.		
TRUNK PERMIT NO.	ROAD PERMIT NO.		
AFFIDAVIT	WAIVER	EASEMENT	RECORD. INSTR. NO. DATE
HWY. OR ST. WIDENING			
STATE ENCROACHMENT PERMIT NO.			
INDUSTRIAL WASTE APPROVAL			

OWNER'S AUTHORIZATION	PERMIT	\$	2.00
	TOTAL FEE		5.00

I HAVE AT THIS DATE A CONTRACT WITH THE HEREIN NAMED CONTRACTOR TO CONNECT THE ABOVE DESCRIBED EXISTING DWELLING TO THE PUBLIC SEWER.
SIGNED THIS _____ DAY OF _____ 19____
OWNER OR OWNERS AGENT _____
ADDRESS _____

I HEREBY ACKNOWLEDGE THAT I HAVE READ THIS APPLICATION AND STATE THAT THE ABOVE IS CORRECT AND AGREE TO COMPLY WITH ALL COUNTY ORDINANCES AND STATE LAWS REGULATING PLUMBING AND SEWERS.
I HEREBY CERTIFY THAT I AM PROPERLY REGISTERED AND/OR LICENSED AS REQUIRED BY LOS ANGELES COUNTY AND STATE OF CALIFORNIA OR THAT I AM THE LEGAL OWNER OF AND INTEND TO RESIDE IN, THE ABOVE DESCRIBED RESIDENTIAL PROPERTY.
SIGNATURE OF PERMITTEE *R. A. Wood*

CHARGES	
CONNECTION CHARGE FEE	
REIMBURSEMENT FEE	

APPROVALS	DATE	INSPECTOR'S SIGNATURE
NEW HOUSE SEWER		
CONNECT ADDITIONAL BUILDING OR WORK		
SEPTIC TANK, SEEP. PIT(S) AND/OR DRAINFIELD		
CESSPOOL <input type="checkbox"/> DRYWELL <input type="checkbox"/>		
ALTER, REPAIR, SEWER OR SEWAGE DISPOSAL SYSTEM	10/11/61	<i>Robert A. Wood</i>
DISCONNECT PLUG AND ABANDON HOUSE SEWER		
BACKFILL SEPTIC TANKS <input type="checkbox"/> SEEP. PIT(S) <input type="checkbox"/> CESSPOOLS <input type="checkbox"/>		

VALIDATION **ROBERT A. WOOD**
M. O. CASH SUPERVISING MECHANICAL ENGINEER

LAC 32413 OCT 11 10 5.00

INSPECTOR COPY

CITY OF LAKEWOOD APPLICATION FOR ELECTRICAL PERMIT

1

COUNTY OF LOS ANGELES
DEPARTMENT OF COUNTY ENGINEER
BUILDING AND SAFETY DIVISION
JOHN A. LAMBIE, COUNTY ENGINEER
COLEMAN W. JENKINS, SUPT. OF BUILDING

BUILDING ADDRESS	6626 OLIVA		
LOCALITY	LAKEWOOD		
NEAREST CROSS ST.	HEDDA		
OWNER	FRED		
MAIL ADDRESS	SAME		
CITY	TEL. NO.		
CONTRACTOR	LLOYD		
ADDRESS	TEL. NO.		
CITY	STATE LICENSE NO.		

FOR APPLICANT TO FILL IN

RECEPTACLE	TOTAL OUTLETS	FIRST 20	NO. EACH	EACH	FEE
LIGHT 1	3	3	3	\$.20	60
SWITCH 1		ADD'L OVER 20		.10	
LIGHTING FIXTURES	TOTAL FIXTURES	FIRST 20	1	.20	20
	1	ADD'L OVER 20		.10	
RANGES	CLO. DRYERS	WTR. HTRS.		1.00	
GARB. DISP.	STA. COOK				
DISHWASH.	AUTO.-WASH.				
SPACE HTRS.	STA. APP. (1/2 H.P. MAX.)			.50	
MOTORS:	OVER	NOT OVER	H.P.		
	0	1		1.00	
	1	3		1.50	
	3	8		2.00	
	8	15		2.50	
	15	50		3.00	
	50	100		5.00	
SIGNS:	NO. TRANS.				
	NO. LAMPS				
SERVICE 0-600V-NOT OVER 200A				1.00	
SERVICE 0-600V-OVER 200 A.				2.00	
SERVICE OVER 600V				5.00	
OTHER (SEE COMPLETE FEE SCHEDULE)					
PERMIT ISSUING FEE				2.00	2 00
SUPPLEMENTARY PERMIT ISSUING FEE				1.00	
TOTAL FEE					\$ 2 80

DISTRICT NO.	GROUP	ZONE	PROCESSED BY
401	J	R-1	

INSPECTION RECORD

APPROVALS	DATE	INSPECTOR'S SIGNATURE
UNDERSLAB WORK		
ROUGH CONDUIT		
WIRING		
FIXTURES		
POWER		
UTILITY CO. NOTIFIED	11/19/61	Jones
FINAL		

I HEREBY ACKNOWLEDGE THAT I HAVE READ THIS APPLICATION AND STATE THAT THE ABOVE IS CORRECT AND AGREE TO COMPLY WITH ALL COUNTY ORDINANCES AND STATE LAWS REGULATING ELECTRICAL WIRING.

I HEREBY CERTIFY THAT I AM PROPERLY REGISTERED AND/OR LICENSED AS REQUIRED BY LOS ANGELES COUNTY AND STATE OF CALIFORNIA OR THAT I AM THE LEGAL OWNER OF, AND INTEND TO RESIDE IN, THE ABOVE DESCRIBED RESIDENTIAL PROPERTY.

SIGNATURE OF PERMITTEE *Dorothy Freed*

VALIDATION

JOSEPH C. ROOHAN
SUPERVISING ELECTRICAL ENGINEER

CK MO ~~CASH~~

LAC 33858 OCT 19 2 2.80-5

Pool

INSPECTOR COPY

City of Lakewood
 5050 N. Clark, Lakewood, CA 90712
 (310)866-9771
 PLUMBING PERMIT - 5

Approved by _____

District 4.01
 Permit # 15346 App Dt 05/13/92 Issued 05/13/92 Expires 11/09/92
 Status PR OPEN Res/Com R
 Site 6026 OLIVA AVENUE Lot Size bldgs 1 Occ Group R3
 LAKEWOOD CA 90712 Use Zone LKR1YY
 Parcels 7160002071 Tract 12673 Block Lot 0151
 Owner FREED, MELVIN N&DOROTHY V Lender _____
 Address 6026 OLIVA AVENUE Address _____
 LAKEWOOD CA 90712
 Phone 310-633-4571 Owner Builder? N
 Workers' Comp: _____
 Exempt N Policy 1167992-92 Exp 03/01/93 Co. STATE FUND

Contractor NOCK PLUMBING State Lic. # 511971 Phone _____
 Address 11610 SEABOARD Lic. Type C36 714-895-1246
 STANTON CA 90680 City Lic. # 006106 Exp. _____

PC Name _____
 Address _____
 Phone _____

FIXTURES/ITEMS							
No Code	Description	Each	Fee	No Code	Description	Each	Fee
1	006 DISHWASHER	8.15	8.15				

I certify that I have read this application and state that the information herein is correct. I agree to comply with all city ordinances and State laws relating to building construction, and hereby authorize representatives of this City to enter upon the above-mentioned property for inspection purposes.
 Date 5/13/92 Applicant or Agent Diane Edmondson

FEES AND ADJUSTMENTS			PAYMENTS		INSPECTIONS		
Description	Amount	Date	Amount	Description	Date	Ins	Apr
Fee Subtotal	8.15	05/13/92	22.15	UNDERSLAB			
Issue Fee	14.00			RGH PLBG			
				GAS PIPING			
				GAS VENT			
				WATER HEATER			
				FIXTURES			
				GAS TEST			
				NTFY GAS CO.			
				FINAL			
Total Fees	22.15		TOTAL PD				

Plumbing

City of Lakewood
 5050 N. Clark, Lakewood, CA 90712
 (310)866-9771
 PLUMBING PERMIT - 5

Approved by



District 4.01
 Permit # 21260 App Dt 09/28/93 Issued 09/29/93 Expires 09/29/94

Status PR OPEN Res/Com R

Site 6026 OLIVA AVENUE Lot Size bldgs 1 Occ Group R3
 LAKEWOOD CA 90712 Use Zone LKRIYY
 Parcels 7160002071 Tract 12673 Block Lot 0151

Owner FREED, MELVIN N & DOROTHY V
 Address 6026 OLIVA AVENUE
 LAKEWOOD CA 90712

Lender _____
 Address _____

Phone 310-633-4571 Owner Builder? N

Workers' Comp:

Exempt N Policy 1167992 Exp 03/01/94 Co. STATE FUND

Contractor NOCK PLUMBING
 Address 11610 SEABOARD CR
 STANTON CA 90680

State Lic. # 511971 Phone
 Lic. Type C36 714-895-1246
 City Lic. # 012101 Exp. 06/30/94

PC Name _____
 Address _____
 Phone _____

FIXTURES/ITEMS

No	Code	Description	Each	Fee	No	Code	Description	Each	Fee
1	011	WATER HEATER	8.15	8.15					

I certify that I have read this application and state that the information herein is correct. I agree to comply with all city ordinances and State laws relating to building construction, and hereby authorize representatives of this City to enter upon the above-mentioned property for inspection purposes.

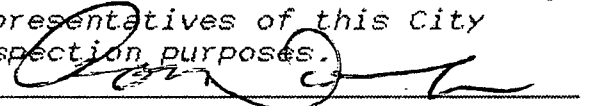
Date 9/29/93 Applicant or Agent 

FEES AND ADJUSTMENTS			PAYMENTS		INSPECTIONS			
Description	Amount	Date	Amount	Description	Date	Ins	Apr	
Fee Subtotal	8.15	09/29/93	22.15	UNDERSLAB				
Issue Fee	14.00			RGH PLBG				
				GAS PIPING				
				GAS VENT				
				WATER HEATER				
				FIXTURES				
				GAS TEST				
				NTFY GAS CO.				
				FINAL				
Total Fees	22.15	TOTAL PD	22.15					

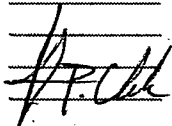
 2294

Plumbing

City of Lakewood
5050 N. Clark, Lakewood, CA 90712
(310)866-9771 ext 2350
BUILDING PERMIT - 1

Approved by

District 4.01
Permit # 24935 App Dt 09/29/94 Issued 09/29/94 Expires 09/29/95
Status PR OPEN Res/Com R
Site 6026 OLIVA AVENUE Lot Size bldgs 1 Occ Group R3
LAKEWOOD CA 90712 Use Zone LKR1YY
Parcels 7160002071 Tract 12673 Block Lot 0099

Owner FREED, MELVIN N&DOROTHY V Lender _____
Address 6026 OLIVA AVENUE Address _____
LAKEWOOD CA 90712

Phone _____ Owner Builder? N
Workers' Comp: _____

Exempt N Policy 1242488 EXP 04/01/95 Co. STATE FUND

Contractor ZIEMAN ROOFING CO. State Lic. # 618199 Phone
Address 14215 BELLFLOWER BLVD Lic. Type C39 310-866-4656
BELLFLOWER CA 90706 City Lic. # 017926 Exp. 06/30/95

PC Name _____ Arc/Eng Name _____
Address _____ Address _____
Phone _____ Phone _____ St reg _____

Map No. 3005 Fire Zone 3 Apt/Condo Sq Ft Size
Sewer Book Pg ST CLASS # 21 # Units # Stories 1
Use Type 1 Const Type School Fee # Families
Permit Type REROOF VALUATION 1,379
Description TEAR OFF EXISTING ROOFING.RE-ROOF HOUSE
of Work AND GARAGE WITH COMP. MINIMUM CLASS C

I certify that I have read this application and state that the information herein is correct. I agree to comply with all city ordinances and State laws relating to building construction, and hereby authorize representatives of this City to enter upon the above-mentioned property for inspection purposes.
Date 9/29/94 Applicant or Agent [Signature]

FEES AND ADJUSTMENTS		PAYMENTS		INSPECTIONS		
Description	Amount	Date	Amount	Description	Date	Ins Apr
Permit Fee	41.00	09/29/94	56.67	FOUNDATION	_____	_____
Issue Fee	14.00			SLAB	_____	_____
STRONG MOTION DETECT	0.50			FRAME	_____	_____
DEVELOPMENT REVIEW B	1.17			ENRGY/INSULAT	_____	_____
				LATH/DRYWALL	_____	_____
				LATH/EXTERIOR	_____	_____
				FINAL	<u>10/17/94</u>	<u>[Signature]</u>
Total Fees	56.67	TOTAL PD	56.67			

Building _____

