

146 S MARTEL AVENUE

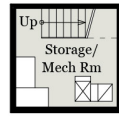

GUEST HOUSE
ABOVE DETACHED GARAGE
510 SQ FT



MAIN RESIDENCE
BASEMENT
105 SQ FT



MAIN RESIDENCE
UPPER LEVEL
1,255 SQ FT

MAIN RESIDENCE
MAIN LEVEL
1,700 SQ FT

ESTIMATED TOTAL FINISHED SQUARE FOOTAGE: 3,465 SQ FT
ABOVE-GRADE: 3,465 SQ FT BELOW-GRADE: N/A
MAIN RESIDENCE: 2,955 SQ FT
GUEST HOUSE: 510 SQ FT

PLUS 395 SQ FT 2-CAR GARAGE
PLUS 30 SQ FT (MAIN FLOOR)
PLUS 105 FT BASEMENT (MAIN RESEIDENCE)

TOTAL FINISHED & UNFINISHED SQUARE FOOTAGE: 3,995 SQ FT
ALL MEASUREMENTS ARE APPROX. CALCULATED PER ANSI STANDARS Z765-2021

BEN KRUGER

310.600.4500 | bkruger@carolwoodre.com

CAROLWOODRE.COM | BENKRUGERLA.COM | BEN KRUGER DRE 01904455

©2026 Carolwood Partners Inc. Broker does not guarantee the accuracy of square footage, lot size, or other information concerning the condition or features of the property obtained from various sources. Equal Housing Opportunity, DRE 02200006

CAROLWOOD
ESTATES

Forbes
GLOBAL PROPERTIES