

# WOOD DESTROYING PESTS AND ORGANISMS INSPECTION REPORT

Building No.	Street	City	Zip	Date of Inspection	Number of Pages
2724	Chestnut Ave	Carlsbad	92010	04/01/2026	1 of 8



## Twin Termite & Pest Control SD, Inc

**380 Vernon Way**

**Suite G, El Cajon, CA 92020**

Tel 619-866-8946 Fax  
Registration #: PR8287

A LICENSED PEST CONTROL OPERATOR IS AN EXPERT IN HIS/HER FIELD. QUESTIONS RELATIVE TO THIS REPORT SHOULD BE REFERRED TO HIM/HER.

**Report #: 17767**

Ordered by: <b>Jefi Moultrie</b> 2724 Chestnut Ave Carlsbad, CA 92010 619-729-4185	Property Owner and Party of Interest: <b>Jefi Moultrie</b>	Report sent to: <b>Jefi Moultrie</b>
--	---	---

COMPLETE REPORT      
 LIMITED REPORT      
 SUPPLEMENTAL REPORT      
 REINSPECTION REPORT

General Description: <b>PROPERTY CONSISTS OF A TWO STORY RESIDENCE WITH STUCCO SIDING</b>	Inspection Tag Posted: <b>GARAGE</b>
	Other Tags Posted:

An inspection has been made of the structure(s) shown on the diagram in accordance with the Structural Pest Control Act. Detached porches, detached steps, detached decks and any other structures not on the diagram were not inspected.

Subterranean Termites    
 Drywood Termites    
 Fungus/Dryrot    
 Other Findings    
 Further Inspection

If any of the above boxes are checked, it indicates that there were visible problems in accessible areas. Read the report for details on checked items.

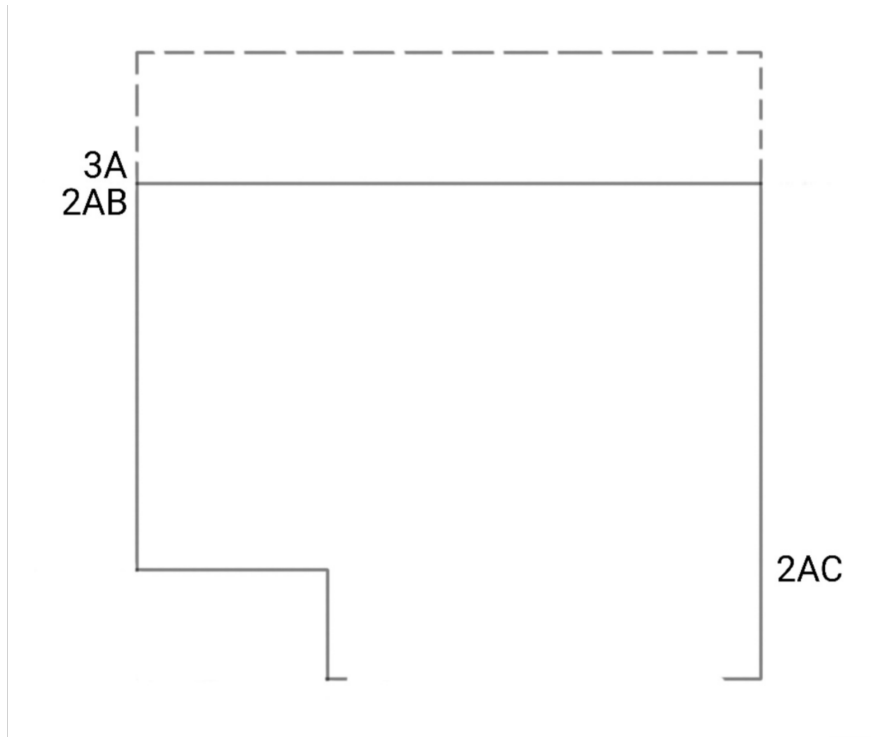

Inspected By: Trevor Klingele      State License No.: FR70250      Signature:

You are entitled to obtain copies of all reports and completion notices on this property reported to the Structural Pest Control Board during the preceding two years. To obtain copies contact: Structural Pest Control Board, 2005 Evergreen Street, Suite 1500, Sacramento, CA 95815

NOTE: Questions or problems concerning the above report should be directed to the manager of the company. Unresolved questions or problems with services performed may be directed to the Structural Pest Control Board at (916) 561-8708, (800) 737-8188 or [www.pestboard.ca.gov](http://www.pestboard.ca.gov).

### **General Comments**

AREAS ABOVE 10 FEET FROM GROUND LEVEL WERE VISUALLY INSPECTED ONLY. TWIN TERMITE ASSUMES NO LIABILITY FOR CONDITIONS NOT VISIBLY EVIDENT FROM GROUND LEVEL.

PORTIONS OF THE ATTIC ARE INACCESSIBLE FOR INSPECTION DUE TO THE PRESENCE OF BLOWN IN INSULATION. NO RECOMMENDATION IS MADE UNLESS OTHERWISE INDICATED IN THIS REPORT. PERIODIC INSPECTIONS ARE ADVISED. TWIN TERMITE AND PEST CONTROL ASSUMES NO LIABILITY FOR CONDITIONS NOT VISIBLE AT THE TIME OF THIS INSPECTION.

THE ATTIC WAS VIEWED FROM THE ACCESS OPENING ONLY, SHOWING NO SIGNS OF ADVERSE CONDITIONS UNLESS OTHERWISE OUTLINED IN THIS REPORT. TWIN TERMITE ASSUMES NO LIABILITY FOR ANY DAMAGE THAT WAS CONCEALED OR NOT VISIBLE AT THE TIME OF THIS INSPECTION

THE SECOND STORY EAVES WERE VISUALLY INSPECTED FROM THE GROUND LEVEL ONLY. TWIN TERMITE AND PEST CONTROL WILL ASSUME NO LIABILITY FOR ANY INACCESSIBLE AREA(S) THAT HAVE NOT BEEN INSPECTED BY OUR COMPANY.

THE EAVE AREAS ABOVE THE PATIO COVER ARE INACCESSIBLE FOR INSPECTION. INTERESTED PARTIES SHOULD BE AWARE THAT TWIN TERMITE AND PEST CONTROL ASSUMES NO RESPONSIBILITY FOR INACCESSIBLE AREAS.

THERE ARE PRIOR REPAIRS VISIBLE AT POST, FASCIA, AND RAFTER TAILS. THIS COMPANY ASSUMES NO LIABILITY FOR WORK PERFORMED AND/OR DAMAGE THAT MAY BE CONCEALED BY OTHERS.

This is a separated report which is defined as Section I/Section II conditions evident on the date of the inspection. Section I contains items where there is visible evidence of active infestation, infection or conditions that have resulted in or from infestation of infection. Section II items are conditions deemed likely to lead to infestation or infection but where no visible evidence of such was found. Further inspection items are defined as recommendations to inspect area(s) which during the original inspection did not allow the inspector access to complete the inspection and cannot be defined as Section I or Section II.

### Description of Findings

## SECTION: I DRYWOOD TERMITES

Finding: 2A

EVIDENCE OF DRY WOOD TERMITE INFESTATION IS VISIBLE AT THE SECOND STORY FASCIA AND MAIN LEVEL FASCIA.

Recommendation:

TARP AND FUMIGATE THE ENTIRE STRUCTURE WITH VIKANE FOR THE ERADICATION OF DRYWOOD TERMITES. GUARANTEE FOR ONE (1) YEAR. THE FUMIGATION PROCESS REQUIRES THAT WORK CREWS WALK ON THE ROOF. MANY ROOFS ARE BRITTLE AND CAN SUFFER SOME DAMAGE WHEN WALKED ON. ATTENTION: TWIN TERMITE AND PEST CONTROL ASSUMES NO RESPONSIBILITY FOR DAMAGE RESULTING FROM WALKING ON THE ROOF, OR FOR DAMAGE TO ANY OF THE FOLLOWING ITEMS: OTHER ROOFING SURFACE; RADIO AND TELEVISION ANTENNAS; PLANTS WHICH ARE CLINGING OR VERY CLOSE TO THE STRUCTURE; AWNINGS; GUTTERS; PATIO COVERS; SOLAR HEATING PANELS; PLUMBING FIXTURES; OR ANY OTHER ITEMS ON OR CONNECTED TO THE ROOF AND/OR SIDE OF STRUCTURE. THE REMOVAL OF ANTENNAS AND/OR PLANTS CLOSE TO THE STRUCTURE WILL BE PERFORMED BY THE OWNER. ATTENTION: TWIN TERMITE AND PEST CONTROL DOES NOT PROVIDE ON-SITE SECURITY AND ASSUMES NO RESPONSIBILITY FOR THE CARE AND CUSTODY OF THE PROPERTY IN THE EVENT OF VANDALISM OR BREAKING AND ENTERING. TWIN TERMITE AND PEST CONTROL RECOMMENDS THAT ALL VALUABLES SUCH AS JEWELRY, COINS, COLLECTION, CASH, ART OBJECTS AND OTHER ITEMS OF VALUE BE REMOVED PRIOR TO FUMIGATION.

Secondary Recommendation:

THE INFESTATION DOES NOT APPEAR TO EXTEND INTO ANY INACCESSIBLE AREAS; THEREFORE, WE RECOMMEND TREATING THE ADJACENT WOOD MEMBERS WITH TERMIDOR (ACTIVE INGREDIENT: FIPRONIL) FOR THE CONTROL OF DRYWOOD TERMITES. IF ADDITIONAL DAMAGE OR INFESTATIONS IS FOUND DURING THE COURSE OF REPAIRS THAT WAS NOT ACCESSIBLE AT THE TIME OF INSPECTION, THE OWNER OR OWNER'S AGENT WILL BE CONTACTED FOR FURTHER DIRECTION. "LOCAL" TREATMENT IS NOT CONSIDERED TO BE AN ALL ENCOMPASSING TREATMENT METHOD. IF INFESTATIONS OF WOOD DESTROYING PEST EXTEND BEYOND THE AREA OF LOCAL TREATMENT, THEY WILL NOT BE EXTERMINATED. THIS IS A ONE YEAR GUARANTEE ON THE ENTIRE STRUCTURE.

Price: \$1035 FOR SECONDARY LOCAL TREATMENT RECOMMENDATION

Finding: 2B

Recommendation:

DRYWOOD TERMITE DAMAGE IS VISIBLE AT SECOND STORY FASCIA. CUT OR SCRAPE DAMAGED PORTION OF WOOD UNTIL SOUND WOOD IS PRESENT & FILL VOIDS WITH A NON CELLULOSE BASED EXTERIOR GRADE WOOD FILLER.

Price: INCLUDED IN 2C



Finding: 2C DRYWOOD TERMITE DAMAGE IS VISIBLE AT FASCIA.  
Recommendation: REMOVE AND/OR SUPPORT ALL DAMAGED PORTIONS OF WOOD AND REPLACE WITH NEW MATERIAL AS NECESSARY.  
Price: \$745.00

## FUNGUS/DRYROT



Finding: 3A THERE IS WOOD DECAY FUNGI (DRY ROT) DAMAGE AT THE POST.

Recommendation: CUT OR SCRAPE DAMAGED PORTION OF WOOD UNTIL SOUND WOOD IS PRESENT & APPLY BORA-CARE, JECTA, OR TIMBOR (ACTIVE INGREDIENT: DISODIUM OCTOBORATE TETRAHYDRATE) TO THE ADJACENT INFECTED AREAS AS NECESSARY FOR THE CONTROL OF WOOD DECAY FUNGI (DRY ROT). FILL VOIDS WITH A NON CELLULOSE BASED EXTERIOR GRADE WOOD FILLER.

Price: INCLUDED IN 2C

---

**Section I Total: \$1,780.00**

---

**Grand Total: \$1,780.00**

## Disclaimer

Thank you for selecting Twin Termite and Pest Control to perform a structural pest control inspection on your property. We look forward to working with you in any repair work or treatments that may be necessary.

For Twin Termite and Pest Control to perform repairs, please see attached work authorization contract. The estimates for repairs includes one (1) coat of primer painting of new exterior wood members (in the event that pre-primed wood is not used), weather permitting. Unless otherwise noted, finish painting is not included in the estimate. No liability can be assumed for damage to personal property/wall hangings on the interior during exterior repairs. Twin Termite does no texturing or wall papering unless otherwise noted in report. New linoleum will be neutral in color. If desired parties want to upgrade the floor covering, there will be an additional charge. If a building permit is required to complete the work contracted, the fees will be added to the final billing invoice. If there are any additional requirements by city or county, the owner or owners agent will be contacted for further direction.

This company will reinspect repairs done by others within four (4) months of the original inspection. A charge can be no greater than the original inspection fee for each reinspection. The reinspection must be done within ten (10) working days of request. The reinspection is a visual inspection and if inspection of concealed areas is desired, inspection of work in progress will be necessary. Any guarantees must be received from parties performing repairs. There will be no guarantee given by Twin Termite on work done by others.

All work performed by Twin Termite and Pest Control is guaranteed for one (1) year with the exception of caulking and sealing which is guaranteed for thirty (30) days, and plumbing which is guaranteed for ninety (90) days, unless otherwise specified in this report.

What is a Wood Destroying Pest & Organism Inspection Report? Read this document. It explains the scope and limitations of a structural pest control inspection and a Wood Destroying Pest & Organism Inspection Report.

A Wood Destroying Pest & Organism Inspection Report contains findings as to the presence or absence of evidence of wood destroying organisms in visible and accessible areas and contains recommendations for correcting any infestations or infections found. The contents of Wood Destroying Pest & Organism Inspection Reports are governed by the Structural Pest Control Act and regulations.

Some structures do not comply with building code requirements or may have structural, plumbing, electrical, mechanical, heating, air conditioning or other defects that do not pertain to wood destroying organisms. A Wood Destroying Pest & Organism Inspection Report does not contain information on such defects, if any, as they are not within the scope of the licenses of either this company, or its employees.

The Structural Pest Control Act requires inspection of only those areas which are visible and accessible at the time of inspection. Some areas of the structure are not accessible to inspection, such as inaccessible and/or insulated attics or portions thereof, attics with less than 18 inches clear crawl space, the interior of hollow walls, spaces between floors, areas concealed by carpeting, appliances, furniture or cabinets. Infestations or infections may be active in these areas without visible and accessible evidence. If you desire information about areas that were not inspected a further inspection may be performed at an additional cost. Carpets, furniture or appliances are not moved and windows are not opened during a routine inspection. This is an inspection from the ground level. Areas above 10 feet were visually inspected only. Twin Termite and Pest Control assumes no liability for any conditions that were not evident from ground level.

The exterior surface of the roof was not inspected. If you want the water tightness of the roof determined, you should contact a roofing contractor who is licensed by the Contractors State License Board. An inspection is performed from the ground level only to visible and accessible areas.

This company does not certify or guarantee against any leakage, such as (but not limited to) plumbing, appliances, walls, doors, windows, any type of seepage, roof or deck coverings. This company renders no guarantee, whatsoever, against any infection, infestation or any other adverse condition which may exist in such areas or may become visibly evident in such area after this date. This company does not water test upper level shower pans due to damage that may occur from such leakage to the ceiling below. Upon request, further inspection of these areas would be performed at an additional charge.

In the event damage or infestation described herein is later found to extend further than anticipated, all work will cease and a supplemental report will be issued. Owner should be aware of this closed bid when contracting with others or undertaking the work himself/herself.

All pesticides and fungicides must be applied by a state certified applicator (Sec.8555 Business and Professions Code Division 3) and in accordance with the manufacturers label requirements.

\*Notice: Reports on this structure prepared by various registered companies should list the same findings (i.e. termite infestations, termite damage, fungus damage, etc.). However, recommendations to correct these findings may vary from company to company. You have a right to seek a second opinion from another company.

The Wood Destroying Pest & Organisms Report does not include mold or any mold like conditions. No reference will be made to mold or mold-like conditions. Mold is not a wood destroying organism and is outside the scope of this report as defined by the Structural Pest Control Act. If you wish your property to be inspected for mold or mold like conditions, please contact a certified industrial hygienist.

There may be health related issues associated with the findings reflected in this report. We are not qualified to and do not render an opinion concerning any such health issues. The inspection reflected by this report was limited to the visible and accessible areas only. Questions concerning health related issues, which may be associated with the findings or recommendations reflected in this report should be directed to a certified industrial hygienist.

Warning: Effective April 22nd, 2010: It is mandatory that any and all persons that perform repairs, renovation or painting must adhere to the new EPA regulation detailed in 40 CFR 745, Subpart E. The regulation is applicable to all residential houses, apartments and child care facilities built prior to 1978. All tradespersons and/or persons working on a property with an intent to sell must supply the owner and/or interested party the designated EPA pamphlet "Renovate Right" lead hazard information pamphlet. The EPA regulation stipulates that if more than 6 square feet of paint on interior surfaces or more than 20 square feet on exterior surfaces are disturbed, or windows or doors are removed and replaced, that the work surfaces are tested by a certified lead inspector. Twin Termite and Pest Control San Diego, Inc. will approach all necessary repairs on structures built prior to 1978 as if they contain lead and will follow all the rules for renovation as outlined in 40 CFR Part 745. Twin Termite and Pest Control San Diego, Inc. has completed an EPA-accredited renovator course and is recognized as a certified EPA renovator. Also effective immediately, homeowners, or representatives of property may not "opt-out" of the work practices as described in 40 CFR 745.

NOTICE: REPORTS ON THIS STRUCTURE PREPARED BY VARIOUS COMPANIES SHOULD LIST THE SAME FINDINGS (i.e. TERMITE INFESTATIONS, TERMITE DAMAGE, FUNGUS DAMAGE, etc.). HOWEVER, RECOMMENDATIONS TO CORRECT THESE FINDINGS MAY VARY FROM COMPANY TO COMPANY. YOU HAVE A RIGHT TO SEEK A SECOND OPINION FROM ANOTHER COMPANY. NOTICE: THE CHARGE FOR SERVICE THAT THIS COMPANY SUBCONTRACTS TO ANOTHER REGISTERED COMPANY MAY INCLUDE THE COMPANY'S CHARGES FOR ARRANGING AND ADMINISTERING SUCH SERVICES THAT ARE IN ADDITION TO THE DIRECT COSTS ASSOCIATED WITH PAYING THE SUBCONTRACTOR. YOU MAY ACCEPT TWIN TERMITE & PEST CONTROL SD, INC'S BID OR YOU MAY CONTRACT DIRECTLY WITH ANOTHER REGISTERED COMPANY LICENSED TO PERFORM THE WORK. IF YOU CHOOSE TO CONTRACT DIRECTLY WITH ANOTHER REGISTERED COMPANY, TWIN TERMITE & PEST CONTROL SD, INC WILL NOT BE RESPONSIBLE FOR ANY ACT OR OMISSION IN THE PERFORMANCE OF WORK THAT YOU DIRECTLY CONTRACT WITH ANOTHER TO PERFORM.

Pesticides are the products Twin Termite & Pest Control SD, Inc uses to control the target pests listed in your agreement. Pesticides make a better life for all by helping control disease carriers and wood destroying insects, thus protecting our health and property. When properly used, pesticides pose no problems to humans or the environment. Your Technician is a State certified applicator whose knowledge is constantly being upgraded through regularly scheduled training sessions. If you have any questions, please call us at: 619-866-8946 or write to: Twin Termite & Pest Control SD, Inc, 380 Vernon Way, Suite G, El Cajon, CA 92020.

**STATE LAW REQUIRES THAT YOU BE GIVEN THE FOLLOWING INFORMATION:  
PESTICIDE NOTICE (SECTION 8538)**

CAUTION: PESTICIDES ARE TOXIC CHEMICALS. Structural Pest Control Companies are registered and regulated by the Structural Pest Control Board, and apply pesticides which are registered and approved for use by the California Department of Pesticide Regulation and the United States Environmental Protection Agency. Registration is granted when the state finds that, based on existing scientific evidence, there are no appreciable risks if proper use conditions are followed or that the risks are outweighed by the benefits. The degree of risk depends upon the degree of exposure, so exposure should be minimized.

If within 24 hours following an application you experience symptoms similar to common seasonal illness, comparable to the flu, eye, skin, or lung irritation, or difficulty with blood clotting, contact Twin Termite & Pest Control SD, Inc, your physician, and/or your Poison Control Center. For the Poison Control Center, contact the following: (1-800-876-4766).

FOR FURTHER INFORMATION: Contact any of the following: Your pest control company is Twin Termite & Pest Control SD, Inc, for Regulatory Information call the Structural Pest Control Board (916-561-8700), or write 2005 Evergreen Street, Suite 1500, Sacramento, CA, 95815-3831. For answers to your health questions, call the County Health Department (see list below) and for application information, contact the County Agriculture Commissioner (see list below):

County	Health Dept.	Ag. Comm.	County	Health Dept.	Ag. Comm.	County	Health Dept.	Ag. Comm.
San Diego County:	(858) 694-3900	(858) 694-2739						

PESTICIDES: 24-3-8 w/Dimension(Dithiopyr),565 Plus XLO(Pyrethrins, PBO, MGK-264),ACE-Jet(Acephate), Advance 375A Select(Abamectin B1), Advance Granular Carpenter Ant Bait(Abamectin B1), Advion Ant Bait Arena(Indoxacarb),Advion Ant Gel(Indoxacarb),Advion Cockroach Bait Arena(Indoxacarb),Advion Cockroach Gel Bait(Indoxacarb), Advion Insect Granular Bait(Indoxacarb),Advion Micro Flow(Indoxacarb), Advion WDG(Indoxacarb),AGRI-FOS(Mono-and di-potassium salts of Phosphorous Acid), Allure MD(Z-9,E-12-Tetradecadien-1-yl acetate), Alpine Dust(Dinotefuran & Diatomaceous Earth), Alpine Flea with IGR(Dinotefuran, Pyriproxyfen, Prallethrin), Alpine P(Dinotefuran), Alpine Pressurized Fly Bait(Dinotefuran), Alpine WSG(Dinotefuran), Altisid Briquets(S-Methoprene), Altiriset(Chlorantr aniliprole), Aprehend(Beauveria bassiana),Arbor-OTC(Oxytetracycline Hydrochloride), Archer(Pyriproxyfen), Arena 0.25G(Clothianidin), Avert DF(Abamectin), Avian Control Repellent(Methyl Anthranilate), Avitrol Whole Corn(4-Aminopyridine),AzaSol(Azadirachtin),Bactimos PT(Bacillus thuringiensis), balEnce(Beauveria bassiana Strain HF23),Bandit(Imidacloprid),Banner Maxx II(Propiconazole), BioampAA(),Bo ra-Care(Disodium Octaborate Tetrahydrate),Capstone(Aminopyralid, Triclopyr), Card-O-Vap 8(Dichlorvos, DDVP),CB-80(Pyrethrins, Piperonyl Butoxide),Chase Granular Mole Gopher Repellent(Castor Oil USP, Sodium Lauryl Sulfate), Chloropricrin(Chloropricrin),Cidetrak IMM((9Z,12E)-9,12-tetradecadien-1-yl acetate), Cidetrak IMM MEC((9Z,12E)-9,12-tetradecadien-1-yl acetate),CimeXa(Amorphous Silica Gel),Conserve SC(spinosad), ContraC All Weather Blox(Bromadiolone), ContraPest(4-Vinylcyclohexene diepoxide, Triptolide), Crossfire(Clothianidin, Metofluthrin, PBO), CrossFire Aerosol(Clothianidin, Metofluthrin, Piperonyl Butoxide),Cy-Kick C & C Pressurized Residual(Cyfluthrin), CyKick CS(Cyfluthrin),DeltaGard(Deltamethrin),Deltagard G(Deltamethrin), Demand CS(Lambda-Cyhalothrin),Detex Blox(N/A),Diacon IGR(Methoprene),Dimension Ultra 40 WP(Dithiopyr), Dismiss CA(Sulfentrazone),Ditrac All Weather Blox (Diphacinone),Ditrac Ground Squirrel Bait(Diphacinone), Doxem Precise(Indoxacarb),Dragnet SFR(Permethrin),Drain Gel(Bacteria (Bacillus Spores)), Drione(Pyrethrins, Piperonyl Butoxide Technical, Amorphous Silica Gel),Drive XLR8(dimethylamine salt of quinclorac), Esplanade 200 SC(Indaziflam), Esplanade EZ(Indaziflam, Diquat) Dibromide, Glyphosate, Isopropylamine Salt ), Essentria G(Eugenol, Thyme Oil),Essentria IC Pro(Sodium Lauryl Sulfate, Geraniol, Clove Oil, Corment Oil), Essentria IC3(Rosemary Oil, Geraniol, Peppermint Oil),Essentria Wasp & Hornet(Peppermint oil, Sodium lauryl sulfate),Evergreen(Pyrethrins),Exciter(Pyrethrins, Piperonyl Butoxide),Fastrac All Weather Blox(Bromethalin), Fastrac Soft Bait(Bromethalin),Fendona CS(alpha-Cypermethrin), Fendona CS II(alpha-Cypermethrin), FirstStrike(difethialone), Flatline( Chlorophacinone),Foam Fighter(Dimethyl silicone fluid emulsion),Fuse(Fipronil, Imidacloprid),Fusilade II(Fluazifop-P butyl),Gallery 75 DF(Isoxaben), Garlon 4 Ultra(Triclopyr),Gentrol Aerosol(Hydroprene),Gentrol IGR Concentrate(Hydroprene), Gentrol Point Source(Hydroprene),Headway G(Azoxystrobin),Heritage(Azoxystrobin),IGI Carbon Dioxide(Carbon Dioxide),IMA-Jet(Imidacloprid),Impel Rods (Anhydrous Disodium Octaborate),In2Mix(Pyriproxyfen, Beauveria bassiana strain GHA),In Vade bio foam(foaming agents, citrus oil and waste-digesting bacillus bacteria), InVite liquid lure(Food grade materials),Kaput Ground Squirrel(Diphacinone, Imidacloprid),Kaput- D(Diphacinone),Kaput-D Ground Squirrel(Diphacinone, Imidacloprid),Lescro Hort Oil(Mineral Oil), Lescro Three-Way(MCPA, Triclopyr, Dicamba),Lifeline(Glufosinate-ammonium),Liqua-Tox II(Sodium Salt of Diphacinone),Magnify(Ammonium Salts, Alkyl polyglycoside + Dimethylpolysiloxane), Maintain CF 125(Methyl Ester Chloreflurenol, Flurecol-Methyl, Methyl-2,7-dichloro-9-hydroxyfluorene-9- carboxylate), Maxforce FC Roach Bait Stations(Fipronil),Maxforce FC Ant Stations(Fipronil),Maxforce FC Select(Fipronil),Maxforce Fleet Ant Gel(Fipronil),Maxforce Fly Spot Bait(Imidacloprid),Maxforce Granular Fly Bait (Imidacloprid),Maxforce Impact(Clothianidin),MaxForce Quantum(Imidacloprid),Merit 75 WSP(Imidacloprid),Microcare 3% CS(Pyrethrins, Piperonyl Butoxide, Technical),Milestone Speciality(aminopyralid),Mole Scram(Castor Oil, Citronella Oil, Garlic Oil),Mother Earth Scatter Bait(Boric Acid),Natular DT(Spinosad),Niban(Orthoboric Acid), No Foam A(Nonylphenoxy polyethoxy ethanols, Isopropanol and Fatty acids),No Foam B(Octyl phenoxy polyethoxy ethanolsopropanol, Linear alkyl sulfonate, IBuffering acids, Coconut amine, condensate, Silicone defoamer),NU-FILM- P(Poly - 1 -p-Menthene), Nuvan ProStrips+(DDVP),NyGuard(Pyriproxyfen),Odoban RTU(Alkyl (C12-16) dimethyl benzyl ammonium chloride), OneGuard(Lambda-cyhalothrin, Prallethrin, Pyriproxyfen, Piperonyl butoxide), Onslaught(Esfenvalerate, Prallethrin, Piperonyl butoxide), Onslaught FastCap(Esfenvalerate, Prallethrin, PBO),Optigard Ant Gel Bait(Thiamethoxam(1)),Optigard Roach Bait(Emamectin benzoate),Optimate(Gamma Cyhalothrin),OvoControl P(Nicarbazin),P.C.Q. Pro(Diphacinone), Patrol(Lambda-Cyhalothrin),PBO-8(Technical Piperonyl Butoxide), PENTRA-BARK(Polyalkylene Modified Heptamethyltrisiloxane and nonionic surfactants), Permethrin SFR(Permethrin),Perm-X UL 30/30(Permethrin, Piperonyl Butoxide), Petcor 2(Etofenprox, (S)-Methoprene, Piperonyl Butoxide), Phantom II PI(Chlorfenapyr),Phantom SC(Chlorfenapyr), PHOSPHO-Jet(Mono-and di-potassium salts of Phosphorous Acid),Precor 2625(Etofenprox, Tetramethrin,Pyrethrins,PBO, S-Methoprene), Precor IGR Concentrate(Methoprene),Premise 75(Imidacloprid),Premise Foam(Imidacloprid),Premise Pro(Imidacloprid), Pro Foam Platinum(Sulfates Disodium Lauroampho Diacetate), Proflex(Lambda-cyhalothrin, Novaluron, Pyriproxyfen), Progress(Ethofumesate),Propizol(Propiconazole.),Purge III(Pyrethrins), QuikStrike(Dinotefuran),QuikStrike Fly Bait Spray(Dinotefuran),Rat-Out Gel(Garlic Oil, White pepper), RatX(Corn Gluten Meal, Sodium Chloride, Citric Acid, Pubescent Whole Egg Solids, Soybean Oil),Rodent Bait Diphacinone .01% (Diphacinone),RoundUp Custom(GLYPHOSATE, ISOPROPYLAMINE SALT), Rozol Ground Squirrel(Chlorophacinone),Rozol Pocket Gopher Bait(Chlorophacinone-Liphadione),Rozol Vole Bait(Chlorophacinone), Safari 20 SG(Dinotefuran), Sedgehammer(Halosulfuron-methyl),Selontra(Chole calciferol),SFM-75(Sulfometuron Methyl), Sluggo(Iron Phosphate), Sluggo Leaf Life(Iron Phosphate), Snapshot(Trifluraline, isoxaben & isomers), SpeedZone Southern(Carfenazone-ethyl, 2,4-D, 2-ethylhexyl ester, MCPP, Dicamba),SpeedZone Southern EW(2,4-D, Dichloro-pro-p, Dicamba, Carfenazone-ethyl), Sumari(Clothianidin, Pyriproxyfen), Sumari Ant Bait(Chlothianidin), Sumilarv(Pyriproxyfen), SureGuard SC(Flumioxazin), Suspend PolyZone(Deltamethrin), Suspend SC(Deltamethrin), Takedown II(Bromethalin), Talpirid(Bromethalin),TAP Insulation(Boric Acid), Taurus SC(Fipronil),Tekko 10(Novaluron), Tekko Pro(Novaluron, Pyriproxyfen ),Tempo SC Ultra(Beta-Cyfluthrin), Terad3 Ag Blox(Cholecalciferol), Terad3 Blox(Cholecalciferol), Termidor Foam(Fipronil), Termidor HE(Fipronil), Termidor SC(Fipronil), Terro Ant Liquid Bait Station(Sodium Tetraborate Decahydrate), Thermolock InCide(Othorboric Acid), Timbor(Disodium Octaborate Tetrahydrate), TREE-age G4(Emamectin Benzoate), Treeage R-10(Emamectin Benzoate), Trelona(Novaluron),ULD BP 100 II(Pyrethrin, PBO),ULD BP 300 II(Pyrethrins, PBO), Vikane(Sulfuryl Fluoride), Vital Oxide(Chlorine Dioxide, Alkyl dimethyl benzyl ammonium chloride, Alkyl dimethyl ethylbenzyl ammonium chloride), Wasp Freeze II(Pallethrin), WHY Trap(Heptyl Butyrate, 2-Methyl-1-butanol, Acetic Acid), Wilco Ground Squirrel Ag(Diphacinone), Wilco Ground Squirrel Bait(Diphacinone), Zenprox EC(Etofenprox),Zythor(Sulfuryl Fluoride).Twin Termite & Pest Control SD, Incwill not apply any compound not authorized for use in California.

If within 24 hours following application you experience symptoms similar to common seasonal illness comparable to the flu, contact your physician or poison control center (800) 222-1222 and your pest control company immediately.

Under the California Mechanics Lien Law any structural pest control company which contracts to do work for you, any contractor, laborer, supplier or other person who helps to improve your property, but is not paid for his or her work or supplies, has a right to enforce a claim against your property. This means that after a court hearing your property could be sold by a court officer and the proceeds of the sale used to satisfy the indebtedness. This can happen even if you have paid your structural pest control company in full if the subcontractor, laborers or suppliers remain unpaid.

To preserve their right to file a claim or lien against your property, certain claimants such as subcontractors or material suppliers are required to provide you with a document entitled "Preliminary Notice". Prime contractors and laborers for wages do not have to provide this notice. A Preliminary Notice is not a lien against your property. It's purpose is to notify you of persons who may have a right to file a lien against your property if they are not paid.

**Twin Termite & Pest Control SD, Inc, License Number PR8287**