

Namkoong Residence
28633 Farrier Dr, Santa Clarita, CA 91354

Solar

Quantity: 39 Panels

System Size: 12.285 kW

Est. Annual Production: 20321.12 kWh

Equipment Location

Your solar inverter(s) and any additional equipment will be installed near your utility electric meter.

At the beginning of installation, the Tesla crew lead will discuss with you the exact location based on your preference and install feasibility.

Front Of House





SolarEdge Single Phase Inverters

for North America

SE3000H-US / SE3800H-US / SE5000H-US / SE6000H-US / SE7600H-US / SE10000H-US / SE11400H-US



INVERTERS

Optimized installation with HD-Wave technology

- Specifically designed to work with power optimizers
- Record-breaking efficiency
- Fixed voltage inverter for longer strings
- Integrated arc fault protection and rapid shutdown for NEC 2014 and 2017, per article 690.11 and 690.12
- UL1741 SA certified, for CPUC Rule 21 grid compliance
- Extremely small
- High reliability without any electrolytic capacitors
- Built-in module-level monitoring
- Outdoor and indoor installation
- Optional: Revenue grade data, ANSI C12.20 Class 0.5 (0.5% accuracy)
- Simple configuration and commissioning with smartphone app and built in Wi-Fi (SE10000H-US, SE11400H-US)



Single Phase Inverters for North America

SE3000H-US / SE3800H-US / SE5000H-US / SE6000H-US / SE7600H-US / SE10000H-US / SE11400H-US

	SE3000H-US	SE3800H-US	SE5000H-US	SE6000H-US	SE7600H-US	SE10000H-US	SE11400H-US		
OUTPUT									
Rated AC Power Output	3000	3800 @240V 3300 @208V	5000	6000	7600	10000	11400	VA	
Max. AC Power Output	3000	3800 @240V 3300 @208V	5000	6000	7600	10000	11400	VA	
AC Output Voltage Min.-Nom.-Max. (183 - 208 - 229)	-	✓	✓	-	-	-	-	Vac	
AC Output Voltage Min.-Nom.-Max. (211 - 240 - 264)	✓	✓	✓	✓	✓	✓	✓	Vac	
AC Frequency (Nominal)	59.3 - 60 - 60.5 ⁽¹⁾							Hz	
Maximum Continuous Output Current 208V	-	16	24	-	-	-	-	A	
Maximum Continuous Output Current 240V	12.5	16	21	25	32	42	47.5	A	
GFDI Threshold	1							A	
Utility Monitoring, Islanding Protection, Country Configurable Thresholds	Yes								
INPUT									
Maximum DC Power	4650	5900	7750	9300	11800	15500	17670	W	
Transformer-less, Ungrounded Maximum Input Voltage	Yes							Vdc	
Nominal DC Input Voltage	380							400	Vdc
Maximum Input Current 208V	-	9	13.5	-	-	-	-	Adc	
Maximum Input Current 240V	8.5	10.5	13.5	16.5	20	27	30.5	Adc	
Max. Input Short Circuit Current	45							Adc	
Reverse-Polarity Protection	Yes								
Ground-Fault Isolation Detection	600k Ω Sensitivity								
Maximum Inverter Efficiency	99						99.2	%	
CEC Weighted Efficiency	99							%	
Nighttime Power Consumption	< 2.5							W	
ADDITIONAL FEATURES									
Supported Communication	RS485, Ethernet, ZigBee (optional), Cellular (optional)								
Interfaces	Revenue Grade Data, ANSI C12.20							Optional ⁽²⁾	
Rapid Shutdown - NEC 2014 and 2017 690.12	Automatic Rapid Shutdown upon AC Grid Disconnect								
STANDARD COMPLIANCE									
Safety	UL1741, UL1741 SA, UL1699B, CSA C22.2, Canadian AFCI according to T.I.L. M-07								
Grid Connection Standards	IEEE1547, Rule 21, Rule 14 (HI)								
Emissions	FCC Part 15 Class B								
INSTALLATION SPECIFICATIONS									
AC Output Conduit Size / AWG Range	3/4" minimum / 20-4 AWG								
DC Input Conduit Size / # of Strings / AWG Range	3/4" minimum / 1-2 strings / 14-6 AWG					3/4" minimum / 1-3 strings / 14-6 AWG			
Dimensions with Safety Switch (HxWxD)	17.7 x 14.6 x 6.8 / 450 x 370 x 174					21.3 x 14.6 x 7.7 / 540 x 370 x 195	21.3 x 14.6 x 7.3 / 540 x 370 x 185	in / mm	
Weight with Safety Switch	22 / 10	25.1 / 11.4	26.2 / 11.9	38.8 / 17.6	40.1 / 18.2			lb / kg	
Noise	< 25							< 50	dB(A)
Cooling	Natural Convection				Natural convection and internal fan (user replaceable)				
Operating Temperature Range	-13 to +140 / -25 to +60 ⁽⁴⁾ (-40°F / -40°C option) ⁽⁵⁾							°F / °C	
Protection Rating	NEMA 3R (Inverter with Safety Switch)								

⁽¹⁾ For other regional settings please contact SolarEdge support
⁽²⁾ Revenue grade inverter P/N: SExxxxH-US000NCC2
⁽³⁾ For power de-rating information refer to: <https://www.solaredge.com/sites/default/files/se-temperature-derating-note-na.pdf>
⁽⁴⁾ -40 version P/N: SExxxxH-US000NNU4



SC-B2 SERIES MODULE

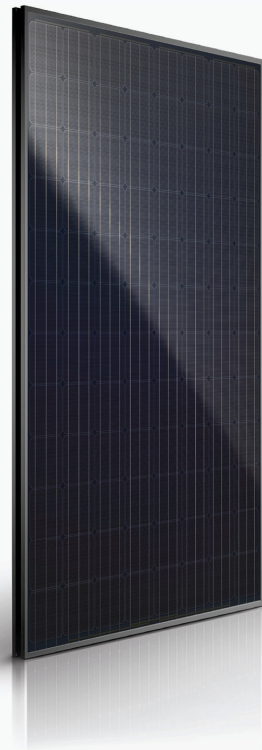

SC315B2 AND SC310B2 BLACK MODULE

Zep Compatible 96-Cell Black-on-Black PV Module
For use in residential and commercial PV installations

MORE POWER PER MODULE

Our 315W module generates 16% more power than a standard 270 W module.

MORE ENERGY EVERY YEAR

More yearly energy (kWh) compared to other modules as they perform better in the heat.

MORE LAYERS, MORE POWER

Manufactured by Panasonic for SolarCity, the module uses Heterojunction cell technology, which adds a layer of thin film silicon on top of high efficiency crystalline silicon.

OUTSTANDING DURABILITY

With more than 20 additional tests performed beyond what is currently mandated, these modules far exceed industry standards.

LEADING WARRANTY

Our modules rank among the best in warranty coverage, with workmanship that extends to 15 years.

MORE POWER, FEWER MODULES

With a sunlight to electricity conversion efficiency of over 18.8%, the module ranks amongst the highest in the industry. That means our modules can harvest more energy from the sun, which means it takes fewer of our modules to power your home. Plus, they generate more power output during the hottest times of the day, even in warmer climates.



LIMITED WARRANTY	Power Output	10 years (90% of P _{MIN}) 25 years (80% of P _{MIN})
	Workmanship	15 years
MATERIALS	Cell Material	5 inch photovoltaic cells
	Glass Material	AR coated tempered glass
	Frame Materials	Black anodized aluminum

CAUTION Please read the installation manual carefully before using the product.

Modules are manufactured by Panasonic to the specification of SolarCity. Modules are only warranted by Panasonic if the modules are included in a PV system sold by SolarCity or Tesla. SolarCity and Tesla make no warranties related to the modules, which are sold as-is. SolarCity will handle any warranty claims on behalf of any purchaser.

MODULE SPECIFICATIONS

ELECTRICAL CHARACTERISTICS

Model	SC315B2	SC310B2
Max Power (W)	315	310
Max Power Voltage, V _{MP} (V)	58.4	58.1
Max Power Current, I _{MP} (A)	5.40	5.34
Open Circuit Voltage, V _{OC} (V)	70.2	69.9
Short Circuit Current, I _{SC} (A)	5.83	5.78
System Voltage (V)	600	600
Max Series Fuse Rating (A)	15	15
Solar Module Efficiency (%)	18.8	18.5
Power Tolerance (%)	+5 / -0	+5 / -0

TEMPERATURE CORRECTION

NOCT (°C)	49
P _{MAX} (%/°C)	-0.29
V _{OC} (%/°C)	-0.25
I _{SC} (%/°C)	0.03

Electrical characteristics are within -5/+10% of the indicated values of I_{SC}, V_{OC}, and P_{MAX} under standard test conditions (irradiance of 100 mW/cm, AM 1.5 spectrum, and a cell temperature of 25 degrees Celsius or 77 degrees Fahrenheit).

AT NOCT (NORMAL OPERATING CONDITIONS)

Model	SC315B2	SC310B2
Max Power (W)	234.6	230.7
Max Power Voltage, V _{MP} (V)	53.6	53.3
Max Power Current, I _{MP} (A)	4.37	4.33
Open Circuit Voltage, V _{OC} (V)	65.7	65.4
Short Circuit Current, I _{SC} (A)	4.70	4.66

AT LOW IRRADIANCE (20%)

Model	SC315B2	SC310B2
Max Power (W)	59.7	58.6
Max Power Voltage, V _{MP} (V)	55.7	55.2
Max Power Current, I _{MP} (A)	1.07	1.06
Open Circuit Voltage, V _{OC} (V)	65.4	65.0
Short Circuit Current, I _{SC} (A)	1.17	1.16

MECHANICAL DATA

Weight	19.5kg (42.99 lbs)
Dimensions	1590 mm (62.60") / 1053 mm (41.46") / 40 mm (1.57")
Connector	MC4
Frame Color	Black
Wind and Snow Load	2400 Pa (50 lbs/ft ²)
Fire Type	UL 1703 Type 2

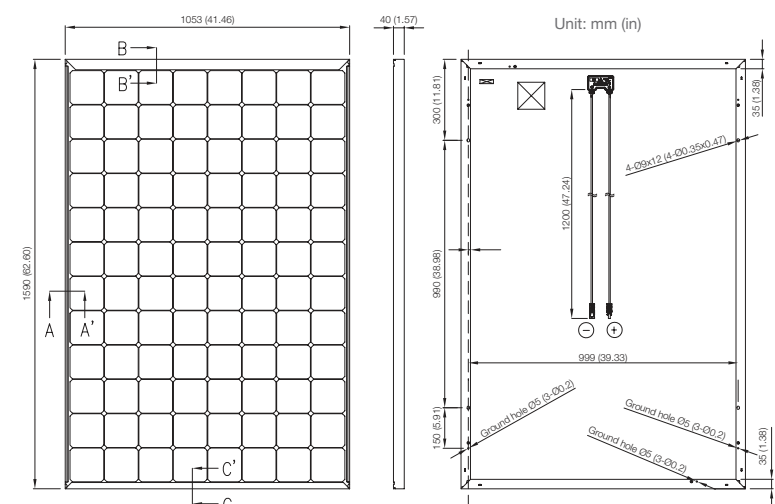
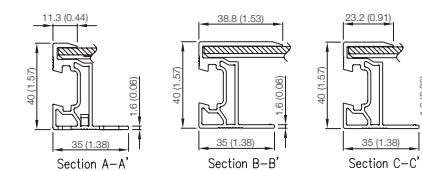

Electronic Record and Signature Disclosure



Certificate Of Completion

Envelope Id: 5E4D60AEDC2B411AB4DC2535A9C78DB6

Status: Completed

Subject: Tesla 20190806_11270754_Customer-Layout

Start Date:

Primary Applicant:

Source Envelope:

Document Pages: 6

Signatures: 0

Envelope Originator:

Certificate Pages: 4

Initials: 0

Tesla E-Sign

AutoNav: Enabled

3500 Deer Creek Road

Envelopeld Stamping: Enabled

Palo Alto, CA 94304

Time Zone: (UTC-08:00) Pacific Time (US & Canada)

esignapi@tesla.com

IP Address: 209.133.79.5

Record Tracking

Status: Original

Holder: Tesla E-Sign

Location: DocuSign

8/6/2019 1:56:51 PM

esignapi@tesla.com

Signer Events

Signature

Timestamp

In Person Signer Events

Signature

Timestamp

Editor Delivery Events

Status

Timestamp

Agent Delivery Events

Status

Timestamp

Intermediary Delivery Events

Status

Timestamp

Certified Delivery Events

Status

Timestamp

Jacob Namkoong

wan2rang@gmail.com

Security Level:

secure.solarcity.com.None

ID: 3cece0cf-07ae-4e05-b480-3e5ae760ec84

8/29/2019 4:43:53 PM

Using IP Address: 76.170.96.71

Viewed using mobile

Sent: 8/6/2019 1:56:52 PM

Viewed: 8/29/2019 11:44:04 PM

Electronic Record and Signature Disclosure:

Accepted: 8/29/2019 11:44:04 PM

ID: 534ccc2f-e511-4871-8513-7fd1678b84c1

Carbon Copy Events

Status

Timestamp

Witness Events

Signature

Timestamp

Notary Events

Signature

Timestamp

Envelope Summary Events

Status

Timestamps

Envelope Sent

Hashed/Encrypted

8/6/2019 1:56:52 PM

Certified Delivered

Security Checked

8/29/2019 11:44:04 PM

Completed

Security Checked

8/29/2019 11:44:04 PM

Payment Events

Status

Timestamps

Electronic Record and Signature Disclosure

ELECTRONIC RECORD AND SIGNATURE DISCLOSURE

From time to time, Tesla (we, us or Company) may be required by law to provide to you certain written notices or disclosures. Described below are the terms and conditions for providing to you such notices and disclosures electronically through the DocuSign system. Please read the information below carefully and thoroughly, and if you can access this information electronically to your satisfaction and agree to this Electronic Record and Signature Disclosure (ERSD), please confirm your agreement by selecting the check-box next to 'I agree to use electronic records and signatures' before clicking 'CONTINUE' within the DocuSign system.

Getting paper copies

At any time, you may request from us a paper copy of any record provided or made available electronically to you by us. You will have the ability to download and print documents we send to you through the DocuSign system during and immediately after the signing session and, if you elect to create a DocuSign account, you may access the documents for a limited period of time (usually 30 days) after such documents are first sent to you. After such time, if you wish for us to send you paper copies of any such documents from our office to you, you will be charged a \$0.00 per-page fee. You may request delivery of such paper copies from us by following the procedure described below.

Withdrawing your consent

If you decide to receive notices and disclosures from us electronically, you may at any time change your mind and tell us that thereafter you want to receive required notices and disclosures only in paper format. How you must inform us of your decision to receive future notices and disclosure in paper format and withdraw your consent to receive notices and disclosures electronically is described below.

Consequences of changing your mind

If you elect to receive required notices and disclosures only in paper format, it will slow the speed at which we can complete certain steps in transactions with you and delivering services to you because we will need first to send the required notices or disclosures to you in paper format, and then wait until we receive back from you your acknowledgment of your receipt of such paper notices or disclosures. Further, you will no longer be able to use the DocuSign system to receive required notices and consents electronically from us or to sign electronically documents from us.

All notices and disclosures will be sent to you electronically

Unless you tell us otherwise in accordance with the procedures described herein, we will provide electronically to you through the DocuSign system all required notices, disclosures, authorizations, acknowledgements, and other documents that are required to be provided or made available to you during the course of our relationship with you. To reduce the chance of you inadvertently not receiving any notice or disclosure, we prefer to provide all of the required notices and disclosures to you by the same method and to the same address that you have given us. Thus, you can receive all the disclosures and notices electronically or in paper format through the paper mail delivery system. If you do not agree with this process, please let us know as described below. Please also see the paragraph immediately above that describes the consequences of your electing not to receive delivery of the notices and disclosures electronically from us.

How to contact Tesla:

You may contact us to let us know of your changes as to how we may contact you electronically, to request paper copies of certain information from us, and to withdraw your prior consent to receive notices and disclosures electronically as follows:

To contact us by email send messages to: myproject@tesla.com

To advise Tesla of your new email address

To let us know of a change in your email address where we should send notices and disclosures electronically to you, you must send an email message to us at referralpayments@solarcity.com and in the body of such request you must state: your previous email address, your new email address. We do not require any other information from you to change your email address.

If you created a DocuSign account, you may update it with your new email address through your account preferences.

To request paper copies from Tesla

To request delivery from us of paper copies of the notices and disclosures previously provided by us to you electronically, you must send us an email to myproject@tesla.com and in the body of such request you must state your email address, full name, mailing address, and telephone number. We will bill you for any fees at that time, if any.

To withdraw your consent with Tesla

To inform us that you no longer wish to receive future notices and disclosures in electronic format you may:

- i. decline to sign a document from within your signing session, and on the subsequent page, select the check-box indicating you wish to withdraw your consent, or you may;
- ii. send us an email to myproject@tesla.com and in the body of such request you must state your email, full name, mailing address, and telephone number. We do not need any other information from you to withdraw consent.. The consequences of your withdrawing consent for online documents will be that transactions may take a longer time to process..

Required hardware and software

The minimum system requirements for using the DocuSign system may change over time. The current system requirements are found here: <https://support.docusign.com/guides/signer-guide-signing-system-requirements>.

Acknowledging your access and consent to receive and sign documents electronically

To confirm to us that you can access this information electronically, which will be similar to other electronic notices and disclosures that we will provide to you, please confirm that you have read this ERSD, and (i) that you are able to print on paper or electronically save this ERSD for your future reference and access; or (ii) that you are able to email this ERSD to an email address where you will be able to print on paper or save it for your future reference and access. Further, if you consent to receiving notices and disclosures exclusively in electronic format as described herein, then select the check-box next to ‘I agree to use electronic records and signatures’ before clicking ‘CONTINUE’ within the DocuSign system.

By selecting the check-box next to ‘I agree to use electronic records and signatures’, you confirm that:

- You can access and read this Electronic Record and Signature Disclosure; and
- You can print on paper this Electronic Record and Signature Disclosure, or save or send this Electronic Record and Disclosure to a location where you can print it, for future reference and access; and
- Until or unless you notify Tesla as described above, you consent to receive exclusively through electronic means all notices, disclosures, authorizations, acknowledgements, and other documents that are required to be provided or made available to you by Tesla during the course of your relationship with Tesla.