

LACount...

0 150 300ft

Parcel 8061005012 (View Details)

Description		Scanned Documents		Permit History	
Date App Init	Date Permit Issued	Date Permit Finalized	Work Description	Permit Link	APN
2009/06/11	2009/06/15	2009/08/06	INSTALL SOLAR PANELS TO EXIST SFD 448 SQ FT ON ROOF		806100501
2011/01/06	2011/01/06	2011/05/02	REMODEL 2 BATHROOMS, TILE WORK, PAINTING, DRYWALL.		806100501
2016/06/01			INSTALL ROOF MOUNTED PV SYSTEM 14 PANELS AND 2.4KW		806100501
2009/08/05	2009/08/05	2009/08/06	INSTALL SOLAR PANELS TO EXIST SFD 448 SQ FT ON ROOF		806100501
2011/01/06	2011/01/06	2011/05/02	REMODEL 2 BATHROOMS, TILE WORK, PAINTING, DRYWALL.		806100501
2011/01/06	2011/01/06	2011/05/02	REMODEL 2 BATHROOMS, TILE WORK, PAINTING, DRYWALL.		806100501

Permit Assistant

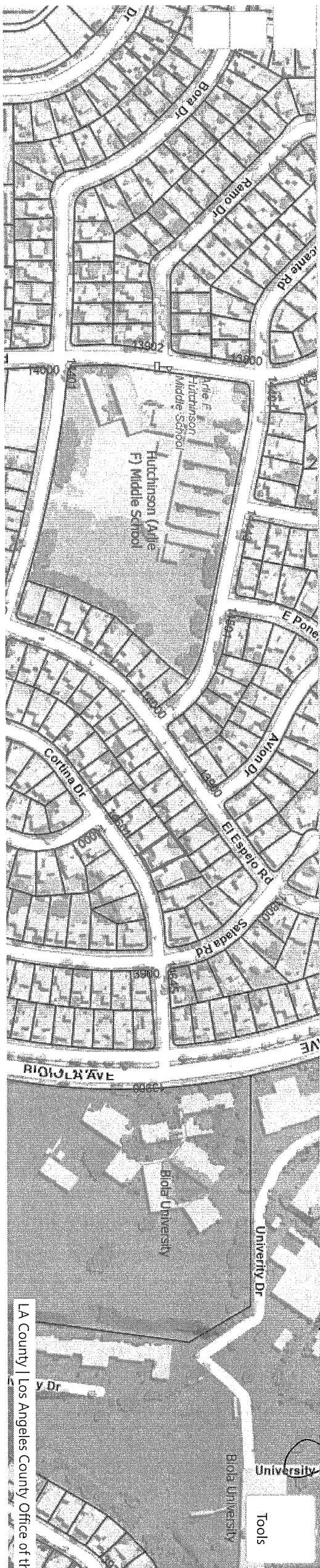

LACount... 

0 150 300ft

Parcel 8061005012 (View Details)

Description	Scanned Documents	Permit History	Permit Address	Permit City	App Status	App Disposition	Date App Init	Date Permit Issued
BL 0906110034 ✓			14617 CORTINA DR	LA MIRADA	Finalized	Normal	2009/06/11	2009/06/15
BL 1101060030 ✓			14617 CORTINA DR	LA MIRADA	Finalized	Normal	2011/01/06	2011/01/06
CB 1606010009 ✓			14617 CORTINA DR	LA MIRADA	Application Issued	Cancelled	2016/06/01	2009/08/05
EL 0908050006 ✓			14617 CORTINA DR	LA MIRADA	Finalized	Normal	2009/08/05	2009/08/05
EL 1101060021 ✓			14617 CORTINA DR	LA MIRADA	Finalized	Normal	2011/01/06	2011/01/06
PL 1101060019 ✓			14617 CORTINA DR	LA MIRADA	Finalized	Normal	2011/01/06	2011/01/06

400 B

76A638A CE #803 5-61

APPLICATION FOR BUILDING PERMIT

COUNTY OF LOS ANGELES
 DEPARTMENT OF COUNTY ENGINEER
 BUILDING AND SAFETY DIVISION
 JOHN A. LAMBE, COUNTY ENGINEER
 WILLIAM A. JENSEN, SUPT. OF BUILDING

FOR APPLICANT TO FILL IN

BUILDING ADDRESS: 14617 Cortina Dr.
 LOT NO.: 499 BLOCK: 15930
 TRACT: 15930 NO. OF BLDGS.: 1
 SIZE OF LOT: 80x126 NOW ON LOT:
 USE OF EXISTING BLDG.:
 OWNER: Fred F. Polly TEL. NO.:
 ADDRESS: 14617 Cortina Dr. TEL. NO.:
 ARCHITECT OR ENGINEER:
 ADDRESS:
 CONTRACTOR: John Neil Clark TEL. X: 82140
 ADDRESS: 1620 Dwyffier Ave. C.M.I.
 DESCRIPTION OF WORK:
 NEW: ADD ALTER REPAIR DEMOLISH
 SO. FT. SIZE: 400 NO. OF STORIES: 1 NO. OF FAMILIES: 1
 USE OF STRUCTURE: BEDROOM
 SIGNATURE OF APPLICANT: William A. Jensen
 VALUATION \$: 4600
 P.C. FEE \$: PMT. FEE \$: 22.25

I HEREBY ACKNOWLEDGE THAT I HAVE READ THIS APPLICATION AND STATE THAT THE ABOVE IS CORRECT AND AGREE TO COMPLY WITH ALL COUNTY ORDINANCES AND STATE LAWS REGULATING BUILDING CONSTRUCTION. I CERTIFY THAT IN DOING THE WORK AUTHORIZED HEREBY I WILL NOT EMPLOY ANY PERSON IN VIOLATION OF THE LABOR CODE OF THE STATE OF CALIFORNIA RELATING TO WORKMENS COMPENSATION INSURANCE.
 SIGNATURE OF PERMITTEE: William A. Jensen
 ADDRESS:

PLAN CHECK VALIDATION

CK. M.O. CASH

BUILDING ADDRESS: 14617 Cortina Dr.
 LOCALITY: City
 NEAREST CROSS ST.:
 DISTRICT NO.: 408 GROUP: F TYPE: D
 STATISTICAL CLASSIFICATION: 0 DWELL. UNITS: 0
 CLASS. NO.: 8 DWELL. UNITS: 0 RECEIVED:
 WATER CERTIFICATE: NOT REQUIRED RECEIVED:
 MAP NO.: 3528 HIGHWAY STATE MAJOR SECOND, LOCAL
 USE ZONE: RA SPECIAL CONDITIONS:
 BUILDING SETBACK: YARD: HWY: STREET NAME: EXIST. WIDTH:
 FRONT P.L.: 20 1/2 Cortina
 SIDE P.L.: 5 1/2
 INSPECTION RECORD

APPROVALS	DATE	INSPECTOR'S SIGNATURE
FOUNDATION: LOCATION FORMS, MATERIALS	1/1/83	
FRAME: FIRE STOPS, BRACING, BOLTS	1/1/83	
FURNACE, LOCATION, GAS VENT, DUCTS	1/1/83	
LATH, INT.	1/1/83	
LATH, EXT.	1/1/83	
HOUSE NUMBER CORRECT AND POSTED	1/1/83	
FINAL	1/1/83	

CLYDE N. DIRLAM, PRINCIPAL STRUCTURAL ENGINEER
 PERMIT VALIDATION

CK. M.O. CASH

MAC 7 4 3 83 APR 4 1 22.00 F

Stearns

14617 COSTINA DR LA MARCA DA

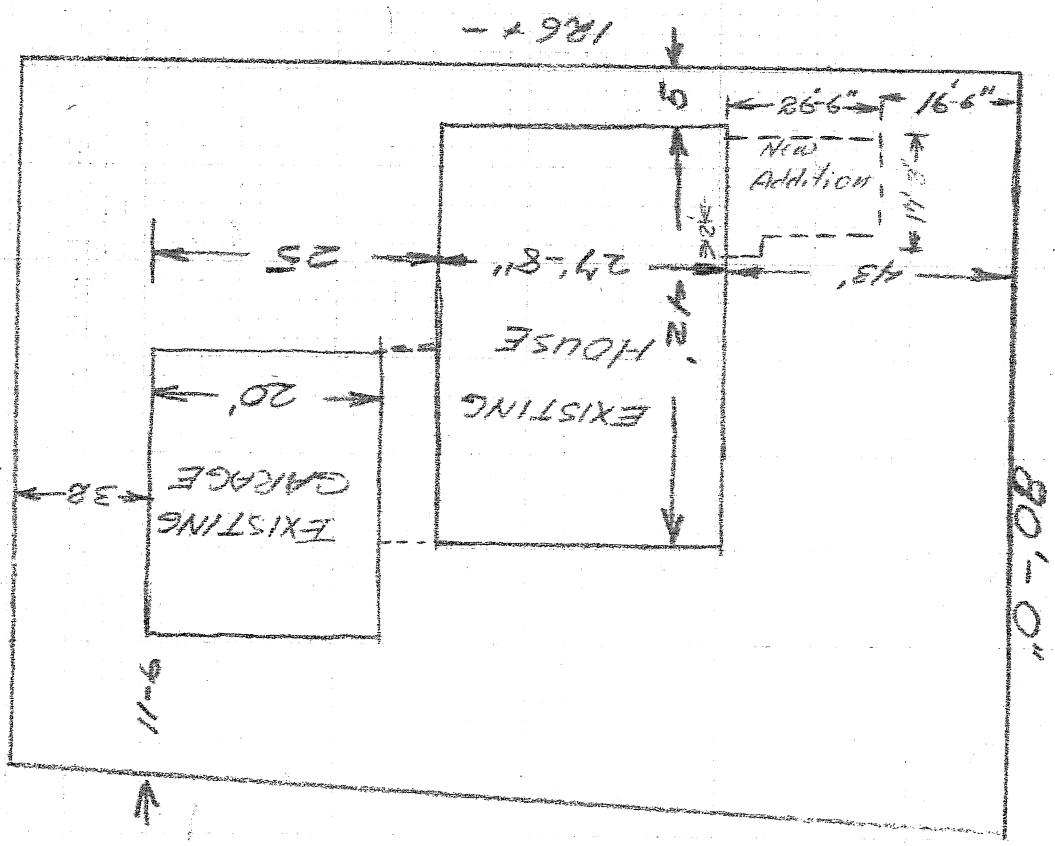

Note - Not to scale.

John M. Bank

1620 Whittier Ave. Calif
COSTA MESA

CITY OF LA MIRADA

APPLICATION FOR PLUMBING PERMIT 1

COUNTY OF LOS ANGELES
 DEPARTMENT OF COUNTY ENGINEERS
 BUILDING AND SAFETY DIVISION
 JOHN A. LAMBE, COUNTY ENGINEER
 WILLIAM A. JENSEN, SUP'T OF BUILDING

NUMBER	FIXTURE OR ITEM	FOR APPLICANT TO FILL IN
1	WATER CLOSET	1-28
	BATH TUB	
1	SHOWER	1-28
1	LAVATORY	1-28
1	SINK	1-28
	DISHWASHER	
	LAUNDRY TUB	
	CLOTHES WASHER	
	WATER HEATER	
	GAS SYSTEM	
4	@ \$1.00 PER ITEM OR FIXTURE	15-
	PERMIT	\$ 2 00
	TOTAL FEE	9 00

I HEREBY ACKNOWLEDGE THAT I HAVE READ THIS APPLICATION AND STATE THAT THE ABOVE IS CORRECT AND AGREE TO COMPLY WITH ALL COUNTY ORDINANCES AND STATE LAWS REGULATING PLUMBING.

I HEREBY CERTIFY THAT I AM PROPERLY REGISTERED AND/OR LICENSED AS REQUIRED BY LOS ANGELES COUNTY AND STATE OF CALIFORNIA OR THAT I AM THE LEGAL OWNER OF THE ABOVE DESCRIBED RESIDENTIAL PROPERTY.

SIGNATURE OF PERMITTEE *Jim Slade*

BUILDING ADDRESS	14617 Corbin
LOCALITY	1.000
NEAREST CROSS ST.	Bora
OWNER	Pacey
MAIL ADDRESS	14617 Corbin
CITY	1.000
CONTRACTOR	Norwalk Plumbing
ADDRESS	11949 Firestone
CITY	Norwalk
CONTRACTOR'S REGISTRATION NO.	17518
DISTRICT NO.	408
GROUP	I
ZONE	R1
PROCESSED BY	<i>W. Kelly</i>
INDUSTRIAL WASTE APPROVAL	
INSPECTION RECORD	
IF THE WORK DONE UNDER THIS HOMEOWNERS PERMIT SHOULD BE DONE BY ANYONE REQUIRED TO HAVE A CITY BUSINESS LICENSE, I HEREBY AGREE TO PAY THE REQUIRED FEES FOR SUCH BUSINESS LICENSES.	
APPROVALS	DATE
UNDER SLAB WORK	4/19/83
ROUGH PLUMBING	4/19/83
GAS PIPING	
GAS VENT	
HOT WATER HEATER	
PLUMBING FIXTURES	
GAS TEST	
UTILITY CO. NOTIFIED	
FINAL	

VALIDATION M.O.

ROBERT A. WOOD
 CASH SUPERVISING MECHANICAL ENGR

L.A.C. 7 5 2 63 APR 19 5 7.00 P

W. Kelly

CITY OF LA MIRADA

COUNTY OF LOS ANGELES
DEPARTMENT OF COUNTY ENGINEER
BUILDING AND SAFETY DIVISION
JOHN A. LAMBE, County Engineer
WILLIAM A. JENSEN, Supt of Building

APPLICATION FOR PERMIT
SEWER SEWAGE DISPOSAL

FOR APPLICANT TO FILL IN

LEGAL DESCRIPTION	LOT NO.	NO. OF BLDGS.
BLOCK	TRACT	NON ON LOT
SIZE OF LOT		
USE OF BUILDINGS		
CONTRACTOR	Name: <i>Roller Plumbing Co</i>	
ADDRESS	1449 Firestone	
CITY	LA MIRADA	TEL. NO. 418-8777
REGISTRATION NO.	175718	STATE COUNTY
NO.	DESCRIPTION OF WORK	FEE
	HOUSE SEWER CONNECTING TO PUBLIC SEWER	@ \$3.00
	SEPTIC TANK SEEPAGE PIT OR PITS AND/OR DRAINFIELD	@ \$3.00
	OVERFLOW SEEPAGE PIT DRAINFIELD EXTN. CESSPOOL, DRYWELL	@ \$2.00
	HOUSE SEWER CONNECTING TO PRIVATE DISPOSAL SYSTEM	@ \$1.00
	CONNECT ADDITIONAL BLDG. OR WORK TO HOUSE SEWER	@ \$3.00
	ALTER, REPAIR OR ABANDON HOUSE SEWER OR DISPOSAL SYSTEM	@ \$1.00
OWNERS AUTHORIZATION		PERMIT \$ 2.00
TOTAL FEE		\$ 5.00

I HAVE AT THIS DATE A CONTRACT WITH THE HEREIN NAMED CONTRACTOR TO CONNECT THE ABOVE DESCRIBED EXISTING DWELLING TO THE PUBLIC SEWER.
SIGNED THIS 18 DAY OF APRIL 1963
OWNER OR OWNERS AGENT *William A. Jensen*

ADDRESS *1449 Firestone*

BUILDING ADDRESS	14617 COATING				
LOCALITY	La Mirada				
NEAREST CROSS ST.	Bears Dr.				
OWNER	Roller				
MAIL ADDRESS	14419 Coating				
CITY	La Mirada				
TEL. NO.	418-4473				
DISTRICT NO.	GROUP	BK	MAP	PG	PROCESSED BY
401	T				W.A. Jensen
STATION	MANHOLE REFERENCE	DEPTH	UPPER	LOWER	
Y.	TYPE OF CONNECTION	P.L.	LENGTH FROM M.L. TO P.L.		
	CURB				
	CO. IMP. NO.	P.C. NO.	JOB NO.		
	TRUNK PERMIT NO.	ROAD PERMIT NO.			
	STATE ENCROACHMENT PERMIT NO.				
	INDUSTRIAL WASTE APPROVAL				
	CONNECTION CHARGE FEE	CHARGES			
	REIMBURSEMENT FEE				
APPROVALS	DATE	INSPECTOR'S SIGNATURE			
NEW HOUSE SEWER					
CONNECT ADDITIONAL BUILDING OR WORK					
SEPTIC TANK, SEEP. PIT(S) AND/OR DRAINFIELD					
CESSPOOL <input type="checkbox"/> DRYWELL <input type="checkbox"/>					
ALTER, REPAIR, SEWER OR SEWAGE DISPOSAL SYSTEM					
DISCONNECT PLUG AND ABANDON HOUSE SEWER					
BACKFILL SEPTIC TANKS <input type="checkbox"/>					
SEEP. PIT(S) <input type="checkbox"/> CESSPOOLS <input type="checkbox"/>					

VALIDATION
ROBERT A. WOOD
SUPERVISING MECHANICAL ENGINEER

IF THE WORK DONE UNDER THIS HOMEOWNERS PERMIT SHOULD BE DONE BY ANYONE REQUIRED TO HAVE A BUSINESS LICENSE, I HEREBY AGREE TO PAY THE REQUIRED FEES FOR SUCH BUSINESS LICENSE(S).

APR 19 1963 5:00 P

499

FOR APPLICANT TO FILL IN

OWNER *Shaw Construction Co*

MAIL ADDRESS _____

CITY _____ TEL. NO. _____

PLUMBER **KENNEDY PIPE & SUPPLY CO.**

ADDRESS **15301 So. Paramount Blvd.**

CITY **MEL. 3-5101 Paramount, Calif.**

TEL. NO. _____

LICENSE NO. **189352 C36-5C20**

NUMBER	TYPE OF FIXTURE OR ITEM	FEE
2	WATER CLOSET (TOILET)	\$
2	BATH TUB	
2	SHOWER	
2	LAVATORY (WASH BASIN)	
2	KITCHEN SINK	
2	DISHWASHER	
1	LAUNDRY TUB OR TRAY	
	CLOTHES WASHER	
8	TOTAL NO.	@ 0.80 <i>6 40</i>
1	GAS SYSTEM	5 OUTLETS @ 1.00 <i>5 00</i>
1	WATER HEATER	@ 1.00 <i>1 00</i>
	PERMIT	\$ 1 00
	TOTAL FEE	<i>9 40</i>

I HEREBY ACKNOWLEDGE THAT I HAVE READ THIS APPLICATION AND STATE THAT THE ABOVE IS CORRECT AND AGREE TO COMPLY WITH ALL COUNTY ORDINANCES AND STATE LAWS REGULATING PLUMBING.

I HEREBY CERTIFY THAT I AM PROPERLY REGISTERED AND/OR LICENSED AS REQUIRED BY LOS ANGELES COUNTY AND STATE OF CALIFORNIA OR THAT I AM THE LEGAL OWNER OF THE ABOVE DESCRIBED RESIDENTIAL PROPERTY AND PERMIT OF THE ABOVE SIGNATURE OF PERMITTEE.

William J. Fox

WILLIAM J. FOX COUNTY ENGINEER *870* VALIDATION

R. A. WOOD, CHIEF PLBG. INSPECTOR

BUILDING ADDRESS *14617 Portline*

LOCALITY *San Mateo*

NEAREST CROSS ST. _____

DISTRICT NO. *4* GROUP *I* ZONE *RA* READY FOR INSPECTION

INDUSTRIAL WASTE APPROVAL _____

INSPECTION RECORD

*William J. Fox
to build*

DESCRIPTION	DATE	INSPECTOR'S SIGNATURE
UNDER SLAB WORK	<i>11 1955</i>	<i>[Signature]</i>
ROUGH PLUMBING		<i>[Signature]</i>
GAS PIPING		
GAS VENT		
HOT WATER HEATER		
PLUMBING FIXTURES		
GAS TEST	<i>1955</i>	<i>[Signature]</i>
UTILITY CO. NOTIFIED		
FINAL		

No. 12548 SEP 6 3 9.40

William J. Fox

APPLICATION FOR BUILDING PERMIT 1

DIVISION OF BUILDING AND SAFETY
 Department of County Engineer
 County of Los Angeles
 WM. J. FOX, COUNTY ENGINEER
 CASSATT D. GRIFFIN, SUP'T. OF BUILDING

FOR APPLICANT TO FILL IN

BUILDING ADDRESS: 14617 Cartesian Dr.
 LOT NO.: 499 BLOCK: _____
 TRACT: 15930
 SIZE OF LOT: 60 X 115 NO. OF BLDGS. NOW ON LOT: None
 USE OF EXISTING BLDG.: _____
 OWNER: Shaw Construction Co.
 MAIL ADDRESS: 14328 Valley View
 CITY: La Brea TEL. NO.: 347917
 ARCHITECT OR ENGINEER: _____ TEL. NO.: _____
 ADDRESS: _____
 CONTRACTOR: Shaw Const. Co. TEL. NO.: 347917
 ADDRESS: 14328 Valley View
 DESCRIPTION OF WORK: Single family residence with attached garage
 NEW ADD ALTER REPAIR DEMOLISH
 SO. FT.: 1155 NO. OF STORIES: 1 NO. OF FAMILIES: 1
 USE OF STRUCTURE: _____
 SIGNATURE OF APPLICANT: [Signature] Plan: 139
 ADDRESS: _____
 VALUATION: \$ 9600.00 P.C. \$ 6.00 FEE \$ 24.00
 I HEREBY ACKNOWLEDGE THAT I HAVE READ THIS APPLICATION AND STATE THAT THE ABOVE IS CORRECT AND AGREE TO COMPLY WITH ALL COUNTY ORDINANCES AND STATE LAWS REGULATING BUILDING CONSTRUCTION.
 SIGNATURE OF PERMITTEE: [Signature]
 ADDRESS: _____

WM. J. FOX, COUNTY ENGINEER
 VALIDATION

BUILDING ADDRESS: 14617 Cartesian Dr.
 LOCALITY: _____
 NEAREST CROSS ST.: _____
 DISTRICT No.: 4 GROUP: I TYPE: V SEWER MAP PG: _____
 MAP NUMBER: 3528 STATE HWY: _____ YES () NO ()
 USE ZONE: RA SPECIAL CONDITIONS: _____
 BUILDING SETBACK: _____ YARD: _____ HWY: _____ STREET NAME: _____ EXIST. WIDTH: _____
 FRONT F.L.: 20 SIDE P.L.: _____

1 DWELL. UNIT	5 INDUSTRIAL
2 DUPLEX UNIT	6 PUBLIC BLDG.
3 APT. UNITS	7 ADDN., ALT., ETC.
4 COMMERCIAL	8 MISCEL.

INSPECTION RECORD

FOUNDATION: LOCATION FORMS, MATERIALS	DATE	INSPECTOR'S SIGNATURE
FRAME: FIRE STOP BRACING, BOLTS	9/19/55	[Signature]
FURNACE: LOCATION, GAS VENT, DUCTS		
LATH. INT.	10/20/55	[Signature]
LATH. EXT.	10/20/55	[Signature]
HOUSE NUMBER CORRECT AND POSTED	10/20/55	[Signature]
FINAL		

VALIDATION

APR 9 9 8 218 AUG 24 1 6 5 00 416 9 9 8 318 AUG 24 1 24.00

BY: [Signature] DEPUTY
 BY: [Signature] DEPUTY

APPLICATION FOR PERMIT SEWER-SEWAGE DISPOSAL

DIVISION OF BUILDING AND SAFETY
Department of County Engineer
County of Los Angeles
WM. J. FOX, COUNTY ENGINEER
CASSATT-D. GRIFFIN, SUP'T. OF BUILDING

FOR APPLICANT TO FILL IN

LEGAL DESCRIPTION LOT NO. 499
 BLOCK TRACT 15930
 SIZE OF LOT 50 x 100 NO. OF BLDGS. 1
 USE OF BUILDINGS Dwell.

CONTRACTOR N. A. Artukovich Const. Co.
 ADDRESS 723 Union St.
 CITY Montebello TEL. NO. _____

REGISTRATION NO. 115917 STATE COUNTY
 NO. DESCRIPTION OF WORK FEE

1	HOUSE SEWER CONNECTING TO PUBLIC SEWER	@ \$ 3.50	3	50
	HOUSE SEWER CONNECTING TO PRIVATE DISPOSAL SYSTEM	1.00		
	CONNECT ADDITIONAL BLDG. OR WORK TO HOUSE SEWER	1.00		
	ALTER OR REPAIR EXISTING SEWER OR DISPOSAL SYSTEM	1.00		
	DISCONNECT AND ABANDON SEWER AND/OR DISPOSAL SYSTEM	1.00		
	SEPTIC TANK, SEEPAGE PIT OR PITS AND/OR DRAINFIELD	2.00		
	CESSPOOL - DRYWELL SPECIAL CONDITIONS ONLY	2.00		

OWNERS	PERMIT \$	1	00
AUTHORIZATION	TOTAL FEE	4	50

I HAVE THIS DATE CONTRACTED WITH THE HEREIN NAMED CONTRACTOR TO CONNECT THE ABOVE DESCRIBED EXISTING DWELLING TO THE PUBLIC SEWER
 SIGNED THIS _____ DAY OF _____ 19__
 OWNER OR AGENT WJF

I HEREBY ACKNOWLEDGE THAT I HAVE READ THIS APPLICATION AND STATE THAT THE ABOVE IS CORRECT AND AGREE TO COMPLY WITH ALL COUNTY ORDINANCES AND STATE LAWS REGULATING PLUMBING AND SEWERS.
 I HEREBY CERTIFY THAT I AM PROPERLY REGISTERED AND/OR LICENSED AS REQUIRED BY LOS ANGELES COUNTY AND STATE OF CALIFORNIA. I AM THE LEGAL OWNER OF THE ABOVE DESCRIBED RESIDENTIAL PROPERTY.

SIGNATURE OF PERMITTEE: W. J. Fox

WILLIAM J. FOX, COUNTY ENGINEER

VALIDATION

BUILDING ADDRESS: 14617 Cortina Dr.
 LOCALITY: La Mirada
 NEAREST CROSS ST.: Salada Rd.
 OWNER: Shaw Const. Co.
 MAIL ADDRESS: 14328 Valley View
 CITY: La Mirada TEL. NO. _____

DISTRICT NO. 4 GROUP SEWER MAP PG. 12-62
 CONNECTION DATA
 STATION 6+87.0 DEPTH 72
 TYPE OF CONNECTION UPPER MANHOLE REFERENCE
 CURB P.L. LENGTH FROM M.L. TO P.L. _____

CO. IMP. NO. _____ JOB NO. PC 2626
 TRUNK PERMIT NO. _____ ROAD PERMIT NO. _____
 STATE ENCROACHMENT PERMIT NO. _____
 INDUSTRIAL WASTE APPROVAL CHARGES _____
 CONNECTION CHARGE FEE _____
 REIMBURSEMENT FEE _____

APPROVALS	DATE	INSPECTOR'S SIGNATURE
NEW HOUSE SEWER	DEC 1 1955	<u>W. J. Fox</u>
CONNECT ADDITIONAL BUILDING OR WORK		
SEPTIC TANK, SEEP, PIT(S) AND/OR DRAINFIELD		
CESSPOOL <input type="checkbox"/> DRYWELL <input type="checkbox"/>		
ALTER, REPAIR, SEWER OR SEWAGE DISPOSAL SYSTEM		
DISCONNECT PLUG AND ABANDON HOUSE SEWER		
BACKFILL SEPTIC TANKS <input type="checkbox"/>		
SEEP, PIT(S) <input type="checkbox"/> CESSPOOLS <input type="checkbox"/>		

BY _____ DEPUTY

BY _____ DEPUTY

BY _____ DEPUTY

BY _____ DEPUTY

COUNTY OF LOS ANGELES
 DEPARTMENT OF PUBLIC WORKS
 BUILDING AND SAFETY / LAND DEVELOPMENT

CITY OF LA MIRADA
 13700 LA MIRADA
 LA MIRADA CA 90638
 PHONE: (562) 943-0131 EXT:

0408
 BUILDING PERMIT
 ALTERATION/REPAIR
 BL 0408 11010600

5/2/11 2 Bathrooms

LEGAL ID: LT: 499

ASSESSOR INFORMATION NUMBER: 8061-005-012

TENANT: SAME AS OWNER

OWNER: POLLEY GERALDINE E
 14617 CORTINA DR
 LMRD 906383715
 TEL. NO: (310) 941-4473-

APPLICANT: AHARON SHAY
 18375 VENTURA #364
 TARZANA 91356
 TEL. NO: (818) 344-8006-

CONTRACTOR: MAGIC HAMMER DEVELOPMENT INC
 18375 VENTURA BLVD SUITE 364
 TARZANA, CA 91356
 TEL. NO: (818) 344-8006-
 L.I.C. NO 877108 B

ARCHITECT OR ENGINEER: TEL. NO: L.I.C. NO:

MAP NO: SEWER MAP BOOK: PAGE: FIRE ZONE: CMP: 3528 3 00

NO. OF FAMILIES: DWELLING UNITS: APT/COND: STAT CLASS: NO NO 21

AIR QUALITY: SCHOOL WITHIN HAZARDOUS MATERIALS NO NO

STRUCTURE: 90 SQ. FT NO. OF STORIES V-B
 CONST TYPE

EXIST BLDG USE: SPR USE ZONE: R-3
 EXIST OCC GRP:

BLDGS. NOW ON LOT: 1 VALUATION: 24,000

FEE DESCRIPTION:	QUANTITY:	UOM:	AMOUNT:
AA BLDG PERMIT ISSUANCE			30.60
AB STATE GREEN BLDG FEE	24000.00	VAL	1.00
AC STRONG MOTION RESID	24000.00	VAL	2.40
D2 PERMIT W/O EN-HC	24000.00	VAL	500.60
TOTAL FEES			534.60

REPORT ID: DPR261 ROUTE TO: BS0408

BUILDING ADDRESS: 14617 CORTINA DR
 LMRD CA 906383715
 NEAREST CROSS STREET: THOMAS PAGE: 737 GRID: F3 LOCALITY: LA MIRADA

ISSUED ON: 01/06/11 PROCESSED BY: JS

FINAL DATE: 5/2/11 FINAL BY: MKR
 CODE:

DESCRIPTION OF WORK: REMODEL 2 BATHROOMS, TILE WORK, PAINTING, DRYWALL.

SPECIAL CONDITIONS:

APPROVALS: DATE INSPECTOR SIGNATURE

LOCATION AND SETBACKS		
SOILS ENGINEER APPROVAL		
FOUNDATION/TRENCH FORMS		
SLAB/UNDER FLOOR		
RAISED FLOOR FRAMING		
UNDERFLOOR INSULATION		
FLOOR SHEATHING		
ROOF SHEATHING		
SHEAR PANELS		
FRAME INSPECTION		
FIRE SPRINKLER HANGERS		
INSULATION/WEATHER STRIP		
INTERIOR LATH/DRYWALL	4/6/11	MSR
EXTERIOR LATH		
RATED FLOOR/CELL ASSEM.		
RATED WALL ASSEMBLIES		
RATED SHAFTS/OPENINGS		
T-BAR CEILINGS		
LOT DRAINAGE		

COUNTY OF LOS ANGELES
 DEPARTMENT OF PUBLIC WORKS
 BUILDING AND SAFETY / LAND DEVELOPMENT

CITY OF LA MIRADA
 13700 LA MIRADA
 LA MIRADA CA 90638
 PHONE: (562) 943-0131 EXT:

0408

PLUMBING PERMIT
 PL 0408 1101060019

LEGAL ID: LT: 499

ASSESSOR INFORMATION NUMBER:
 8061-005-012

TENANT:
 SAME AS OWNER

OWNER:
 POLLEY GERALDINE E
 14617 CORTINA DR
 LMRD 906383715
 TEL. NO: (310) 941-4473-

APPLICANT:
 AHARON SHAY
 18375 VENTURA #364
 TARZANA 91356
 TEL. NO: (818) 344-8006-

CONTRACTOR:
 MAGIC HAMMER DEVELOPMENT INC
 18375 VENTURA BLVD SUITE 364
 TARZANA, CA 91356
 TEL. NO: (818) 344-8006-
 LIC. NO 877108 B

ARCHITECT OR ENGINEER:
 TEL. NO:
 LIC. NO:

*11/13/11 - Rooby's Plumbing
 in Bathroom #1*

FEE DESCRIPTION:	QUANTITY:	UOM:	AMOUNT:
01 PERMIT ISSUANCE FEE			30.60
07 BATHTUBS/SHOWERS	2.00	FIX	35.60
17 FLOOR DRAIN(S)	2.00	FIX	35.60
25 LAVATORIES / SINKS	2.00	FIX	35.60
45 WATER CLOSET/URINAL	2.00	FIX	35.60
63 WATER REPIPE, BR/FTX	4.00	FIX	30.00
TOTAL FEES			203.00

REPORT ID: DPR263

ROUTE TO: BS0408

BUILDING ADDRESS:
 14617 CORTINA DR
 LMRD CA 906383715

NEAREST CROSS STREET:
 THOMAS PAGE: 737 GRID: F3 LOCALITY: LA MIRADA

ISSUED ON: PROCESSED BY: PLAN BY:
 01/06/11 JS

FINAL DATE: 5/2/11
 FINAL BY: M Reyes
 CODE:

DESCRIPTION OF WORK
 REMODEL 2 BATHROOMS, TILE WORK, PAINTING, DRYWALL.

SPECIAL CONDITIONS:

APPROVALS	DATE	INSPECTOR SIGNATURE
UNDER SLAB WORK		
WATER SERVICE		
PLASTIC Y/N METAL Y/N		
ROUGH PLUMBING		
GAS PIPING		
GAS VENT		
HOT WATER HEATER		
PLUMBING FIXTURES		
LAWN SPRINKLERS		
GAS TEST		
UTILITY COMPANY NOTIFIED		
CWV		
GRAY WATER SYSTEM		

COUNTY OF LOS ANGELES
DEPARTMENT OF PUBLIC WORKS
BUILDING AND SAFETY / LAND DEVELOPMENT

CITY OF LA MIRADA
13700 LA MIRADA
LA MIRADA CA 90638
PHONE: (562) 943-0131 EXT:

0408

BUILDING PERMIT
RESIDENTIAL ADD/ALT/REP
BL 0408 0906110034

Solar

LEGAL ID: LT: 499

ASSESSOR INFORMATION NUMBER: 061-005-012

ENANT:

OWNER: TEL. NO: (562) 941-4473-
OLLIEY GERALDINE TOM
4617 CORTINA DR
MRD 906383715

APPLICANT:

STARLIGHT CONSTRUCTION TEL. NO: (562) 927-8045-
PO BOX 40438
DOWNEY CA 90239

CONTRACTOR: TEL. NO: (562) 927-8045-
STARLIGHT CONSTRUCTION LIC. NO
PO BOX 40438 695910 C39 *
DOWNEY CA 90239

ARCHITECT OR ENGINEER:

TEL. NO:
LIC. NO:

MAP NO: SWMER MAP BOOK: PAGE: FIRE ZONE: CMP:
3528 3 00

NO. OF FAMILIES: DWELLING UNITS: APT/COND: STAT CLASS:
NO 21

AIR QUALITY: SCHOOL WITHIN HAZARDOUS
NO 1000 FEET MATERIALS
NO

REQUIRED SET BACK YARD: HWY: TOTAL SETBACK FROM EXIST
FRONT PL- PROP LINE: WIDTH:
SIDE PL-

STRUCTURE: 448 NO. OF STORIES 1 CONST TYPE VN NEW OCCUP GROUP R3
GARAGE: OTHER: USE ZONE:

EXIST BDDG USE: VALUATION: 27,000
EXIST OCC GRP: BDDGS. NOW ON LOT: FEES PAID

FEE DESCRIPTION: QUANTITY: UOM: AMOUNT:

D1 PLANCHCK W/O EN-HC	27000.00	VAL	457.76
AA BLDG PERMIT ISSUANCE	27000.00	VAL	30.02
AA STATE GREEN BLDG FEE	27000.00	VAL	2.00
AB STRONG MOTION RESID	27000.00	VAL	2.70
AC STRONG MOTION RESID	27000.00	VAL	538.55
D2 PERMIT W/O EN-HC	27000.00	VAL	1,031.03
TOTAL FEES			

* ADDITIONAL DATA ON FILE

REPORT ID: DPR261

ROUTE TO: BS0408

BUILDING ADDRESS:
14617 CORTINA DR
LARD CA 906383715
NEAREST CROSS STREET:
THOMAS PAGE: 737 GRID: F3 LOCALITY: LA MIRADA

ISSUED ON: 06/15/09 PROCESSED BY: MY

FINAL DATE: 8/6/09 FINAL BY: *[Signature]* CODE:

DESCRIPTION OF WORK
INSTALL SOLAR PANELS TO EXIST SPD 448 SQ FT ON ROOF

SPECIAL CONDITIONS:

APPROVALS DATE INSPECTOR SIGNATURE

LOCATION AND SETBACKS		
SOILS ENGINEER APPROVAL		
FOUNDATION/TRENCH FORMS		
SLAB/UNDER FLOOR		
RAISED FLOOR FRAMING		
UNDERFLOOR INSULATION		
1ST LEVEL FLOOR SHEATH		
2ND LEVEL FLOOR SHEATH		
ROOF SHEATHING		
FIRE DEPT. FRAME INSPECT		
BLDG DEPT. FRAME INSPECT		
SHEAR PANELS		
INSULATION/WEATHER STRIP		
INTERIOR LATH/DRYWALL		
EXTERIOR LATH		
LOT DRAINAGE		
SMOKE DETECTION DEVICES		
FIRE DEPARTMENT APPROVAL		

OWNER-BUILDER DECLARATION

I hereby affirm under penalty of perjury that I am exempt from the Contractors' State License Law for the reason(s) indicated below by the checkmark(s) I have placed next to the applicable item(s) (Section 7031.5, Business and Professions Code). Any city or county that requires a permit to construct, alter, improve, demolish, or repair any structure, prior to its issuance, also requires the applicant for the permit to file a signed statement that he or she is licensed pursuant to the provisions of the Contractors' State License Law (Chapter 9 (commencing with Section 7000) of Division 3 of the Business and Professions Code) or that he or she is exempt from licensure and the basis for the alleged exemption. Any violation of Section 7031.5 by any applicant for a permit subjects the applicant to a civil penalty of not more than five hundred dollars (\$500).):

I, as owner of the property, or my employees with wages as their sole compensation, will do all of or portions of the work, and the structure is not intended or offered for sale (Section 7044, Business and Professions Code: The Contractors' State License Law does not apply to an owner of property who, through, employees' or personal effort, builds or improves the property, provided that the improvements are not intended or offered for sale. If, however, the building or improvement is sold within one year of completion, the Owner-Builder will have the burden of proving that it was not built or improved for the purpose of sale).

I, as owner of the property, am exclusively contracting with licensed Contractors to construct the project. (Section 7044, Business and Professions Code: The Contractors' State License Law does not apply to an owner of property who builds or improves thereon, and who contracts for the projects with a licensed Contractor pursuant to the Contractors' State License Law).

I am exempt from licensure under the Contractors' State License Law for the following reason:

By my signature below I acknowledge that, except for at least personal residence in which I must have resided for at least one year prior to completion of the improvements covered by this permit, I cannot legally sell a structure that I have built as an owner-builder if it has not been constructed in its entirety by licensed contractors. I understand that a copy of the applicable law, Section 7044 of the Business and Professions Code, is available upon request when this application is submitted or at the following Web site: <http://www.leginfo.ca.gov/calaw.html>.

Date: March 2003

Signature of Property Owner or Authorized Agent

[Signature]

LICENSED CONTRACTOR'S DECLARATION

I hereby affirm under penalty of perjury that I am licensed under provisions of Chapter 9 (commencing with Section 7000) of Division 3 of the Business and Professions Code, and my license is in full force and effect.

License Class B1-C3 License No. 685910

Date March 2003 Contractor Signature *[Signature]*

WORKERS' COMPENSATION DECLARATION

WARNING: FAILURE TO SECURE WORKERS' COMPENSATION COVERAGE IS UNLAWFUL, AND SHALL SUBJECT AN EMPLOYER TO CRIMINAL PENALTIES AND CIVIL FINES UP TO ONE HUNDRED THOUSAND DOLLARS (\$100,000), IN ADDITION TO THE COST OF COMPENSATION, DAMAGES AS PROVIDED FOR IN SECTION 3706 OF THE LABOR CODE, INTEREST, AND ATTORNEY'S FEES.

I hereby affirm under penalty of perjury one of the following declarations:

I have and will maintain a certificate of consent to self-insure for workers' compensation, issued by the Director of Industrial Relations as provided for by Section 3700 of the Labor Code, for the performance of the work for which this permit is issued.

I have and will maintain workers' compensation insurance, as required by Section 3700 of the Labor Code, for the performance of the work for which this permit is issued. My workers' compensation insurance carrier and policy number are: State Ind 185 3134-0000 6-224-2003
 Sandler State Ind 185 3134-0000 6-224-2003
 Name of Agent State Ind 185 3134-0000 6-224-2003 Phone Number

I certify that, in the performance of the work for which this permit is issued, I shall not employ any person in any manner so as to become subject to the workers' compensation laws of the California, and agree that, if I should become subject to the workers' compensation provisions of Section 3700 of the Labor Code, I shall forthwith comply with those provisions

Signature of Applicant _____ Date _____

LOBBYIST ORDINANCE CERTIFICATION

Complete this section for permits in Unincorporated Los Angeles County only. This is to certify that I, as permit applicant, am familiar with the requirements of Los Angeles County Code Chapter 2.160 et seq., (relating to the Los Angeles County Lobbyist Ordinance) and that all persons acting on behalf of myself compiled and will continue to comply therewith through the application process.

Dennis Lee Applicant's Signature
Stevens Applicant Name
Stevens Company Name
 Date _____

JOB ADDRESS	
LOCALITY	

HAZARDOUS MATERIAL DECLARATION

Will the applicant or future building occupant handle a hazardous material or a mixture containing a hazardous material equal to or greater than the amount specified on the hazardous materials information guide?

Yes No

Will the intended use of the building by the applicant or future building occupant require a permit for construction or modification from the South Coast Air Quality Management District (SCAQMD)? See permitting checklist for guidelines.

Yes No

I have read the hazardous materials information guide and the SCAQMD permitting checklist. I understand my requirements under the Los Angeles County Code Title 2, Chapter 220 Sections 220.100 through 220.140 concerning hazardous material reporting and for obtaining a permit from the SCAQMD.

ASBESTOS NOTIFICATION

Notification letter sent to SCAQMD or EPA

I declare that notification of asbestos removal is not applicable to addressed project.

DECLARATION REGARDING CONSTRUCTION LENDING AGENCY

I hereby affirm under penalty of perjury that there is a Construction lending agency for the performance of the work for which this permit is issued (Section 3097, Civil Code).

Lender's Name _____

Lender's Address _____

By my signature below, I certify to each of the following: I am the property owner or authorized to act on the property owner's behalf. I have read this application and the information I have provided is correct. I agree to comply with all applicable city and county ordinances and state laws relating to building construction. I authorize representatives of this county to enter the above-identified property for inspection purposes.

Signature of Property Owner or Authorized Agent
 Date March 2003

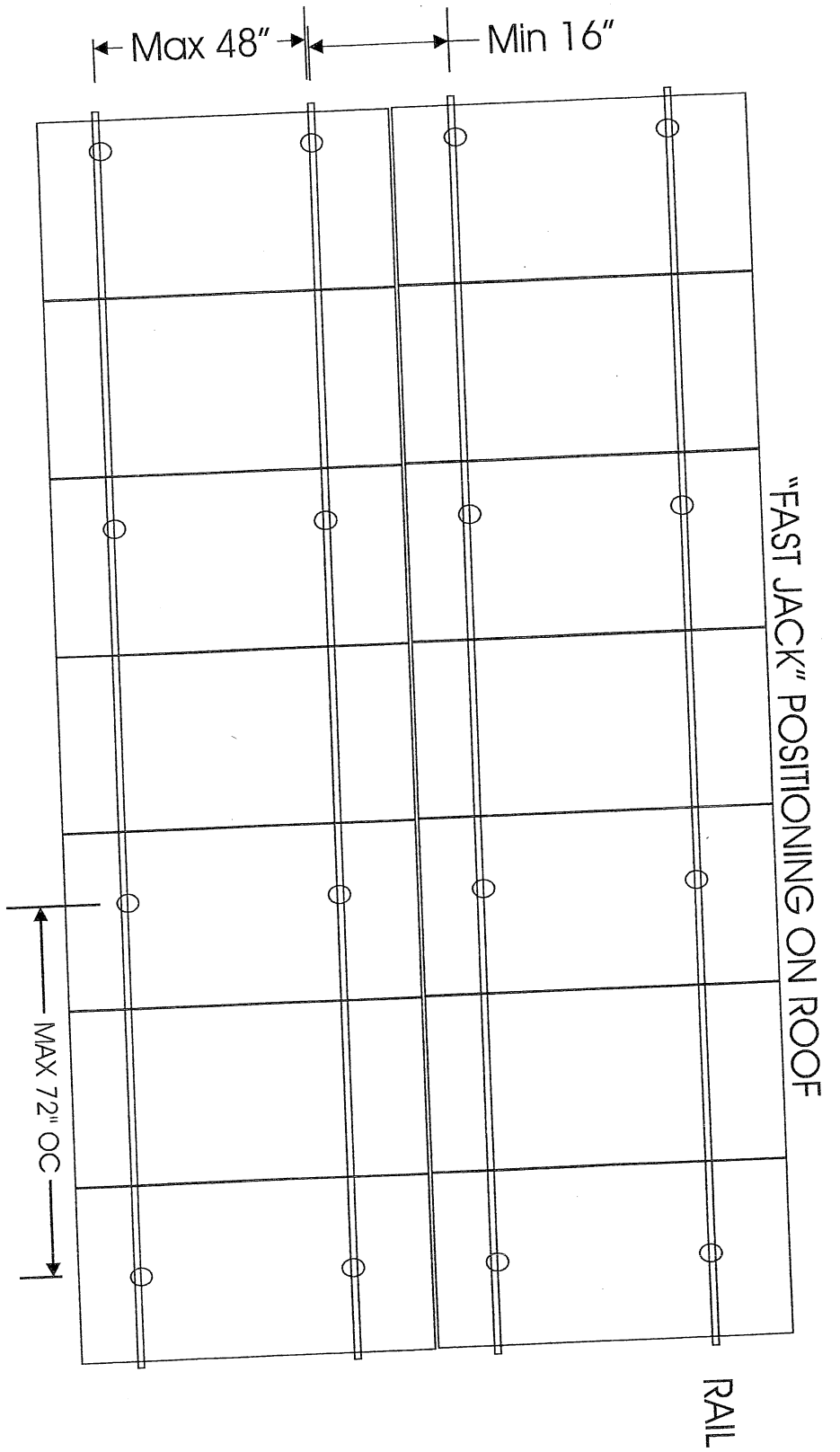

SOLAR PANELS DISPLACEMENT
DETAILS

SOLAR PV PANELS
MID CLAMP FOR
PANEL ATTACHMENT

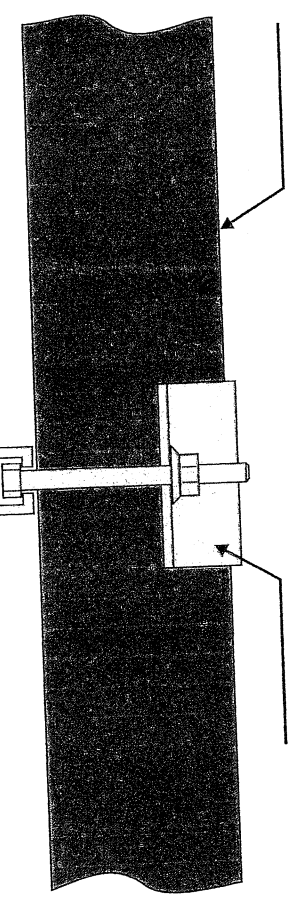

UNIRAC RAIL

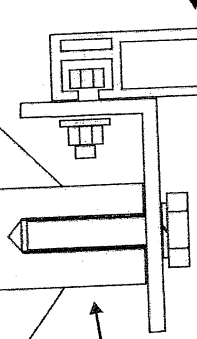

ROOF POST WITH
FAST JACK

ROOF FLASHING

FLAT CONCRETE TILE



2" 1/2 FASTEN
WOOD SCREW

3" 1/2 LAG BOLT

2" X 6" RAFTER

ATTACHMENT SECTION VIEW

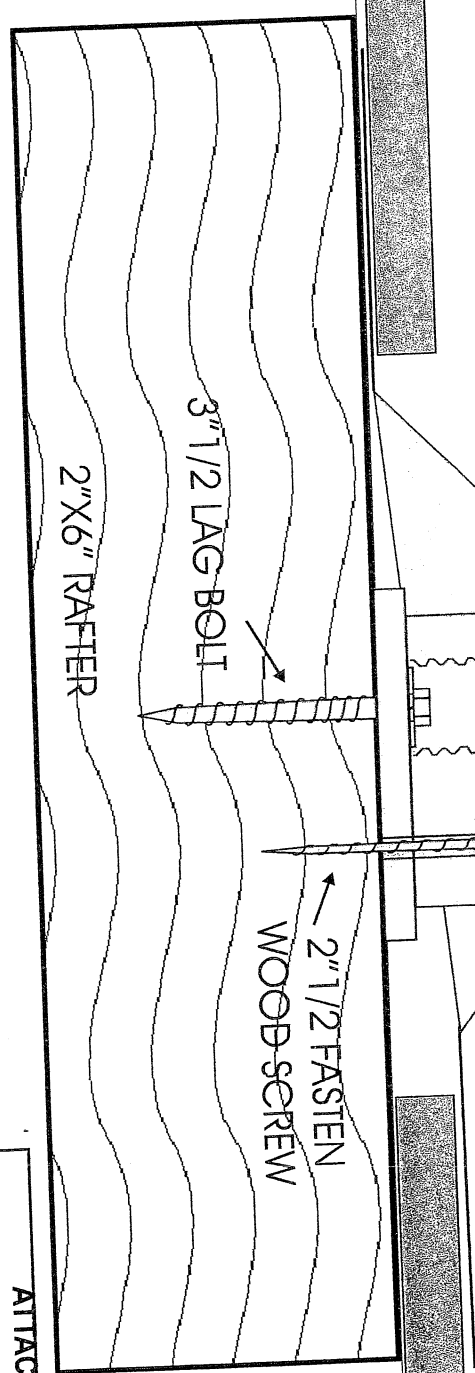

FastJack® — E-Series —

Patent #6,360,491

Flashable Roof Stanchion

The patented design of the FastJack® E-Series is the most efficient and cost-effective product of its kind.

The FastJack® E-series has been laboratory tested to 3,600 pounds of vertical pullout strength using a single Stainless Steel lag bolt (included). Product constructed of only high-quality solid Aluminum and Stainless Steel for corrosion resistance and high strength.

Two Sizes Available

Part# FJE-300-18	3" High
Part# FJE-450-18	4-1/2" High
For low profile installations using Oatey Flashings (for composition shingle roofs)	
For installations using standard flashings (for composition & flat roofs)	

The FastJack® design is covered under Pat. #6,360,491. *Side lateral pull-out of 1,360 lbs.

All FastJack® attachments are sold in heavy duty reclosable boxes which allow for easy storage and handling.

P/N: FJE-300-18 (3") or FJE-450-18 (4-1/2")

Box includes:

- (18) 1" Solid Aluminum Posts
- (18) 1-1/2" Aluminum Bases
- (18) 3/8" x 3/4" SS Bolts
- (18) 3/8" SS Flat Washers
- (18) 5/16" x 3-1/2" SS Lag bolts
- (18) 5/16" SS Flat Washers



FastJack® FJE-450-18
For standard height flashings

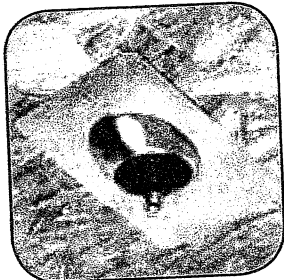

FastJack® FJE-300-18
For Oatey® style flashings

Laboratory Tested
3600 lbs
Vertical Pullout*

Commercial FastJack® E-Series (single lag bolt design) also available.
Tested to 4,050 lbs. See back for details.

Easy installation of flashings on existing roof-tops

See reverse for installation theory

Standard & Oatey® Flashings slip over the the base and under the delicate shingle

The post can
be installed
through the
top of the
flashing

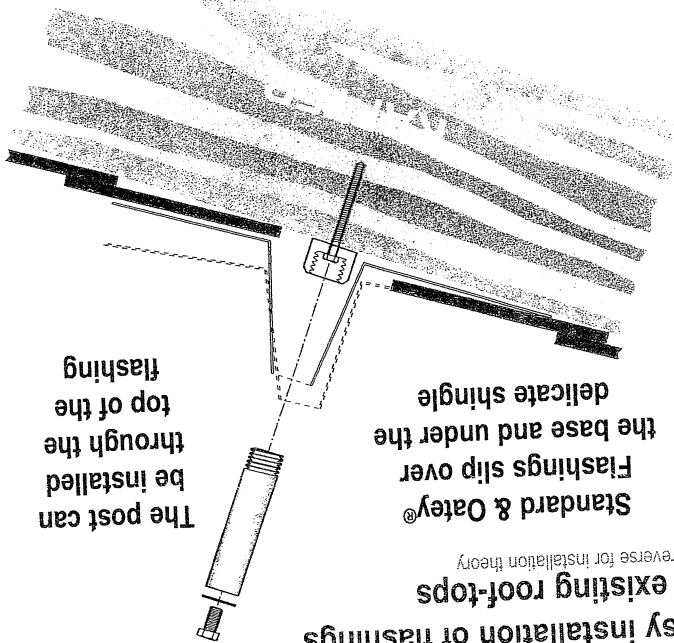

- Removable post makes installation on existing roofs quick and easy as flashing can be installed with no post obstruction (see illustration to the right)
- Patented design locates the lag bolt directly below the stanchion, providing superior strength values
- Precision machined from aluminum, no welds to corrode or break
- Significantly lighter than steel for installer convenience and reduced shipping costs
- Base design works with all standard roof flashings

Email us for
more information

prosolar@prosolar.com

View more info on our
website at:
www.prosolar.com

(805) 486-4700
(805) 486-4799 - fax
1551 S. Rose Ave.
Oxnard, CA 93083

Professional
SOLAR
products, Inc.

USED FOR MOUNTING:
• Photovoltaic Solar Panels
• Solar Thermal Panels
• Communication Equipment
• Virtually anything needing structural attachment to a roof

Proprietary base grooves
grip roof surface to
prevent turning



Accessories

Flashing Template
 Makes cutting in flashing easy and accurate. Available in two sizes for Oatey® (Part# TEMP-OAT) and standard metal flashings (Part# TEMP-STD).

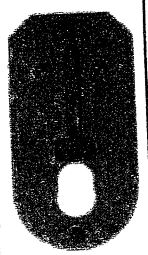

Drill Guide
 Helps ensure proper pilot hole drilling. Includes both drill guides for FJE (3/16") and CFJE (1/4") product lines. (Part# FJ-DRILL)



Clear Flashing
 Low profile, UPC, NES 653 approved. Color: clear. (Part# OAT-SF)

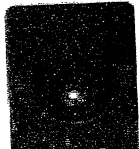
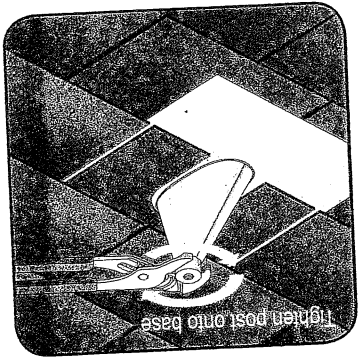
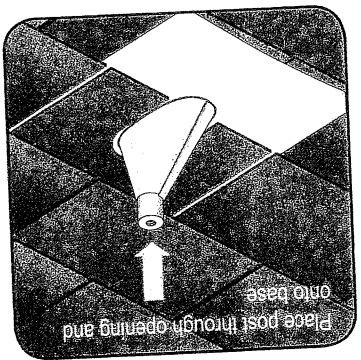
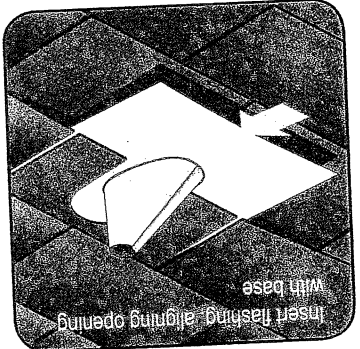
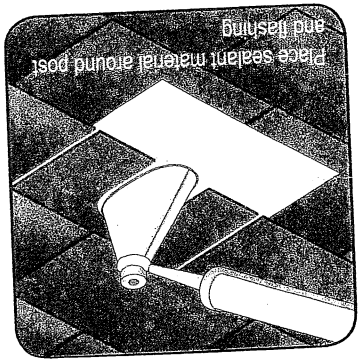

Black Flashing
 Low profile, UPC, NES 653 approved. Color: black. (Part# OAT-SF-B)

Steps 7-9 for standard metal flashings only



Steps 4-6 for Oatey® flashings only

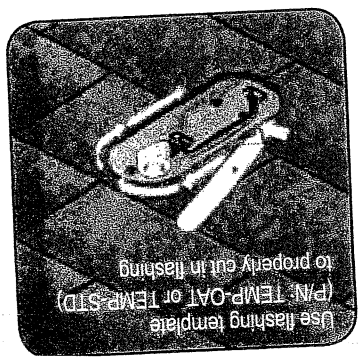
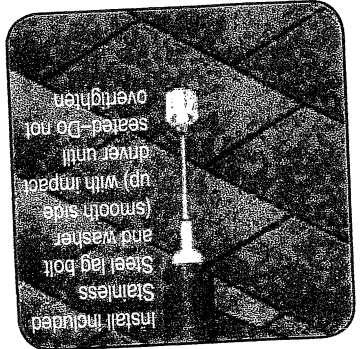

Commercial Fastack® E-series
 Lab tested to 4,050 lbs vertical pullout*
 *Using 3/8" x 4" SS lag bolt (not included), 1.875 side axial pullout

Two Sizes Available

Part# CFJE-400-18 4" High Post top threaded for standard 3/8" bolt, 2" round base, accepts 3/8" lag bolt	Part# CFJE-600-18 6" High Post top threaded for standard 3/8" bolt, 2" round base, accepts 3/8" lag bolt
--	--

Box includes:
 (18) 1-1/4" Solid Aluminum Posts
 (18) 2" Aluminum Bases

