

# Parcel Profile Report

Report date: 2/2/2026 11:23:08 AM



LA COUNTY  
PLANNING

APN: 3307-004-013

Address: VAC/92 STE/VIC AVE E-2 REDMAN CA 93535

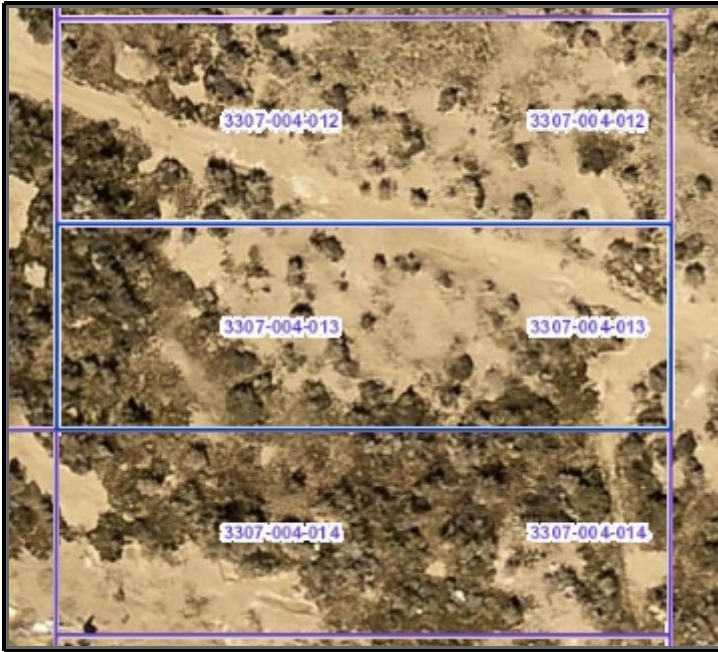

Address: VAC/92 STE/VIC AVE E-2

City: REDMAN CA

Owner:

Mailing Address:

Mailing City:

Lot Size Sq Ft: 7511

Lot Size Acres: 0.17

Legal Description:

TRACT NO 1181 LOT 12 BLK 7

Use Code: 580V

Use Description: Desert

Tax Rate Area: 03435

Transfer Date:

Last Sale Date:

Last Sale Amount:

## Building 1

Design Type:

Bedrooms:

Quality Class Shape:

Baths:

Year Built:

Bldg Sq Ft:

Units:

Effective Yr:

NOTE: The information and materials contained herein are provided as a public service to provide planning and zoning information for the unincorporated areas of Los Angeles County. Parcel information shown on this page is from the Assessor's Office. The County has made every reasonable effort to ensure the accuracy of the information and materials contained within.

APN: 3307-004-013

Address: VAC/92 STE/VIC AVE E-2 REDMAN CA 93535

## General

Census Tract 2010

**TRACT:** 900201

**TOT\_POP:** 1261

City and Community

**City:**

**Type:** AREA

**Name:** ANTELOPE VALLEY

**Jurisdiction:** UNINCORPORATED AREA

Community Standards District

No Results Found

CSD Area Specific Boundary

No Results Found

DRP Field Office Service Area

**Office:** ANTELOPE VALLEY OFFICE

**Office Code:** PBAV

DRP Service Area

**Name:** North Service Area

Equestrian District

No Results Found

Fire Hazards - VHFHSZ Only

No Results Found

Green Zones - 500' Sensitive Use Buffers

No Results Found

Historic Resources

No Results Found

Housing Element (2021 - 2029) - Rezoning

No Results Found

Housing Element (2021 - 2029) - Sites Inventory

No Results Found

Leased Parcel (Marina del Rey)

No Results Found

LUP Community/Area Plan

**Plan:** RL20 - Rural Land 20

**Type:** AREA

**Adopted:** 06-16-15

**Community Name:** Antelope Valley Area

LUP General Plan

No Results Found

Planning Area Standards District (PASD)

No Results Found

Rural Outdoor Lighting District (Dark Skies)

**Name:** RURAL OUTDOOR LIGHTING DISTRICT

Significant Ecological Area (SEA)

**Name:** Antelope Valley

**Type:** Significant Ecological Area

**Implementation:** SEA Ordinance

Significant Ridgeline

No Results Found

Supervisorial District

**Name:** 5TH SUP. DISTRICT

**Supervisor Name:** 5TH DISTRICT:  
KATHRYN BARGER

**District:** 5

Transit Oriented District

No Results Found

Watershed

**Name:** ANTELOPE VALLEY

Zoned District

**Zone District Name:** ANTELOPE

Zoning (Boundary)

**Zone:** A-2-5

**Description:** Heavy Agricultural

**Community Name:** ANTELOPE VALLEY

**Zone Category:** A-2

**Planning Area:** Antelope Valley

Zoning Map Grid

No Results Found

Zoning SP Category

No Results Found

*NOTE: The information and materials contained herein are provided as a public service to provide planning and zoning information for the unincorporated areas of Los Angeles County. Parcel information shown on this page is from the Assessor's Office. The County has made every reasonable effort to ensure the accuracy of the information and materials contained within.*



View Looking North



View Looking South

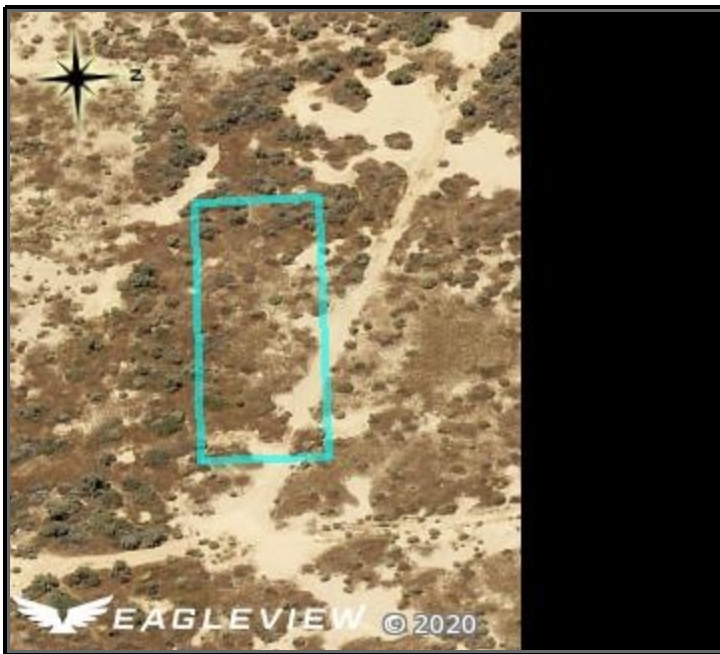

View Looking West



View Looking East

NOTE: The information and materials contained herein are provided as a public service to provide planning and zoning information for the unincorporated areas of Los Angeles County. Parcel information shown on this page is from the Assessor's Office. The County has made every reasonable effort to ensure the accuracy of the information and materials contained within.